

TOWNSHIP OF WELLINGTON NORTH
(MOUNT FOREST)
MAIN STREET (HWY. 6)
CONNECTING LINK REHABILITATION
CONTRACT No. 24250

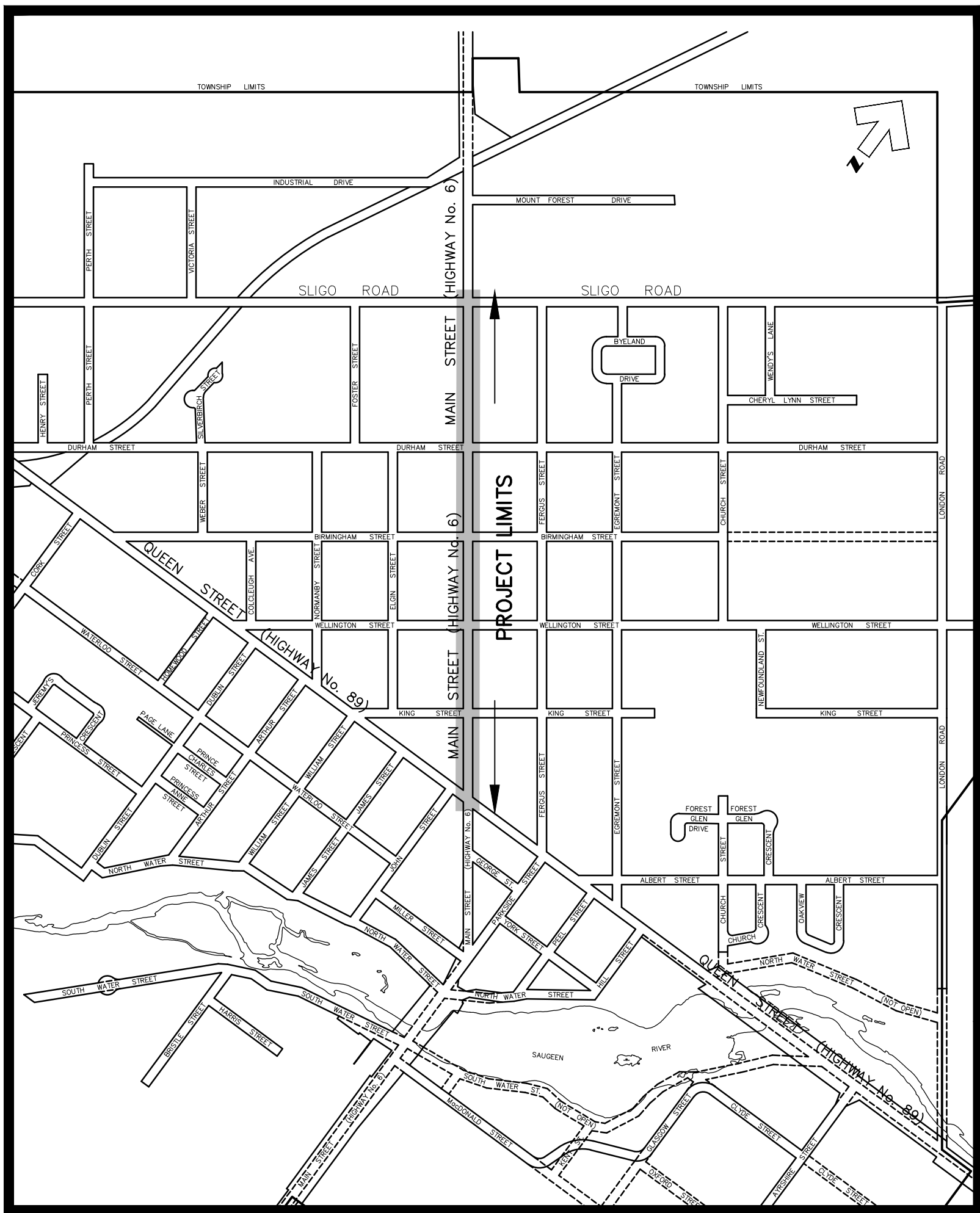

KEY PLAN

N.T.S.

DRAWING INDEX	
DRAWING No.	DESCRIPTION
1	Rehabilitation Plan from Sta. 1+000 to Sta. 1+360
2	Rehabilitation Plan from Sta. 1+360 to Sta. 1+720
3	Rehabilitation Plan from Sta. 1+720 to Sta. 2+080
4	Rehabilitation Plan from Sta. 2+080 to Sta. 2+160
5	Line Painting Plan from Sta. 1+000 to Sta. 1+360
6	Line Painting Plan from Sta. 1+360 to Sta. 1+720
7	Line Painting Plan from Sta. 1+720 to Sta. 2+080
8	Line Painting Plan from Sta. 2+080 to Sta. 2+180
01	Construction Plan Main Street & King Street

JUNE 11, 2025
RE-ISSUED FOR TENDER



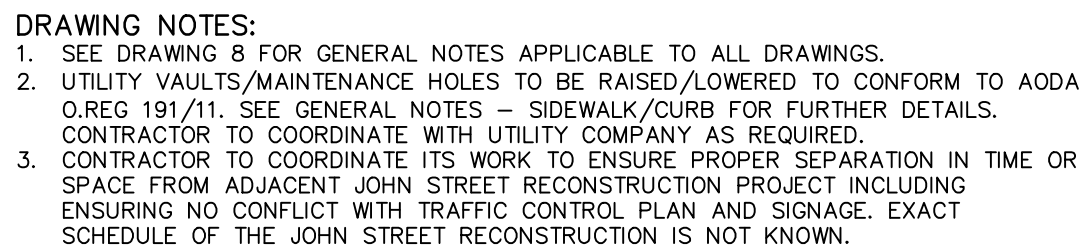

<p>Scale (24x36)</p> <p>Horizontal : 1:250</p>	<p>Drawing No.</p> <p>1 of 8</p>
--	--

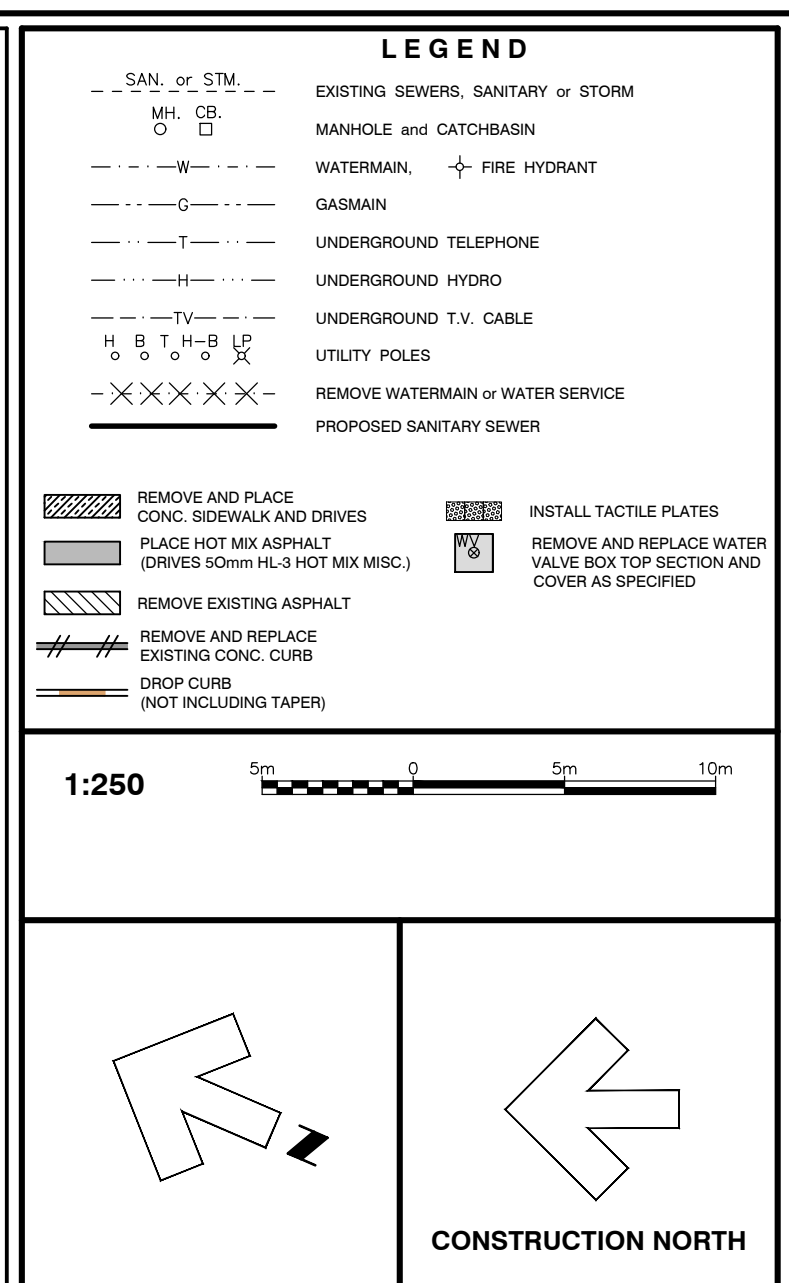

NOTE

The locations of existing underground utilities are shown in an approximate way only and have not been independently verified by the owner or its representative. The contractor shall determine the exact location of all existing utilities before commencing work and agrees to be fully responsible for any damages which might be occasioned by the contractor's failure to exactly locate and preserve any and all underground utilities.

BENCHMARK INFORMATION
B.M. Elev. 413.888
TOP OF SOUTHWEST BOLT AT BASE OF TRAFFIC
SIGNAL POLE ON NORTHEAST RADIUS OF MAIN
STREET AND WELLINGTON STREET

BENCHMARK INFORMATION
B.M. Elev. 416.631
NAIL AND FLAG IN EAST FACE OF HYDRO POLE ON
BIRMINGHAM STREET. 5m WEST OF MAIN STREET

Design By: M.R.K.	Checked By: F.C.V.
-------------------	--------------------

[illegible]

Goderich	Kincardine	Mount Forest	Sarnia
----------	------------	--------------	--------



**Township of
Wellington North
Main Street (Highway 6)
Connecting Link Rehabilitation
Plan from
Sta. 1 + 360 to Sta. 1 + 720**

Contract No. RFT 2025-020	Project No. 24250
Scale (24x36) Horizontal : 1:250	Drawing No. 2 of 8



Z:\24250-Wellington_North_St._CL_Uprgrades\Projects\CLD_Drawing\24250.dwg - 3:2025-06-11

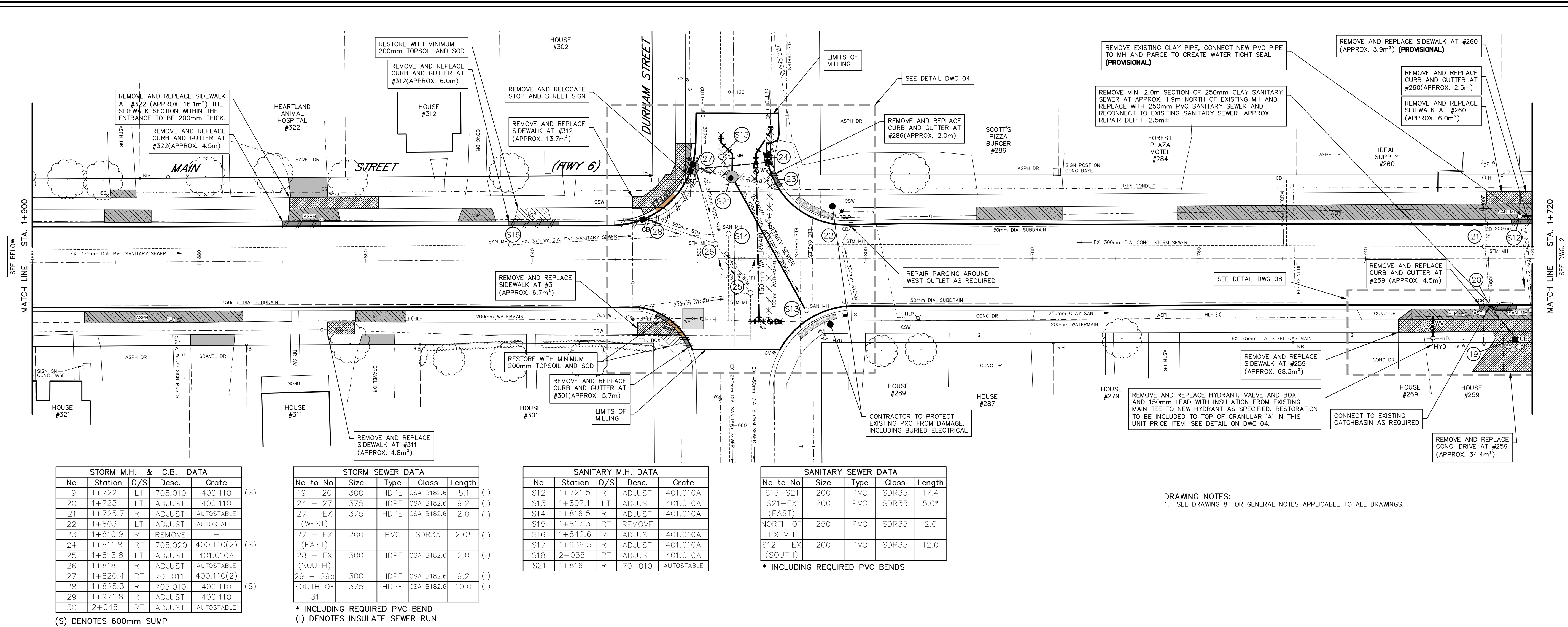

STORM M.H. & C.B. DATA				
No	Station	O/S	Desc.	Grate
19	1+722	LT	705.010	400.110 (S)
20	1+725	LT	ADJUST	400.110
21	1+725.7	RT	ADJUST	AUTOSTABLE
22	1+803	LT	ADJUST	AUTOSTABLE
23	1+810.9	RT	REMOVE	-
24	1+811.8	RT	705.020	400.110(2) (S)
25	1+813.8	LT	ADJUST	401.010A
26	1+818	RT	ADJUST	AUTOSTABLE
27	1+820.4	RT	701.011	400.110(2) (S)
28	1+825.3	RT	705.010	400.110 (S)
29	1+971.8	RT	ADJUST	400.110
30	2+045	RT	ADJUST	AUTOSTABLE

(S) DENOTES 600mm SUMP

STORM SEWER DATA				
No to No	Size	Type	Class	Length
19 - 20	300	HDPE	CSA B182.6	5.1 (I)
24 - 27	375	HDPE	CSA B182.6	9.2 (I)
27 - EX (WEST)	375	HDPE	CSA B182.6	2.0 (I)
27 - EX (EAST)	200	PVC	SDR35	2.0* (I)
28 - EX (SOUTH)	300	HDPE	CSA B182.6	2.0 (I)
29 - 29G	300	HDPE	CSA B182.6	9.2 (I)
SOUTH OF 31	375	HDPE	CSA B182.6	10.0 (I)

* INCLUDING REQUIRED PVC BEND
(I) DENOTES INSULATE SEWER RUN

SANITARY M.H. DATA				
No	Station	O/S	Desc.	Grate
S12	1+721.5	RT	ADJUST	401.010A
S13	1+807.1	LT	ADJUST	401.010A
S14	1+816.5	RT	ADJUST	401.010A
S15	1+817.3	RT	REMOVE	-
S16	1+842.6	RT	ADJUST	401.010A
S17	1+936.5	RT	ADJUST	401.010A
S18	2+035	RT	ADJUST	401.010A
S21	1+816	RT	701.010	AUTOSTABLE

SANITARY SEWER DATA				
No to No	Size	Type	Class	Length
S13-S21	200	PVC	SDR35	17.4
S21-EX (EAST)	200	PVC	SDR35	5.0*
NORTH OF EX MH	250	PVC	SDR35	2.0
S12-EX (SOUTH)	200	PVC	SDR35	12.0

* INCLUDING REQUIRED PVC BENDS

DRAWING NOTES:
1. SEE DRAWING 8 FOR GENERAL NOTES APPLICABLE TO ALL DRAWINGS.

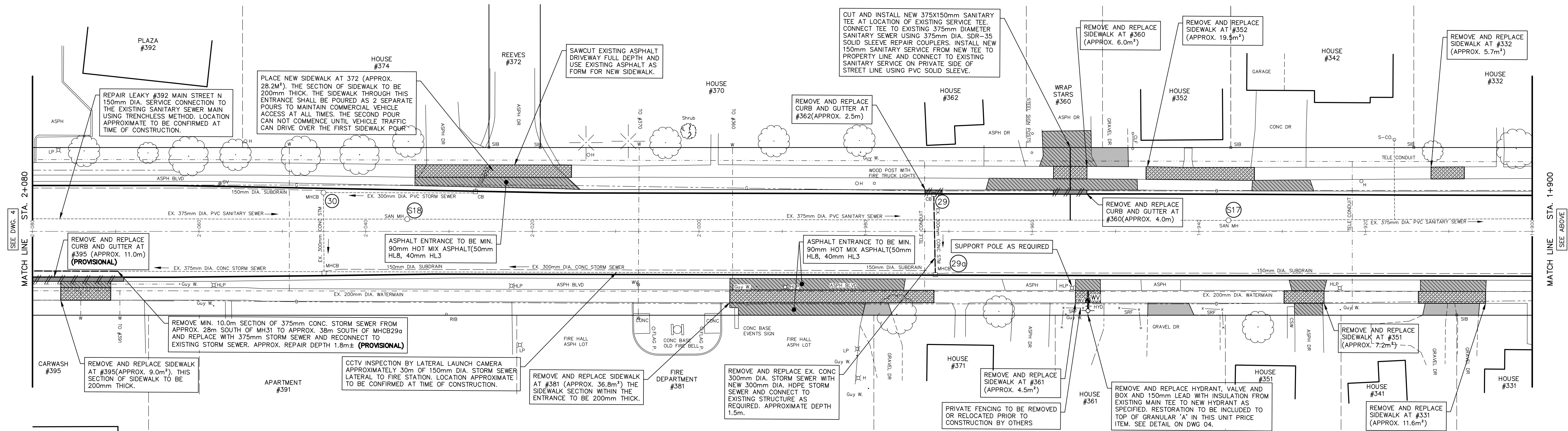

LEGEND

SAN. or STM. M.H. CB. EXISTING SEWERS, SANITARY or STORM MANHOLE and CATCHBASIN

WATERMAIN, GASMAIN, UNDERGROUND TELEPHONE, UNDERGROUND HYDRO, UTILITY POLES, REMOVE WATERMAIN or SEWERS, PROPOSED SANITARY SEWER, PROPOSED STORM SEWER, PROPOSED WATERMAIN, EXISTING TACTILE PLATES

PLACE CONC. SIDEWALK AND DRIVES, PLACE HOT MIX ASPHALT (DRIVES 50mm HL3 HOT MIX MISC.), REMOVE EXISTING CONC. SIDEWALK AND DRIVES, REMOVE EXISTING ASPHALT, REMOVE AND REPLACE EXISTING CONC. CURB, REMOVE AND REPLACE EXISTING CONC. CURB (NOT INCLUDING TAPER), REMOVE AND PLACE CONC. SIDEWALK AND DRIVES, REMOVE EXISTING CONC. SIDEWALK AND DRIVES, REMOVE EXISTING ASPHALT, INSTALL TACTILE PLATES, REMOVE AND REPLACE WATER VALVE BOX TOP SECTION AND COVER AS SPECIFIED

1:250

0 5m 10m

CONSTRUCTION NORTH

NOTE

The locations of existing underground utilities are shown in an approximate way only and have not been independently verified by the owner or its representative. The contractor shall determine the exact location of all existing utilities before commencing work and agrees to be fully responsible for any damages which might be occasioned by the contractor's failure to exactly locate and preserve any and all underground utilities.

BENCHMARK INFORMATION

B.M. Elev. 381.088
NAIL AND FLAG IN SOUTH FACE OF HYDRO POLE ON DURHAM STREET, 25m EAST OF MAIN STREET

Design By: M.R.K. Checked By: F.C.V.

F. C. VANDERLOOT
LICENSED PROFESSIONAL ENGINEER
JUNE 4/88
PROVINCE OF ONTARIO

No.	DATE	REVISION
1.	MAY 23, 2025	ISSUED FOR TENDER
2.	June 11, 2025	RE-ISSUED FOR TENDER

BMROSS
engineering better communities

Goderich Kincardine Mount Forest Sarnia

THE TOWNSHIP OF WELLINGTON NORTH

Township of Wellington North
Main Street (Highway 6)
Connecting Link Rehabilitation
Plan from
Sta. 1+720 to Sta. 2+080

Contract No. RFT 2025-020	Project No. 24250
Scale (24x36) Horizontal : 1:250	Drawing No. 3 of 8

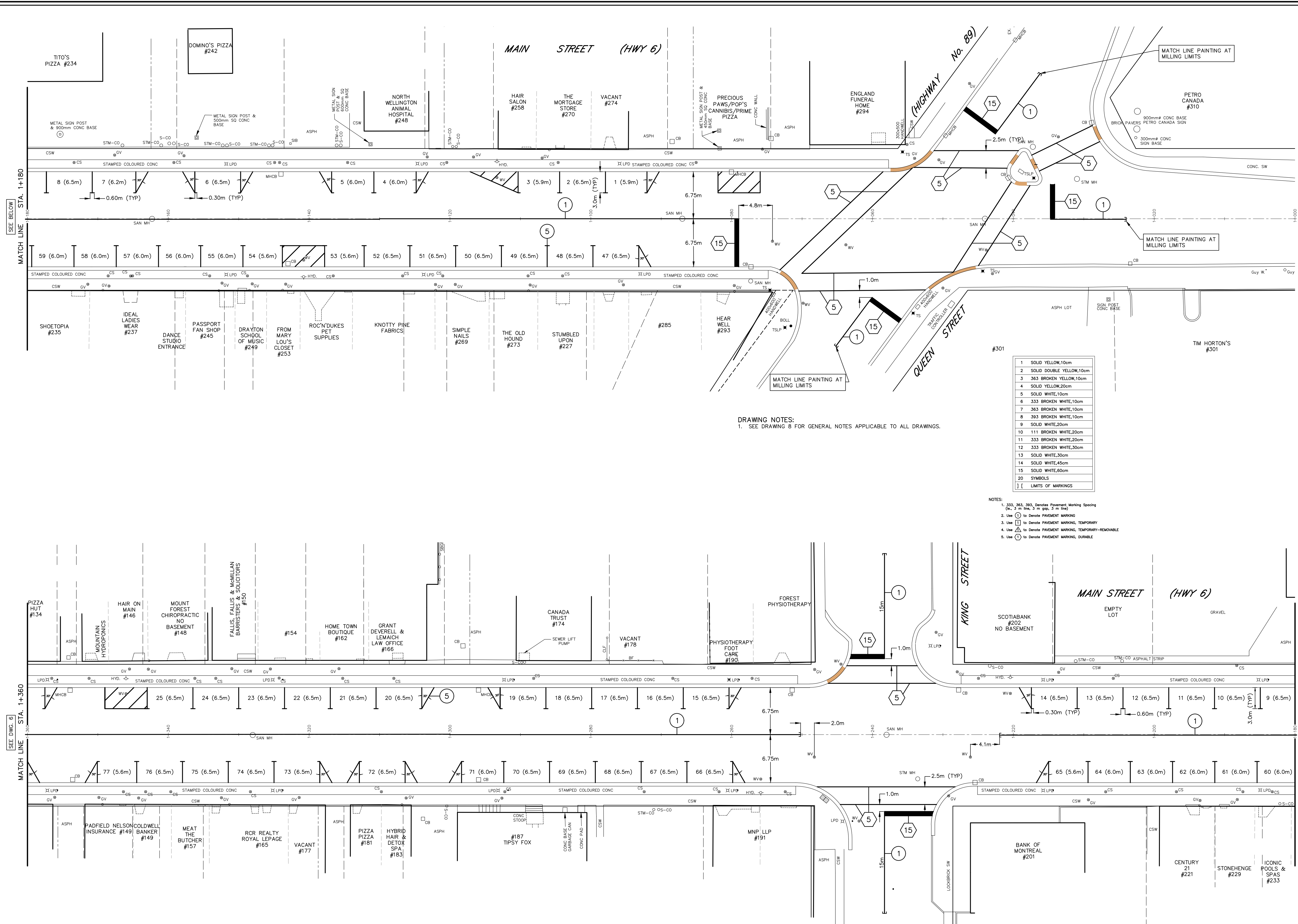

DRAWING NOTES:
1. SEE DRAWING 8 FOR GENERAL NOTES APPLICABLE TO ALL DRAWINGS.

- NOTES:
1. 333, 363, 393, Denotes Pavement Marking Spacing (W, 3 m int, 3 m gap, 3 m Sid)
 2. Use (1) to Denote PAVEMENT MARKING
 3. Use (1) to Denote PAVEMENT MARKING, TEMPORARY
 4. Use (1) to Denote PAVEMENT MARKING, TEMPORARY-REMOVABLE
 5. Use (1) to Denote PAVEMENT MARKING, DURNABLE

1	SOLID YELLOW,10cm
2	SOLID DOUBLE YELLOW,10cm
3	363 BROKEN YELLOW,10cm
4	SOLID YELLOW,20cm
5	SOLID WHITE,10cm
6	333 BROKEN WHITE,10cm
7	363 BROKEN WHITE,10cm
8	393 BROKEN WHITE,10cm
9	SOLID WHITE,20cm
10	111 BROKEN WHITE,20cm
11	333 BROKEN WHITE,20cm
12	333 BROKEN WHITE,30cm
13	SOLID WHITE,30cm
14	SOLID WHITE,45cm
15	SOLID WHITE,80cm
20	SYMBOLS
1	LIMITS OF MARKINGS

Z:\24250-W-Main_ST-CL_Upgrade\Projects\CLD_Drawing\24250.dwg - 6/2025 - 06-11

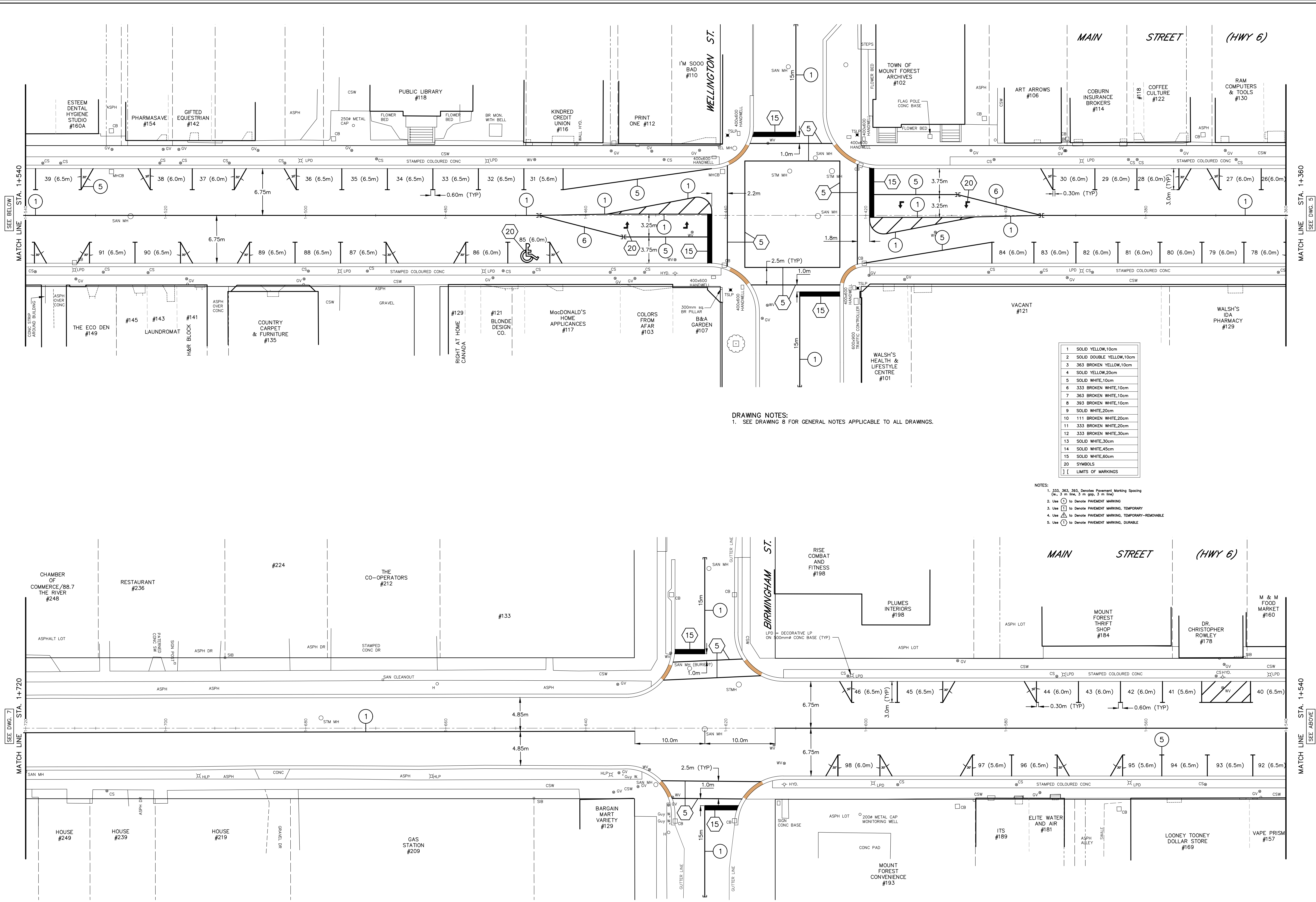

LEGEND

SAN. or STM. --- EXISTING SEWERS, SANITARY or STORM
M.H. CB --- MANHOLE and CATCHBASIN
--- WATERMAIN. --- FIRE HYDRANT
--- GASMAIN
--- UNDERGROUND TELEPHONE
--- UNDERGROUND HYDRO
--- TV--- UNDERGROUND T.V. CABLE
H.B.T.H-B.L. --- UTILITY POLES
--- DROP CURB (NOT INCLUDING TAPER)

1:250

0 5m 10m

CONSTRUCTION NORTH

NOTE

The locations of existing underground utilities are shown in an approximate way only and have not been independently verified by the owner or its representative. The contractor shall determine the exact location of all existing utilities before commencing work and agrees to be fully responsible for any damages which might be occasioned by the contractor's failure to exactly locate and preserve any and all underground utilities.

BENCHMARK INFORMATION

B.M. Elev. 413.888
TOP OF SOUTHWEST BOLT at BASE OF TRAFFIC SIGNAL POLE ON NORTHEAST RADIUS OF MAIN STREET AND WELLINGTON STREET

B.M. Elev. 416.631
NAIL AND FLAG IN EAST FACE OF HYDRO POLE ON BIRMINGHAM STREET, 5m WEST OF MAIN STREET

Design By: M.R.K. Checked By: F.C.V.

PROFESSIONAL ENGINEER
June 4/25
F. C. VANDERLOOT
PROVINCE OF ONTARIO

No.	DATE	REVISION
1.	MAY 23, 2025	ISSUED FOR TENDER
2.	June 11, 2025	RE-ISSUED FOR TENDER

BMROSS
engineering better communities

Goderich Kincardine Mount Forest Sarnia

THE TOWNSHIP OF WELLINGTON NORTH

Township of Wellington North
Main Street (Highway 6)
Connecting Link Rehabilitation
Line Painting Plan from
Sta. 1+360 to Sta. 1+720

Contract No.
RFT 2025-020

Project No.
24250

Scale (24x36)
Horizontal : 1:250

Drawing No.
6 of 8

- 1** SOLID YELLOW,10cm
2 SOLID DOUBLE YELLOW,10cm
3 363 BROKEN YELLOW,10cm
4 SOLID YELLOW,20cm
5 SOLID WHITE,10cm
6 333 BROKEN WHITE,10cm
7 363 BROKEN WHITE,10cm
8 393 BROKEN WHITE,10cm
9 SOLID WHITE,20cm
10 111 BROKEN WHITE,20cm
11 333 BROKEN WHITE,20cm
12 333 BROKEN WHITE,30cm
13 SOLID WHITE,30cm
14 SOLID WHITE,45cm
15 SOLID WHITE,60cm
20 SYMBOLS
1 LIMITS OF MARKINGS

- NOTES:**
1. 333, 363, 393, Denotes Pavement Marking Spacing (e.g., 3 m line, 3 m gap, 3 m line)
2. Use **1** to Denote PAVEMENT MARKING
3. Use **1** to Denote PAVEMENT MARKING, TEMPORARY
4. Use **1** to Denote PAVEMENT MARKING, TEMPORARY-REMOVABLE
5. Use **1** to Denote PAVEMENT MARKING, DURABLE

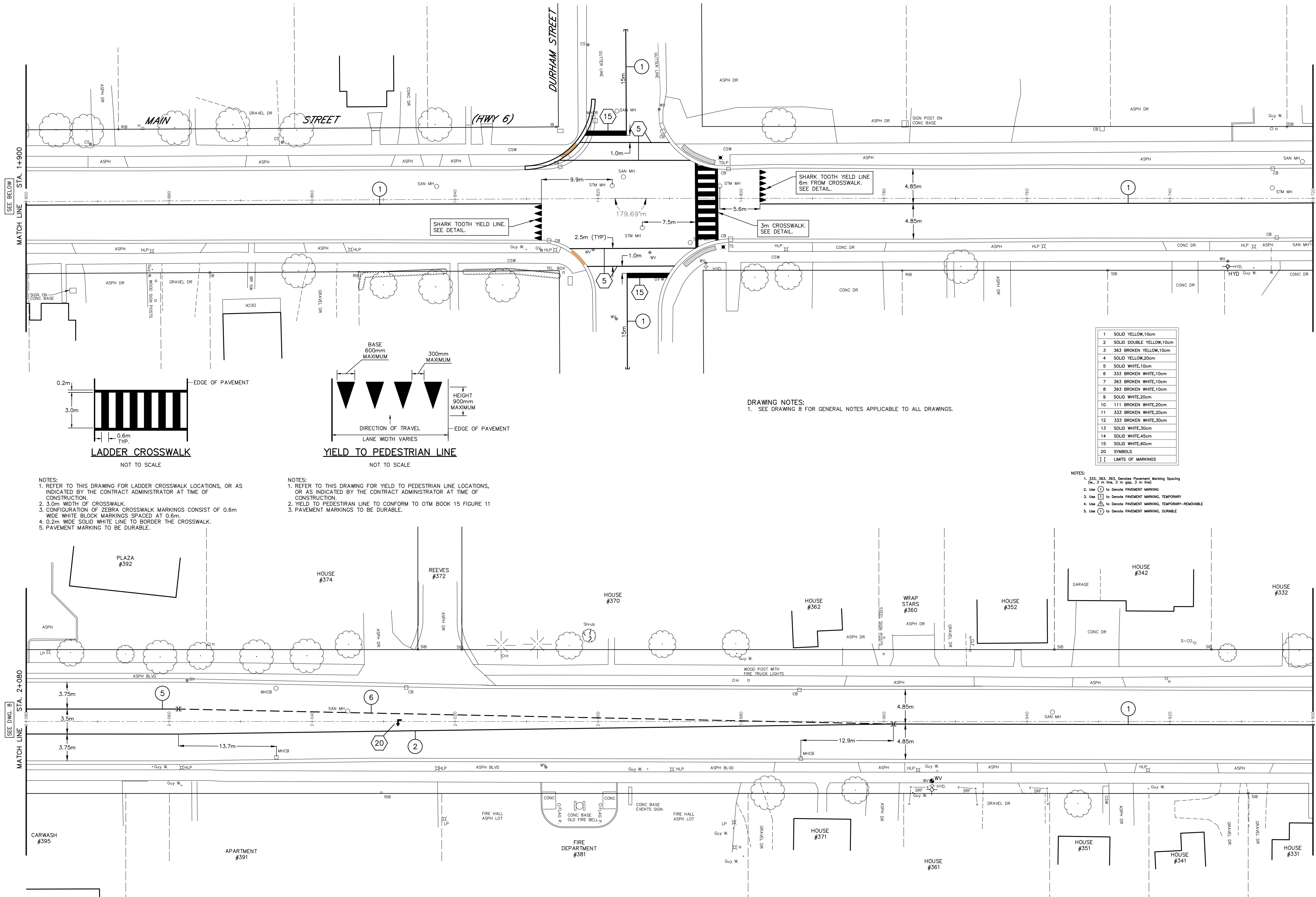

MATCH LINE STA. 1+720
SEE DWG. 6

MATCH LINE STA. 1+900
SEE ABOVE

LEGEND

SAN. or STM. --- EXISTING SEWERS, SANITARY or STORM
MH. CB. --- MANHOLE and CATCHBASIN
--- W --- WATERMAIN, --- F --- FIRE HYDRANT
--- G --- GASMAIN
--- T --- UNDERGROUND TELEPHONE
--- H --- UNDERGROUND HYDRO
--- TV --- UNDERGROUND T.V. CABLE
H B T H-B L2 --- UTILITY POLES
--- DROP CURB (NOT INCLUDING TAPER)

1:250

0 5m 10m

CONSTRUCTION NORTH

NOTE

The locations of existing underground utilities are shown in an approximate way only and have not been independently verified by the owner or its representative. The contractor shall determine the exact location of all existing utilities before commencing work and agrees to be fully responsible for any damages which might be occasioned by the contractor's failure to exactly locate and preserve any and all underground utilities.

BENCHMARK INFORMATION

B.M. Elev. 381.088
NAIL AND FLAG IN SOUTH FACE OF HYDRO POLE ON DURHAM STREET. 25m EAST OF MAIN STREET

Design By: M.R.K. Checked By: F.C.V.

LICENSED PROFESSIONAL ENGINEER
June 4/25
F. C. VANDERLOOT
PROVINCE OF ONTARIO

No.	DATE	REVISION
1.	MAY 23, 2025	ISSUED FOR TENDER
2.	June 11, 2025	RE-ISSUED FOR TENDER

BMROSS
engineering better communities

Goderich Kincardine Mount Forest Sarnia

THE TOWNSHIP OF WELLINGTON NORTH

Township of Wellington North
Main Street (Highway 6)
Connecting Link Rehabilitation
Line Painting Plan from
Sta. 1+720 to Sta. 2+080

Contract No. RFT 2025-020	Project No. 24250
Scale (24x36) Horizontal : 1:250	Drawing No. 7 of 8

- 1** SOLID YELLOW,10cm
2 SOLID DOUBLE YELLOW,10cm
3 363 BROKEN YELLOW,10cm
4 SOLID YELLOW,20cm
5 SOLID WHITE,10cm
6 333 BROKEN WHITE,10cm
7 363 BROKEN WHITE,10cm
8 383 BROKEN WHITE,10cm
9 SOLID WHITE,20cm
10 111 BROKEN WHITE,20cm
11 333 BROKEN WHITE,20cm
12 333 BROKEN WHITE,30cm
13 SOLID WHITE,30cm
14 SOLID WHITE,45cm
15 SOLID WHITE,60cm
20 SYMBOLS
] LIMITS OF MARKINGS

- NOTES:**
1. 333, 363, 383, Denotes Pavement Marking Spacing (W, 3 m line, 3 m gap, 3 m line)
2. Use **1** to Denote PAVEMENT MARKING
3. Use **2** to Denote PAVEMENT MARKING, TEMPORARY
4. Use **3** to Denote PAVEMENT MARKING, TEMPORARY-REMOVABLE
5. Use **4** to Denote PAVEMENT MARKING, DURABLE

- NOTES:**
1. REFER TO THIS DRAWING FOR LADDER CROSSWALK LOCATIONS, OR AS INDICATED BY THE CONTRACT ADMINISTRATOR AT TIME OF CONSTRUCTION.
2. 3.0m WIDTH OF CROSSWALK.
3. CONFIGURATION OF ZEBRA CROSSWALK MARKINGS CONSIST OF 0.6m WIDE WHITE BLOCK MARKINGS SPACED AT 0.6m.
4. 0.2m WIDE SOLID WHITE LINE TO BORDER THE CROSSWALK.
5. PAVEMENT MARKING TO BE DURABLE.

- NOTES:**
1. REFER TO THIS DRAWING FOR YIELD TO PEDESTRIAN LINE LOCATIONS, OR AS INDICATED BY THE CONTRACT ADMINISTRATOR AT TIME OF CONSTRUCTION.
2. YIELD TO PEDESTRIAN LINE TO CONFORM TO OTM BOOK 15 FIGURE 11
3. PAVEMENT MARKINGS TO BE DURABLE.

GENERAL NOTES (APPLICABLE TO ALL DRAWINGS):

- CONTRACTOR SHALL FULLY PROTECT UTILITIES AND POLES DURING CONSTRUCTION. WHEN NECESSARY CONTRACTOR TO RETAIN WELLINGTON NORTH POWER FOR POLE SUPPORT. CONTRACTOR TO COORDINATE ANY NECESSARY UTILITY WORK WITH THE UTILITY COMPANIES.
- IF EXCAVATED MATERIAL IS TO BE RE-USED ON SITE, IT SHALL BE KEPT WITHIN THE LIMITS OF THE MUNICIPAL PROPERTY. IF FILL IS REQUIRED ON PRIVATE PROPERTY, IT SHALL BE IMPORTED CLEAN FILL.
- MAIN LINE MATERIALS TO BE USED ARE AS FOLLOWS:
WATERMAIN - PVC pipe DR 18, Class 235 PVC
SANITARY SEWER - PVC SDR35
STORM SEWER - AS PER STORM SEWER TABLES
- SERVICE MATERIALS TO BE USED ARE AS FOLLOWS:
WATER - PE TO AWWA C904
SANITARY - PVC SDR28
STORM - PVC SDR28
- CONNECTIONS TO EXISTING MAIN LINE UTILITIES SHALL BE MADE USING THE FOLLOWING PRODUCTS:
 - WATERMAIN - HYMAX "GRIP" RESTRAINED COUPLING OR APPROVED EQUAL
 - SANITARY SEWER - PVC TO PVC - PVC SDR35 REPAIR COUPLING (GASKET X GASKET) W/O PIPE STOP
 - PVC TO AC - FERNOCO FLEXIBLE COUPLING OR APPROVED EQUAL
 - PVC TO CLAY - FERNOCO FLEXIBLE COUPLING OR APPROVED EQUAL
- STORM SEWER
CONC. TO CONC. - BELL & SPIGOT CONNECTION AT NEAREST JOINT
CONC. TO PLASTIC - MARMAC DISSIMILAR PIPE COUPLER
HDPE TO PVC - MARMAC DISSIMILAR PIPE COUPLER
PVC TO PVC - FERNOCO FLEXIBLE COUPLING OR APPROVED EQUAL
HDPE TO HDPE - MANUFACTURED HDPE REPAIR COUPLING
- CONNECTIONS TO EXISTING SERVICES SHALL BE MADE USING THE FOLLOWING PRODUCTS:
 - STORM & SANITARY - FERNOCO FLEXIBLE COUPLING OR APPROVED EQUAL
- SEPARATION DISTANCES BETWEEN SEWERS AND WATERMAINS SHALL BE AS PER WECP PROCEDURE F-6-1: IN GENERAL 2.5m HORIZONTAL SEPARATION BETWEEN PARALLEL INSTALLATIONS AND 0.5m VERTICAL SEPARATION AT CROSSINGS WHERE THE WATERMAIN CROSSES UNDER THE SEWER. EXCEPTION: SEPARATION DISTANCES MAY BE LESS THAN THOSE NOTED ABOVE AT LOCATIONS WHERE THE WATERMAIN MUST CONNECT TO EXISTING.
- WATERMAIN TO BE INSTALLED WITH MINIMUM 2.0m COVER. INSULATION TO BE PLACED OVER ANY WATERMAIN OR WATER SERVICE WHERE THE DEPTH OF COVER IS LESS THAN 2.0m (SEE INSULATION DETAIL).
- SANITARY SERVICE OBVERTS TO BE INSTALLED 2.6m(MIN) DEEP AT PROPERTY LINE (WHERE MAINLINE SEWER ELEVATION ALLOWS) UNLESS NOTED OTHERWISE. CONTRACTOR TO USE VERTICAL SWEEPS AND FITTINGS, AS REQUIRED TO CONNECT TO EXISTING SERVICES AT PROPERTY LINE. SERVICES TO BE INSTALLED AT MINIMUM 2% GRADE BUT 1% WILL BE PERMITTED WHEN THAT IS NECESSARY.
- EXISTING SANITARY SEWER AND SERVICE MATERIALS NOT ALWAYS KNOWN AND MAY BE ASBESTOS CEMENT (A.C.) PIPE. CONTRACTOR SHALL MANAGE ALL A.C. PIPE AS SPECIFIED IN THE TENDER DOCUMENT GENERAL SPECIAL PROVISION.
- INSULATION TO BE PLACED OVER ANY STORM SEWER WHERE THE DEPTH OF COVER IS LESS THAN 1.2m (SEE INSULATION DETAIL).
- MINIMUM 1% CATCHBASIN LATERAL GRADE UNLESS OTHERWISE APPROVED BY THE CONTRACT ADMINISTRATOR.
- MINIMUM CONCRETE GUTTER GRADE TO BE 0.5% AND OUTLET TO A CB/CBMH, INCLUDING ALL CURBED INTERSECTION RADI.
- WATER SERVICES, AND CURB STOPS TO BE LOCATED IN LAWN AREAS, WHERE POSSIBLE, OR ELSE CURB STOP COVERS TO BE LOCATED INSIDE 100mm DIA. PVC SLEEVES (FROST COLLAR), NO WATER SERVICE COUPLERS WILL BE ALLOWED WITHIN THE MUNICIPAL RIGHT-OF-WAY.
- EXISTING UTILITIES (WATER ONLY) THAT ARE TO BE RENDERED OBSOLETE BY THE PROJECT WORK SHALL BE REMOVED, OR GROUTED AS IDENTIFIED ON THE DRAWINGS OR AS OTHERWISE DIRECTED BY THE CONTRACT ADMINISTRATOR AT THE TIME OF CONSTRUCTION. SECTIONS OF EXISTING UTILITIES THAT MAY REQUIRE GROUTING ARE IDENTIFIED ON THE DRAWINGS.

ROAD NOTES:

- DRIVEWAY SLOPES 2% TO 6%. WHERE APPROVED BY CONTRACT ADMINISTRATOR, DRIVEWAY SLOPES UP TO 8% WILL BE PERMITTED.
- WHERE FULL ROAD EXCAVATION IS TO OCCUR, INSTALL SUBDRAIN UNDER THE CURB LINE WITHIN EXCAVATION LIMITS (INCLUDING INTERSECTION RADI) AS PER OPSD 216.021 WITH POSITIVE SLOPE TO STORM STRUCTURE OUTLET OR CONNECTION TO EXISTING SUBDRAIN AT LIMITS OF EXCAVATION WHERE APPLICABLE.

SIDEWALK/CURB NOTES:

- ALL PEDESTRIAN PATHWAYS SHALL CONFORM TO THE ACCESSIBILITY FOR ONTARIANS WITH DISABILITIES ACT (AODA), O.REG. 191/11, AND THE APPLICABLE OPSDs. SPECIFIC REQUIREMENTS INCLUDE, BUT ARE NOT LIMITED TO:
 - SIDEWALK RUNNING GRADE SHALL BE MAXIMUM 5.0% AT ALL LOCATIONS, INCLUDING WHERE THE SIDEWALK CONNECTS TO THE ROADWAY AT A CROSSWALK LOCATION. EXCEPTION: IF ADJACENT ROADWAY CENTRELINE RUNNING GRADE IS STEEPER THAN 5.0% THE SIDEWALK RUNNING GRADE MAY BE AS STEEP AS THE ADJACENT ROADWAY CENTRELINE RUNNING GRADE.
 - SIDEWALK CROSS-SLOPE SHALL BE 2-4% AT ALL LOCATIONS. A MAXIMUM OF 5% IS PERMITTED ONLY WHEN EXPRESSLY ALLOWED BY THE CONTRACT ADMINISTRATOR.
 - AT CURB DROPS AT CROSS-WALK LOCATIONS THERE CAN BE NO VERTICAL LIP PRESENT, AND THE SLOPES ACROSS THE CURB (I.E. ON EACH LEG OF THE GUTTER 'V' DO NOT EXCEED 10%).
 - AT CHANGES IN LEVEL BETWEEN 75mm AND 200mm SUCH AS WHERE SIDEWALK MUST LOCALLY TRANSITION UP/DOWN TO MEET A DRIVEWAY, OR AT A DEPRESSED CURB (CROSSWALK) LOCATION THE RUNNING SLOPE OF THE TRANSITION SHALL NOT EXCEED 10%. AT CHANGES IN LEVEL BETWEEN 13mm AND 75mm SUCH AS AT TEMPORARY ASPHALT RAMPING PROVIDED AT PEDESTRIAN CROSSINGS, THE RUNNING SLOPE OF THE TRANSITION SHALL NOT EXCEED 12.5%.
- AT DEPRESSED CURB (CROSSWALK) LOCATIONS, ALL SIDEWALK GRADES SHALL COMPLY WITH THE ABOVE-NOTED REQUIREMENTS. UNLESS THE DRAWING EXPLICITLY REQUIRES, A "CONCRETE SIDEWALK RAMP" AS PER OPSD 310.030-310.033. FOR THE PURPOSES OF INTERPRETATION, A "CONCRETE SIDEWALK RAMP" AS PER THE OPSDs MENTIONED ABOVE IS CONSIDERED THE SAME AS A "CURB RAMP" NOTED IN O.REG. 191/11.
- SIDEWALK THICKNESS AS FOLLOWS:
 - 200mm AT COMMERCIAL ENTRANCES.
 - 150mm AT LOCATIONS WHERE SIDEWALK IS DIRECTLY ADJACENT TO THE CURB, OR AT RESIDENTIAL ENTRANCES.
 - 125mm AT ALL OTHER LOCATIONS.
- TACTILE PLATES TO BE CAST-IN-PLACE.
- GRADES, ELEVATIONS, AND COMPLIANCE WITH AODA TO BE CONFIRMED IN THE FIELD AT THE TIME OF CONSTRUCTION BY THE CONTRACTOR. REMOVAL LIMITS SHOWN ARE APPROXIMATE AND SHALL BE CONFIRMED AT THE TIME OF CONSTRUCTION AND MAY BE ADJUSTED BY THE CONTRACT ADMINISTRATOR.
- DROP CURB EXTENTS AS SHOWN ON DRAWINGS DOES NOT INCLUDE TAPER.

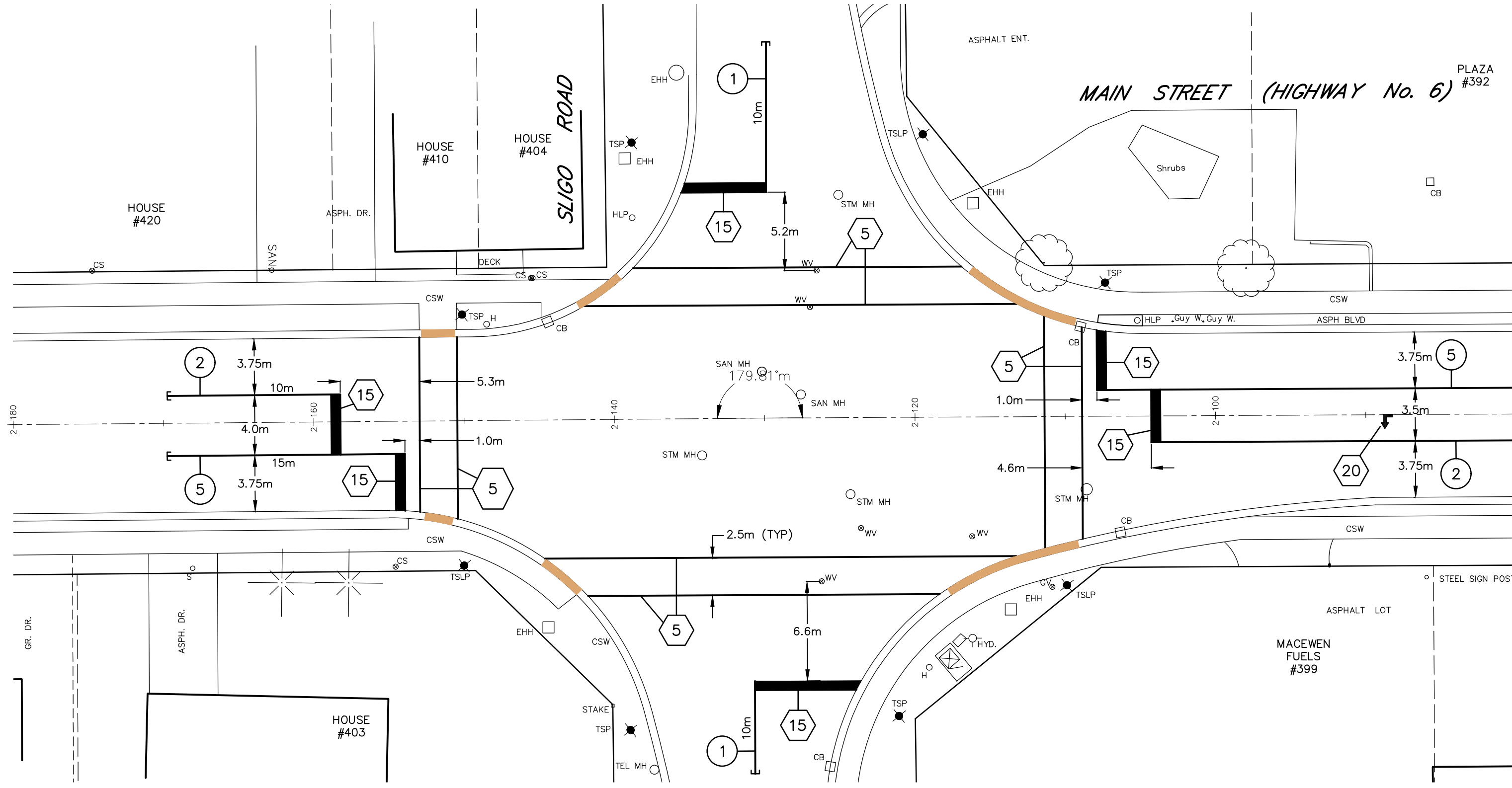

1	SOLID YELLOW,10cm
2	SOLID DOUBLE YELLOW,10cm
3	363 BROKEN YELLOW,10cm
4	SOLID YELLOW,20cm
5	SOLID WHITE,10cm
6	333 BROKEN WHITE,10cm
7	363 BROKEN WHITE,10cm
8	363 BROKEN WHITE,10cm
9	SOLID WHITE,20cm
10	111 BROKEN WHITE,20cm
11	333 BROKEN WHITE,20cm
12	333 BROKEN WHITE,30cm
13	SOLID WHITE,30cm
14	SOLID WHITE,45cm
15	SOLID WHITE,60cm
20	SYMBOLS
[] LIMITS OF MARKINGS	

- NOTES:
- 333, 363, 383, Denotes Pavement Marking Spacing (6-3 m Int, 3 m gap, 3 m Int)
 - Use (1) to Denote PAVEMENT MARKING
 - Use (1) to Denote PAVEMENT MARKING, TEMPORARY
 - Use (1) to Denote PAVEMENT MARKING, TEMPORARY-REMOVABLE
 - Use (1) to Denote PAVEMENT MARKING, DURABLE

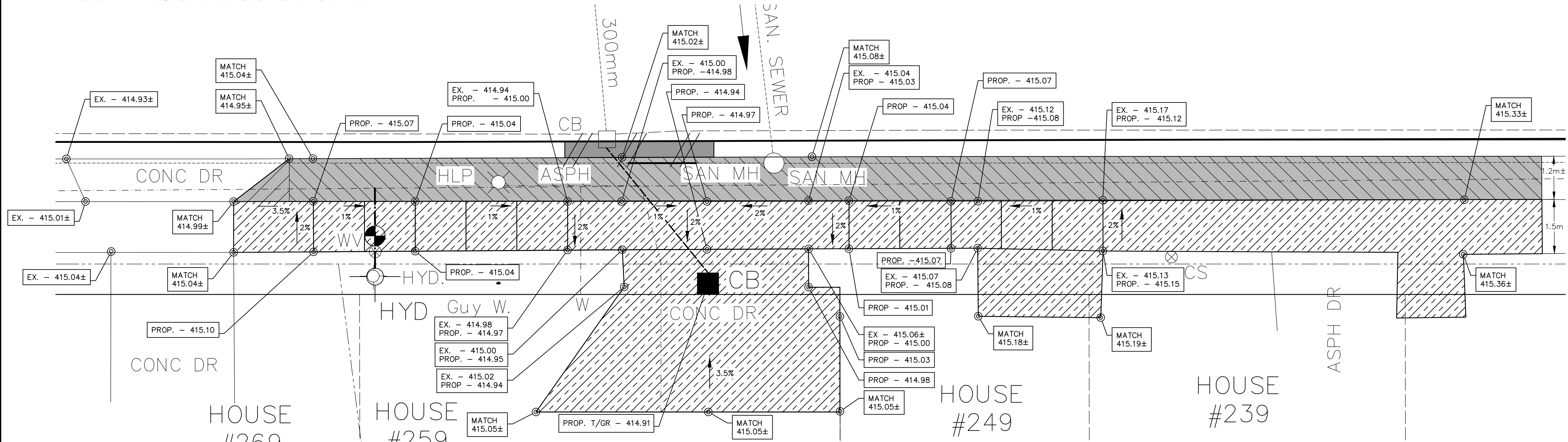

MAIN STREET NORTH FROM STA. 1+690 TO STA. 1+740
SIDEWALK GRADING DETAIL

SCALE: 1:75

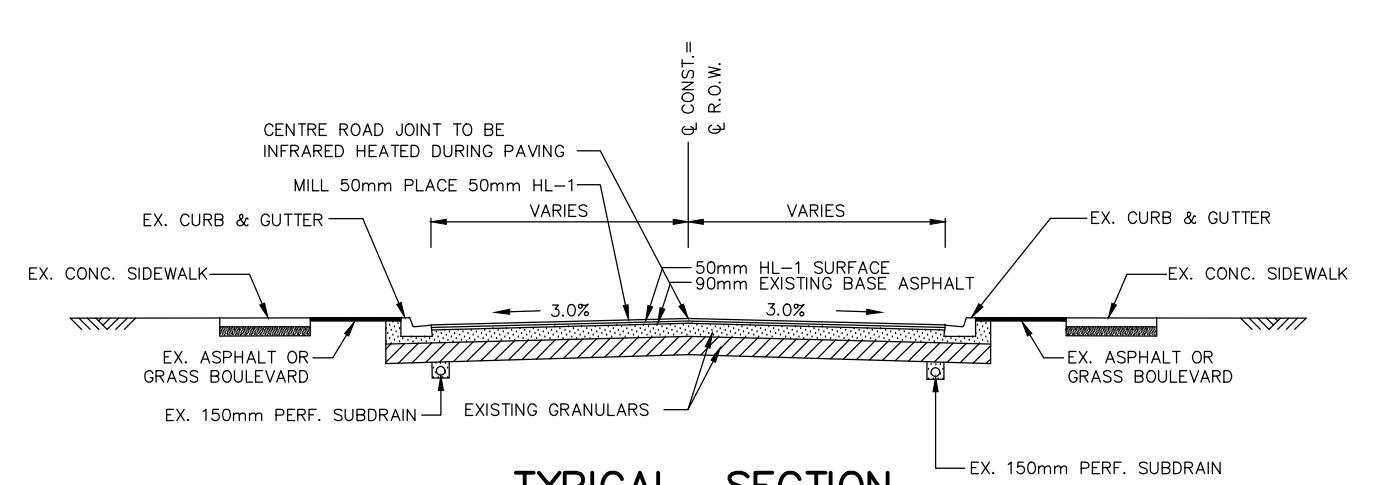

TYPICAL SECTION
BIRMINGHAM STREET TO SLIGO ROAD
N.T.S.

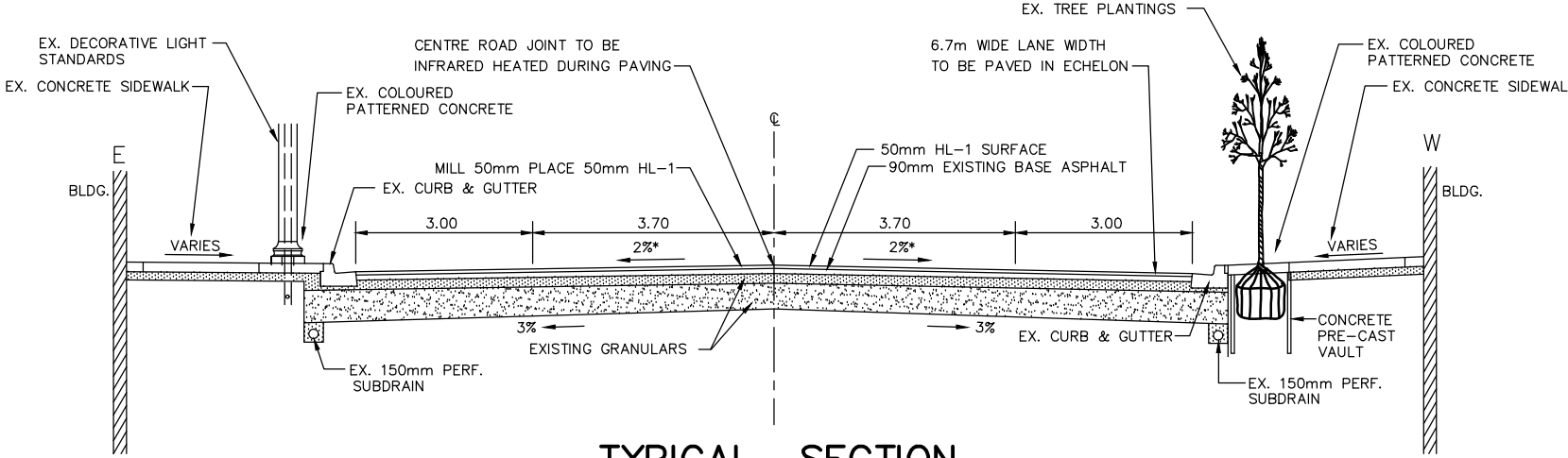

TYPICAL SECTION
QUEEN STREET TO BIRMINGHAM STREET
N.T.S.

LEGEND

SAN. or STM. MH, CB
EXISTING SEWERS, SANITARY or STORM
WATERMAIN, GASMAIN, UNDERGROUND TELEPHONE, UNDERGROUND HYDRO, UNDERGROUND T.V. CABLE, UTILITY POLES
DROP CURB (NOT INCLUDING TAPER)

1:250

CONSTRUCTION NORTH

NOTE

The locations of existing underground utilities are shown in an approximate way only and have not been independently verified by the owner or its representative. The contractor shall determine the exact location of all existing utilities before commencing work and agrees to be fully responsible for any damages which might be occasioned by the contractor's failure to exactly locate and preserve any and all underground utilities.

BENCHMARK INFORMATION

B.M. Elev. 414.042
TOP OF NORTHWEST BOLT AT BASE OF TRAFFIC SIGNAL POLE ON SOUTHEAST RADIUS OF MAIN STREET AND SLIGO ROAD

Design By: M.R.K. Checked By: F.C.V.

BMROSS
engineering better communities

THE TOWNSHIP OF WELLINGTON NORTH

Township of Wellington North
Main Street (Highway 6)
Connecting Link Rehabilitation
Line Painting Plan from Sta. 2+080 to Sta. 2+180

Contract No. RFT 2025-020 **Project No. 24250**

Scale (24x36) **Drawing No. 8 of 8**

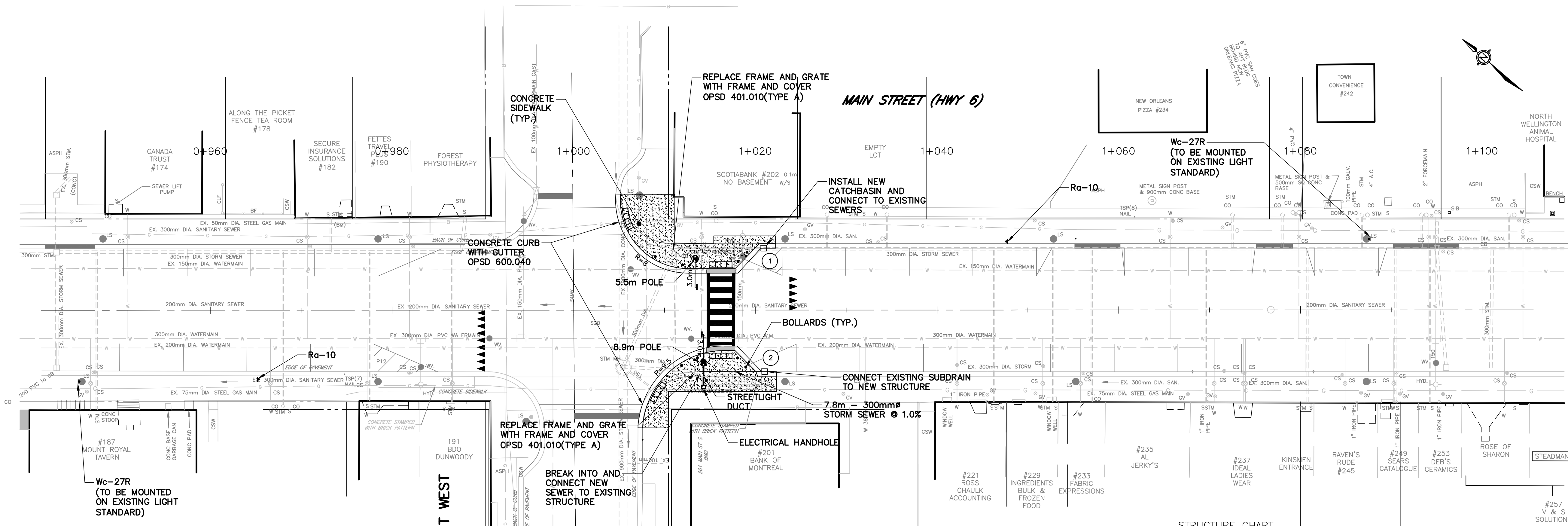

STRUCTURE No.	STATION	LOCATION	O/S	STRUCTURE TYPE (OPSD)	TYPE OF GRATING (OPSD)	TOP OF GRATE ELEVATION	INVERT ELEVATION				SUMP
							N	S	E	W	
1	1+020.9	MAIN STREET RT	6.81	600x600 (705.010)	(400.110)	418.41	415.79	415.79	N/A	N/A	600(S)
2	1+021	MAIN STREET LT	6.77	600x600 (705.010)	(400.110)	418.41	416.93	N/A	N/A	N/A	600(S)

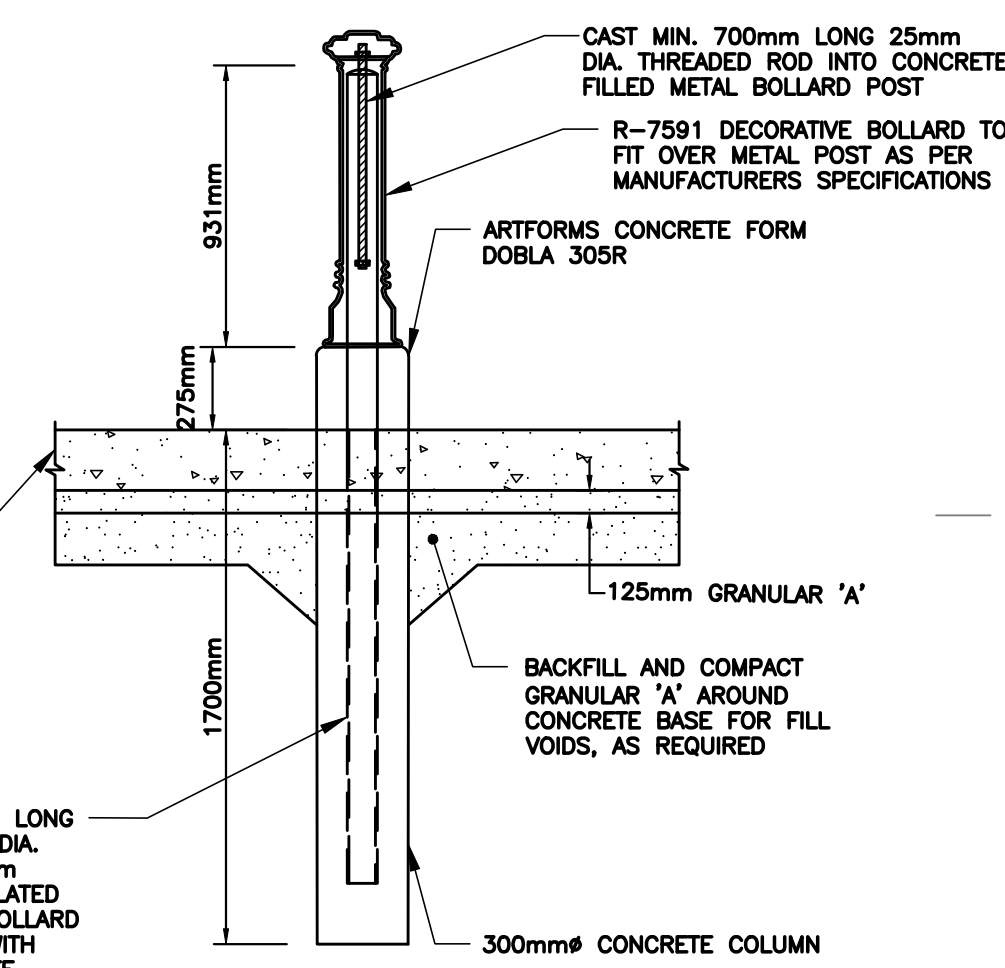

- NOTES:**
1. GLASS OF CONCRETE SHALL BE 25MPa WITH 5.5-8.5% AIR. ALL METAL POSTS TO BE CLEANED, PRIMED AND PAINTED OR HOT DIP GALVANIZED.
 2. CONTRACTOR MAY CAST 300mm DIAMETER COLUMN AGAINST NATIVE MATERIAL OR CAST CONCRETE INSIDE A SOLO-TUBE.
 3. TOP OF FOUNDATION SHALL BE TROWELLED SMOOTH & LEVEL.
 4. FORM RELEASE AGENT HAS BEEN FACTORY-APPLIED TO INSIDE SURFACE OF "ARTFORM".
 5. REFLECTIVE BANDS TO BE RED IN COLOUR.

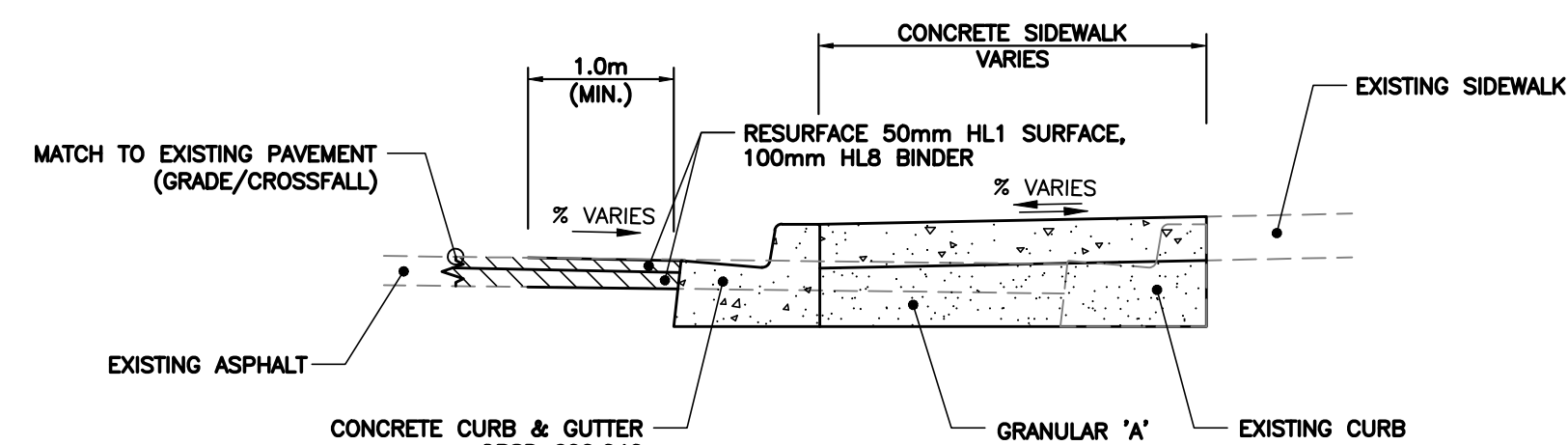
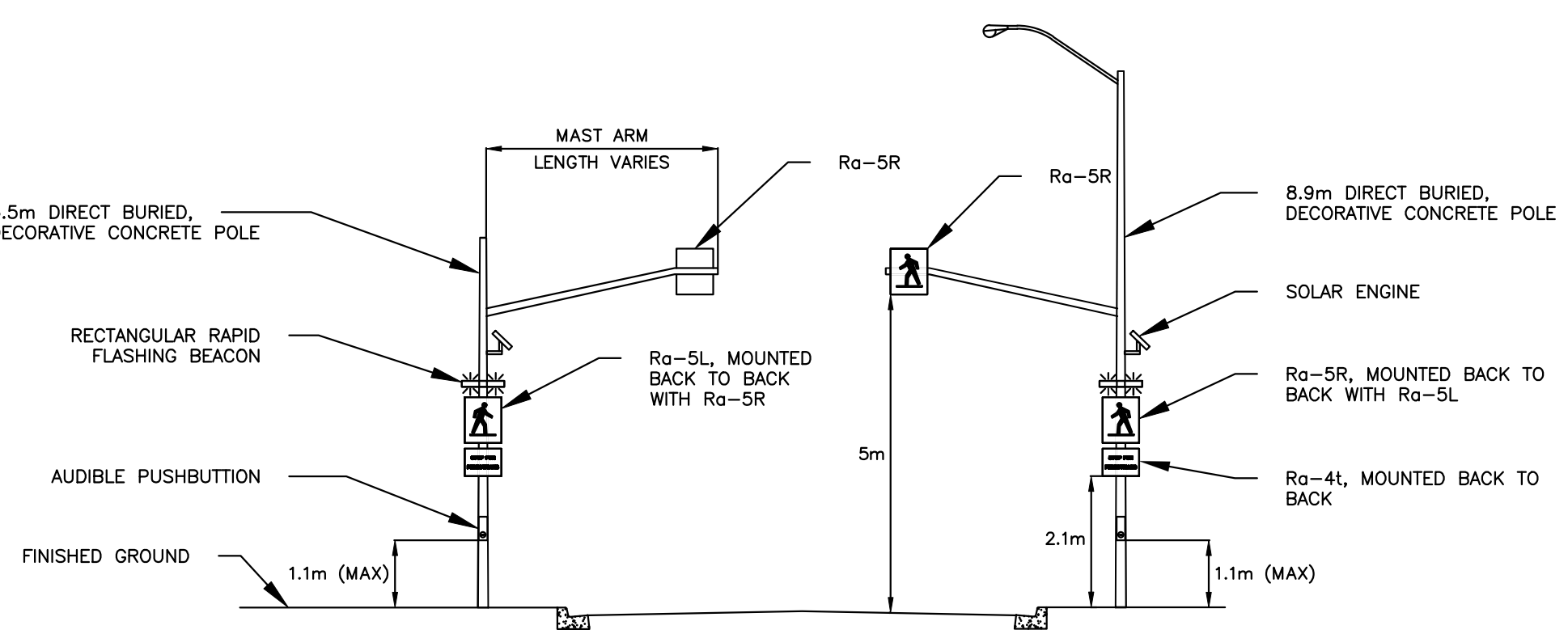
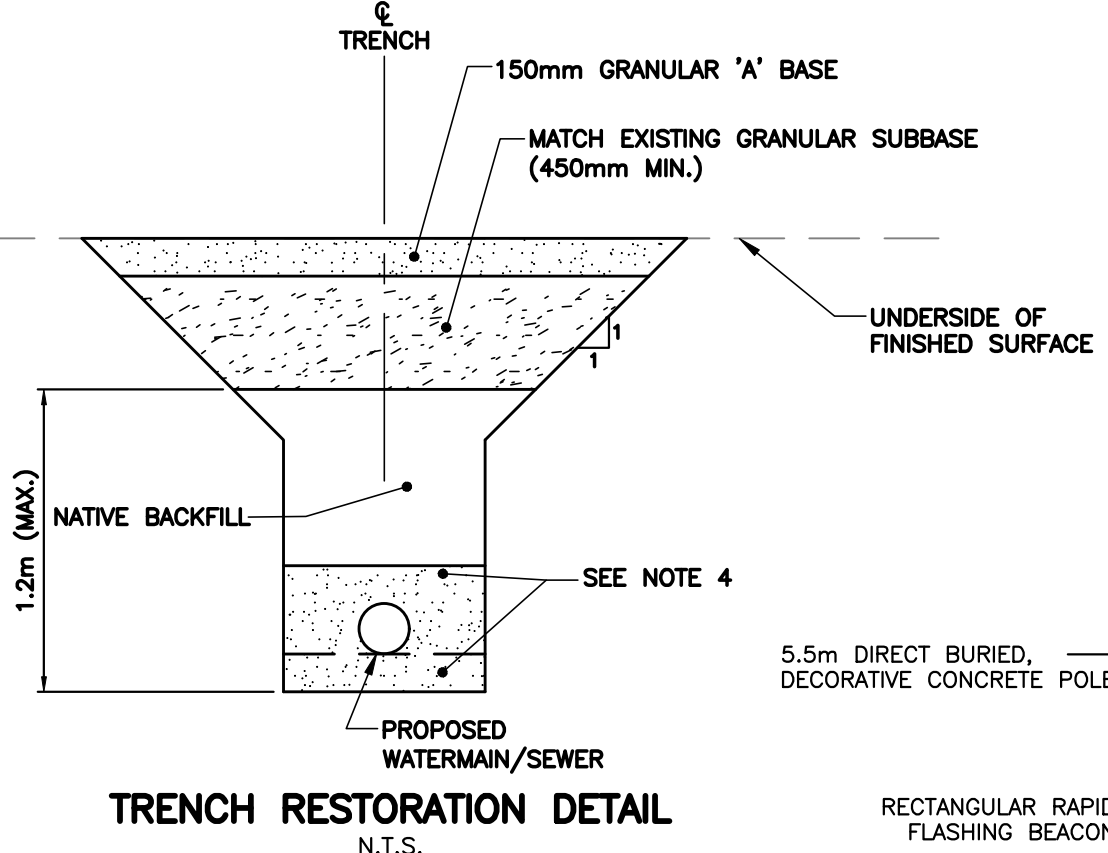

LEGEND

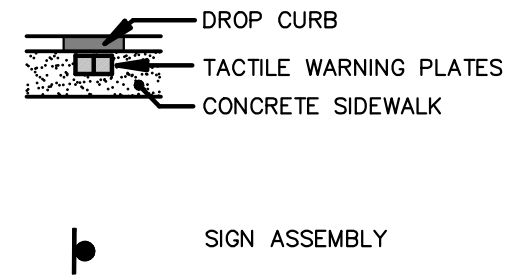

NOTES:

1. EXISTING CENTRELINE PAVEMENT MARKING SHALL BE OBLITERATED BETWEEN YIELD LINES.
2. NEW PAVEMENT MARKINGS ARE TO BE DURABLE.
3. LUMINAIRES TO BE 7.0m ABOVE GROUND SURFACE.
4. STORM SEWER TO BE PVC (CSA - B182.4 - CLASS 320) OR PE (CSA - B182.8 - 320KPa) WITH GRANULAR 'A' BEDDING AND COVER IN ACCORDANCE WITH OPSD 802.010.

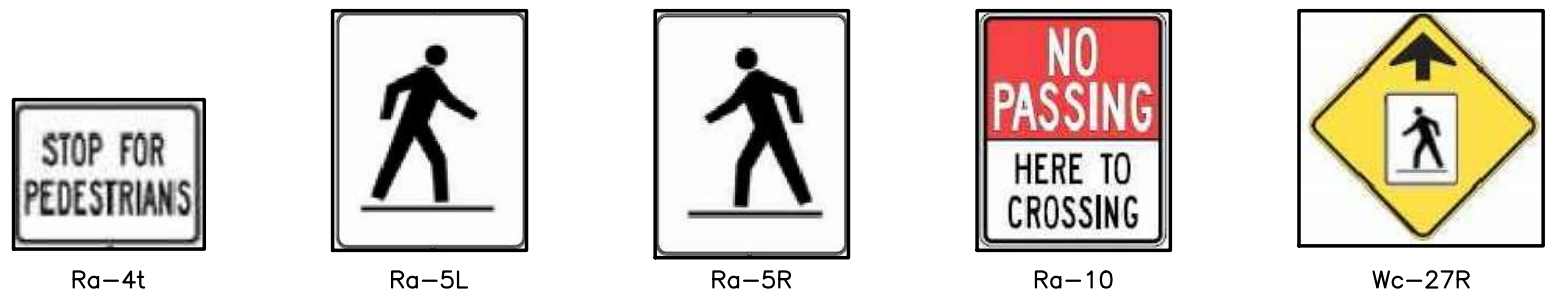

SIGNS

N.T.S.

NOTES				PXO CONSTRUCTION MAIN STREET SOUTH INTERSECTION WITH KING STREET SOUTH MOUNT FOREST, ON		TOWNSHIP OF WELLINGTON NORTH 7490 SIDEROAD 7 WEST P.O. BOX 125 KENILWORTH ONTARIO		PROJECT No A5528 R03		TRITON ENGINEERING SERVICES LIMITED Consulting Engineers		SCALES 1:250 HORIZONTAL N/A VERTICAL	
						CONSTRUCTION PLAN MAIN STREET & KING STREET		DRAWN BY: M.J.H.					
								CHECKED BY: T.J.K.					
								APPROVED BY: T.J.K.					
								DATE: JUNE 2023					