

Lorraine Heinbuch  
Clerk / CAO  
Township of Wellington North

August 9, 2010

Dear Ms. Heinbuch,

On behalf of the Mount Forest Kin Club I am writing to you regarding our application to hold our annual Fall Road Toll.

As you may recall, this event is held on the Thanksgiving long weekend. This year we are proposing to run the event on the following days and times:

Friday Oct. 8 (4 to 8 pm)

Saturday Oct. 9 (8am to 1 pm)

We are proposing to use the same routes and traffic control procedures that we have used successfully in previous road tolls.

I have arranged for our insurance company to fax you a copy of our insurance policy and to include the Township of Wellington North as “additional insured.”

If you have any questions please contact me at 519-884-0710 x3131 or email me ([pbarnard@wlu.ca](mailto:pbarnard@wlu.ca)).

Thank-you

Paul Barnard  
Risk Manager  
Mount Forest Kin Club

**THE CORPORATION OF THE  
TOWNSHIP OF WELLINGTON NORTH**

**BY-LAW NUMBER 67-10**

**BEING A BY-LAW TO PERMIT FUNDRAISING ACTIVITIES BY A CHARITABLE ORGANIZATION ON A ROADWAY UNDER THE SAFE STREETS ACT, S.O. 1999 IN THE TOWNSHIP OF WELLINGTON NORTH. (Mount Forest Kin Club Fall Road Toll – Main Street, Mount Forest)**

**AUTHORITY:** Safe Streets Act, 1999, S.O. 1999, Chapter 8, as amended, Section 3(3).  
Municipal Act, 2001, S.O. 2001, Chapter 25, as amended, Section 11(3)

**WHEREAS** Section 3(3) of the Safe Streets Act, 1999, S.O. 1999, Chapter 8, as amended, permits charitable organizations to conduct fund-raising activities on roadways where the maximum speed limit is 50 kilometres per hour, provided the activities are permitted by a by-law of the municipality in which the activities are conducted;

**WHEREAS** Section 11(3) of the Municipal Act, 2001, S.O. 2001, Chapter 25, as amended, provides for passing of a by-law with respect to highways, including parking and traffic thereon for such period as shall be specified in the by-law;

**AND WHEREAS** the Mount Forest Kin Club is planning to hold their annual Fall Road Toll event on October 8, 2010 between the hours of 4:00 p.m. and 8:00 p.m. and on October 9, 2010 between the hours of 8:00 a.m. and 1:00 p.m.;

**NOW THEREFORE** the Council of The Corporation of the Township of Wellington North enacts as follows:

1. That the Mount Forest Kin Club is hereby permitted to hold their annual Fall Road Toll event on October 8, 2010 between the hours of 4:00 p.m. and 8:00 p.m. and on October 9, 2010 between the hours of 8:00 a.m. and 1:00 p.m. on Main Street South, Mount Forest between Queen Street and Parkside Drive.
2. That the Mount Forest Kin Club is hereby permitted to hold their annual Fall Road Toll event on October 8, 2010 between the hours of 4:00 p.m. and 8:00 p.m. on Queen Street East, Mount Forest between Main Street and Fergus Street.
3. The effective date of this by-law shall be the date of final passing thereof.

**READ A FIRST, SECOND AND THIRD TIME AND FINALLY PASSED  
THIS 13TH DAY OF SEPTEMBER, 2010.**

---

**MICHAEL BROOMHEAD,  
MAYOR**

---

**LORRAINE HEINBUCH  
CHIEF ADMINISTRATIVE OFFICER/CLERK**

**THE CORPORATION OF THE  
TOWNSHIP OF WELLINGTON NORTH**

**BY-LAW NUMBER 68-10**

**BEING A BY-LAW TO PROVIDE FOR REDUCED HOURS OF  
VOTING IN INSTITUTIONS AND RETIREMENT HOMES.**

**AUTHORITY: Municipal Elections Act, 1996, as amended, Section 45 and 46**

**WHEREAS** Section 46(3) of the Municipal Elections Act, 1996 provides that a municipal council may pass a by-law with respect to reduced voting hours in voting places in retirement homes or those institutions as defined in Section 45(7) of the said Act, where the voting place is only for the use of the residents;

**NOW THEREFORE THE COUNCIL OF THE CORPORATION OF THE  
TOWNSHIP OF WELLINGTON NORTH ENACTS AS FOLLOWS:**

1. Those voting places as shown in Schedule "A" attached hereto shall be open for those hours as also detailed in Schedule "A".

**READ A FIRST, SECOND AND THIRD TIME AND FINALLY PASSED  
THIS 13TH DAY OF SEPTEMBER, 2010.**

---

**MICHAEL BROOMHEAD,  
MAYOR**

---

**LORRAINE HEINBUCH  
CHIEF ADMINISTRATIVE OFFICER/CLERK**

**THE CORPORATION OF THE  
TOWNSHIP OF WELLINGTON NORTH**

**SCHEDULE "A"  
TO BY-LAW NUMBER 68-10**

**ELECTION DAY – OCTOBER 25<sup>TH</sup>, 2010  
VOTING PLACES (INSTITUTIONS AND RETIREMENT HOMES)  
TO BE OPEN BETWEEN THE HOURS OF**

Ward 2                      Poll 4  
Birmingham Retirement Community Inc.                      10:00 a.m. to 2:00 p.m.  
356-A Birmingham Street, East  
MOUNT FOREST, Ontario

Ward 1                      Poll 3  
Saugeen Valley Nursing Centre Ltd.                      10:00 a.m. to 2:00 p.m.  
465 Dublin Street  
MOUNT FOREST, Ontario

Ward 4                      Poll 4  
Caressant-Care Nursing Home  
of Canada Limited                      10:00 a.m. to 2:00 p.m.  
215 Eliza Street  
ARTHUR, Ontario

**THE CORPORATION OF THE  
TOWNSHIP OF WELLINGTON NORTH**

**BY-LAW NUMBER 69-10**

**BEING A BY-LAW TO AMEND BY-LAW NO. 55-09.**

**WHEREAS** By-law No. 55-09 passed on the 14<sup>th</sup> day of September, 2009 provides, among other things, rules and regulations with respect to the use of the water and sanitary sewage systems in the Township of Wellington North.

**AND WHEREAS** By-Law No. 55-09 was amended by By-Law No. 18-10 and it is deemed expedient to further amend the said By-law by additions to the Schedule 2 SPECIAL PROVISIONS RE USE OF SERVICES, CHARGES OR COSTS, NEW SERVICES AND POLICIES.

**NOW THEREFORE the Council of The Corporation of the Township of Wellington North enacts as follows:**

1. Paragraph (1) of Article 15.3 of the said Schedule 2 is amended by the addition of the following sentence – “The one (1) servicing project referred to herein (scheduled to be completed in the year 2010) is comprised of the two (2) residential properties located at 777 Waterloo Street and 781 Waterloo Street in the former Town of Mount Forest which properties currently have Property Identifier Numbers 71056-0024 (Lot 4 and part of Lot 3 Ellis Survey) and 71056-0023 (Part of Lot 2 and Part of Lot 3 Ellis Survey) respectively in the Land Registry System.”.
2. Paragraphs 2, 3, 4 and 5 of Article 15.3 are amended by the addition of the words “and the one (1) servicing project” immediately after the words “the three (3) servicing projects” in the first line thereof.
3. The amended Schedule 2 to By-Law No. 55-09, which is hereby incorporated as part of the said by-law as amended, is attached hereto.

**READ A FIRST, SECOND AND THIRD TIME AND FINALLY PASSED  
THIS 13TH DAY OF SEPTEMBER, 2010.**

---

**MICHAEL BROOMHEAD,  
MAYOR**

---

**LORRAINE HEINBUCH  
CHIEF ADMINISTRATIVE OFFICER/CLERK**

**THE CORPORATION OF THE  
TOWNSHIP OF WELLINGTON NORTH  
BY-LAW NUMBER 69-10**

**SCHEDULE 2**

**THIS IS SCHEDULE 2 (AMENDED) TO BY-LAW NUMBER 55 – 09 OF THE  
CORPORATION OF THE TOWNSHIP OF WELLINGTON NORTH**

**SPECIAL PROVISIONS RE USE OF SERVICES, CHARGES OR COSTS,  
NEW SERVICES AND POLICIES.**

**Article 15.1 – Recitals.**

- (1) Wellington North has had policies in place with respect to the requirement to use available services and the extension of services, including a policy adopted by resolution of Council on September 11, 2006 and a storm sewer use requirement described in resolution of Council made on the 25<sup>th</sup> day of May, 2009.
- (2) Wellington North now incorporates and consolidates special provisions with respect to the use of specified services and charges or costs in this Schedule 2.

**Article 15.2 – Storm Water, Drainage and Sump Pumps.**

- (1) No person shall cause or allow by any means storm water or other drainage from land (including buildings) owned or controlled by that person to be directed to or flow into the Township's sanitary sewage systems.
- (2) No person shall connect or continue to allow the connection of any apparatus or device to the Township's sanitary sewage systems that directs or allows storm water or other drainage from land (including buildings) to flow into them.
- (3) Where a storm sewer and a storm sewer connection is available to a property in the Township, any sump pump system serving a building on that property shall be connected to the Township's storm sewer at the property line. The connection shall be made in compliance with the Township's municipal servicing standards and at the expense of the property owner subject to any assistance the Township may determine to provide from time to time with respect to buildings existing prior to the availability of the Township's storm sewer connection at the property line. Further, the connection of such existing buildings to the storm sewer shall be completed within six (6) months of the availability of the Township's storm sewer connection at the property line.

**Article 15.3 – Existing Water and Sanitary Sewer Services.**

- (1) The three (3) servicing projects (completed approximately within the last 5 years) referred to herein are: the servicing extension completed at Highway 6 and Wellington County Road 109 running southerly on highway 6 and the Jones Base Line (former Arthur Village); the servicing extension completed at Highway 6 and Wellington County Road 109 running westerly on Wellington County Road 109 to Charles Street (former Arthur Village); and the servicing extension completed on Martin Street from Cork Street to Dublin Street (former Town of Mount Forest).



**THE CORPORATION OF THE  
TOWNSHIP OF WELLINGTON NORTH  
BY-LAW NUMBER 69-10**

**SCHEDULE 2**

- The one (1) servicing project referred to herein (scheduled to be completed in the year 2010) is comprised of the two (2) residential properties located at 777 Waterloo Street and 781 Waterloo Street in the former Town of Mount Forest which properties currently have Property Identifier Numbers 71056-0024 (Lot 4 and part of Lot 3 Ellis Survey) and 71056-0023 (Part of Lot 2 and Part of Lot 3 Ellis Survey) respectively in the Land Registry System.
- (2) With the exception of the three (3) servicing projects and the one (1) servicing project described in paragraph (1), the owners or occupiers of all properties with water and sanitary sewer services available to the property line upon the passing of this by-law shall pay the applicable ongoing user fees whether they are connected to the services or either of them or not.
  - (3) With the exception of the three (3) servicing projects and the one (1) servicing project provided for in paragraph (5) and with the exception of any properties serviced through a by-law passed prior to the within by-law under the *Municipal Act, 2001* and allocating all servicing costs including connection fees to the properties serviced, all properties with water and sanitary sewer services available to the property line upon the passing of this by-law that are not connected to the services or either of them may be connected to the services or either of them at the request of the owner upon payment of the applicable connection fee or fees (also known as the servicing charge or charges) at the time of the connection. By way of clarification the current servicing charges are \$2,100.00 for connection to the water service and \$2,600.00 for connection to the sanitary sewer service.
  - (4) With respect to the three (3) servicing projects and the one (1) servicing project described in paragraph (1), no user fees shall be payable by the owner or occupier of any property with water and sanitary sewer services available to the property line unless and until the owner has requested and received a connection or connections whereupon the owner or occupier shall pay the applicable ongoing user fees for the service or services.
  - (5) With respect to the three (3) servicing projects and the one (1) servicing project described in paragraph (1), all properties with water and sewer services available to the property line but not connected to the services upon the passing of this by-law, may be connected to the services or either of them at the request of the owner upon payment of the applicable connection fee or fees at the time of the connection plus payment of an amount equal to the current development charges at the time of the connection. By way of clarification the current connection fees (also known as servicing charges) are \$2,100.00 for connection to the water service and \$2,600.00 for connection to the sanitary sewer service, and the current additional required payment for connections are \$2,567.00 for connection to the water service and \$6,795.00 for connection to the sanitary sewer service.
  - (6) In all cases, upon connection to the Township's water service or sanitary sewer service the property owner shall at the property owner's expense abandon and

**THE CORPORATION OF THE  
TOWNSHIP OF WELLINGTON NORTH  
BY-LAW NUMBER 69-10**

**SCHEDULE 2**

decommission any private well or sewage system on the property in accordance with the current provincial or other laws applicable thereto.

**Article 15.4 – New Water and Sanitary Sewer Services.**

- (1) Upon the passing of this by-law this Article 15.4 shall apply to all future water and sanitary services installed or extended by the Township.
- (2) When water or sanitary sewer services are installed or extended by the Township as a result of a Provincial Officer's Order by the Ministry of the Environment or an Order by the applicable Health Unit arising from concerns over private water or sewage systems, or as a result of a sufficient Petition to the Township by property owners to extend one or both services to an area as a local improvement, the Township will install both services at the same time regardless of the requirements under the Order or Orders or Petition and:
  - (i) all properties with resulting water and sanitary sewer services **shall** be connected by the owners to those services within six (6) months after they are available at the property line;
  - (ii) the owner of each such property shall pay the share of the costs for the services allocated to the property and provided for in a by-law passed under the *Municipal Act, 2001* as amended, without any further connection fees or charges.
  - (iii) when water or sanitary sewer services are installed or extended by the Township to accommodate the development of lands for residential, commercial, industrial or institutional purposes, or as a result of an infrastructure renewal program of the Township, the Township will install both services at the same time and:
    - (a) all properties with resulting water and sanitary sewer services **may**, but will not be obliged to, connect to those services after they are available at the property line at the request of the owner upon payment of the applicable connection fee or fees at the time of the connection plus payment of an amount equal to the then current development charge. By way of clarification the current connection fees (also known as servicing charges) are \$2,100.00 for connection to the water service and \$2,600.00 for connection to the sanitary sewer service, and the current additional required payment for connections are \$2,567.00 for connection to the water service and \$6,795.00 for connection to the sanitary sewer service.
    - (b) no user fees shall be payable by the owner or occupier of any of such properties with water and sanitary sewer services available to the property line unless and until the owner has requested and

**THE CORPORATION OF THE  
TOWNSHIP OF WELLINGTON NORTH  
BY-LAW NUMBER 69-10**

**SCHEDULE 2**

received a connection or connections whereupon the owner or occupier shall pay the applicable ongoing user fees for the service or services.

**Article 15.4.1 – Connections to Existing and New Sanitary Sewers**

- (1) No connection to any Township sanitary sewer system may be made without the permission of the Public Works Department or the Building Department of the Township.
- (2) Upon completion of a connection to any Township sanitary sewer system, no sewage or liquid may be discharged into the system from the building serviced by the connection until a closed circuit television (CCTV) inspection of the pipe from the building to the Township's sewer main has been completed, in form and content and with functionality results satisfactory to and approved by the Township's Public Works Department or the Township's Building Department.

**Article 15.5 – Confirmation of Policies.**

- (1) The following policies of the Township of Wellington North with respect to municipal services are confirmed:
  - (i) It is the Township's policy that the extension of municipal services for new development or existing unserved development will only be undertaken if both the sanitary sewer main and watermain are extended together. The Township will not consider the extension of sanitary sewers or watermain individually.
  - (ii) Council will, by resolution, set aside uncommitted reserve capacity for sewage treatment and water supply to accommodate existing homes and businesses serviced by the extension of municipal services to new development or existing unserved development.
  - (iii) Municipal services will be prioritized and extended to existing unserved development based on available funds, health risks, environmental impacts and proposed developments.
  - (iv) All payments required by the Township for connections to services shall be paid for or provided for in a manner satisfactory to the Township prior to the time when the connection or connections are made.

**THE CORPORATION OF THE  
TOWNSHIP OF WELLINGTON NORTH**

**BY-LAW NUMBER 70-10**

**A BY-LAW TO AMEND ZONING BY-LAW NUMBER 66-01 BEING THE ZONING BY-LAW FOR THE TOWNSHIP OF WELLINGTON NORTH (Lardeb Farms Limited/Markham Waterloo Mennonite Conference)**

**WHEREAS**, the Council of the Corporation of the Township of Wellington North deems it necessary to amend By-law Number 66-01;

**NOW THEREFORE** the Council of the Corporation of the Township of Wellington North enacts as follows:

1. THAT Schedule "A" Map 1 and Map 6 (Conn) to By-law 66-01 are amended by changing the zoning on a portion of the land described as Part of Lot 1, Concession 14, former Township of West Luther, as shown on Schedule "A" attached to and forming part of this By-law, from Agricultural Exception (A-1) and Residential (R1A) to Institutional (IN).
2. THAT except as amended by this By-law, the land as shown on the attached Schedule "A" shall be subject to all applicable regulations of Zoning By-law 66-01, as amended.
3. THAT this By-law shall come into effect upon the final passing thereof pursuant to Section 34(21) and Section 34(22) of The Planning Act, R.S.O., 1990, as amended, or where applicable, pursuant to Sections 34 (30) and (31) of the Planning Act, R.S.O., 1990, as amended.

**READ A FIRST, SECOND AND THIRD TIME AND FINALLY PASSED  
THIS 13TH DAY OF SEPTEMBER, 2010.**

---

**M. Broomhead,  
MAYOR**

---

**L. Heinbuch,  
CHIEF ADMINISTRATIVE OFFICER/CLERK**

**THE TOWNSHIP OF WELLINGTON NORTH**

**BY-LAW NUMBER 70-10**

**Schedule "A"**

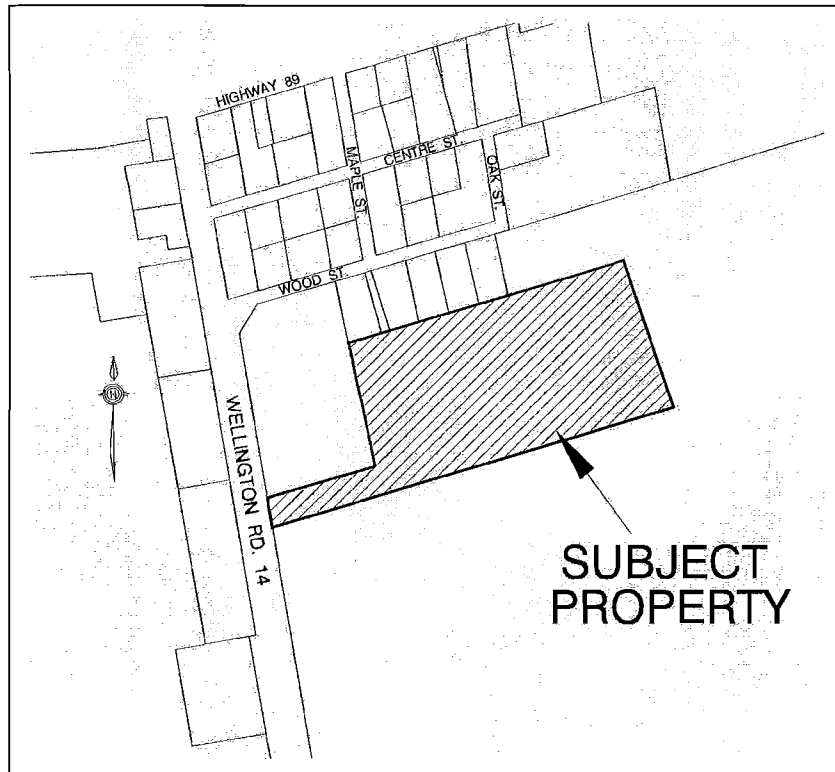

***Rezone from Agricultural (A-1) and Residential (R1A) to Institutional (IN)***

**This is Schedule "A" to By-law No. 70-10  
Passed this 13th day of September, 2010**

---

**M. Broomhead, MAYOR**

---

**L. Heinbuch, C.A.O./CLERK**

# **EXPLANATORY NOTE**

## **BY-LAW NUMBER 70-10**

**THE LOCATION OF THE SUBJECT PROPERTY** is described as Lot 1, Concession 14 and is located mainly in the Hamlet of Conn. The parcel subject to this application is currently farmed and consist of approximately 2.8 ha (7 ac).

**THE PURPOSE AND EFFECT** of the amendment is to rezone the lands to Institutional to permit a parochial school, church, cemetery and related uses. The subject land was granted a severance (B49/10) on June 10, 2010 by the Wellington County Land Division Committee.

**THE CORPORATION OF THE  
TOWNSHIP OF WELLINGTON NORTH**

**BY-LAW NUMBER 71-10**

**BEING A BY-LAW TO AUTHORIZE THE ESTABLISHMENT OF A  
COMPLIANCE AUDIT COMMITTEE FOR THE 2010 MUNICIPAL  
ELECTION PERIOD**

**AUTHORITY:** Municipal Elections Act, 1996, as amended, Section 45 and 46

**WHEREAS** Section 81.1 (1) of the *Municipal Elections Act*, 1996, as amended, states that a council or local board shall, before October 1 of an election year, establish a committee for the purposes of Section 81 of the *Act*; and

**AND WHEREAS** Section 81.1 (4) of the *Municipal Elections Act*, 1996, as amended, states that the clerk of the municipality or the secretary of the local board, as the case may be, shall establish administrative practices and procedures for the committee and shall carry out any other duties required under this *Act* to implement the committee's decisions; and

**AND WHEREAS** the Council of the Corporation of the Township of Wellington North deems it advisable to appoint a Compliance Audit Committee for the 2010 Municipal Election and to set out the terms of reference of the committee;

**NOW THEREFORE THE MUNICIPAL COUNCIL OF THE CORPORATION OF THE  
TOWNSHIP OF WELLINGTON NORTH ENACTS AS FOLLOWS:**

1. That the following persons be appointed to the Compliance Audit Committee for the period of December 1st, 2010 to November 30th, 2014:
  - Mary Schmidt
  - Al Rawlins
  - Steve Dineen

2. That the Council of the Corporation of the Township of Wellington North adopts the Terms of Reference for the Compliance Audit Committee, attached hereto as Schedule "A", to meet the requirements of Section 81.1(4) of the Municipal Elections Act, 1996 (as amended).
3. That this By-Law shall come into force and take effect upon the date of the final passing thereof.

**READ A FIRST, SECOND AND THIRD TIME AND FINALLY PASSED  
THIS 13TH DAY OF SEPTEMBER, 2010.**

---

**MICHAEL BROOMHEAD,  
MAYOR**

---

**LORRAINE HEINBUCH  
CHIEF ADMINISTRATIVE OFFICER/CLERK**



**Schedule "A"**  
**to By-law No. 71-10**

**TERMS OF REFERENCE**

**1. Name**

- a) The name of the Committee is the "Township of Wellington North 2010 Municipal Election Compliance Audit Committee." This Committee will hereby be referred to as "the Committee" within this document.

**2. Duration**

- a) The term of office for the Committee shall be the same as the term of office for Council, which is December 1, 2010 to November 30, 2014.
- b) The Committee must be established before October 1<sup>st</sup> of an election year and will complete its work after dealing with all compliance audit applications received from the Municipal Election. The Committee will be in place for any by-elections that occur during the term.

**3. Mandate**

- a) The Committee has authority, pursuant to the Municipal Elections Act, 1996, Section 81:
- I. to grant or reject compliance audit application
  - II. to appoint an auditor to conduct the audit where the application is granted and to receive the results
  - III. to commence legal proceedings against the candidate for any apparent contravention within 30 days of receiving the auditor's report
  - IV. to make a finding whether or not there was reasonable grounds for making the application if the auditor's report concludes the candidate did not appear to have contravened a provision of the Municipal Elections Act, 1996, relating to election campaign finances.
- b) A compliance audit can be requested by an elector, who:
- I. is entitled to voting in an election;
  - II. believes on reasonable grounds that a candidate has contravened the Municipal Elections Act, 1996, relating to election campaign finances;

by filing a written application (setting out the reasons for the elector's belief) with the Deputy Clerk of the municipality within 90 days after the latest of:

- the statutory filing date for the candidate's filing statement (as defined in section 77)
  - the candidate's supplementary filing date, if any, or
  - the filing date for the final financial statement under section 79.1 or
  - the end of a candidate's extension for filing granted under subsection 80(4) , if any.
- c) The Deputy Clerk shall forward the application to the Committee within ten (10) days of receipt and provide a copy to Council.
- d) The Committee must consider the application and make a decision within thirty (30) days after receiving the application from the Deputy Clerk as to whether the application should be granted or rejected.
- e) The decision may be appealed to the Ontario Court of Justice within fifteen (15) days after the decision is made by the Committee and the Court may make any decision the Committee could have made.
- f) Where the application for a compliance audit has been approved, the Committee shall, by resolution, appoint an auditor to conduct a compliance audit. Only auditors licensed under the Public Accounting Act, 2004, or other "prescribed persons" may be appointed as auditors.
- g) The auditor shall:
- I. promptly conduct an audit;
  - II. have access at all reasonable hours to all relevant books, papers, receipts, vouchers or other things of the candidate;
  - III. have the powers of a commission under Part II of the Public Inquiries Act;
  - IV. determine whether the candidate has complied with the provisions of the Municipal Elections Act, 1996, as they relate to election campaign finances;
  - V. prepare a report outlining any apparent contraventions of the Act; and
  - VI. submit the report to the candidate, Council, Clerk with whom the papers were filed, secretary of the local board (if applicable) and applicant.
- h) Within ten (10) days of receiving the auditor's report, the Clerk of the municipality shall forward the report to the Committee.

- i) The Committee shall consider the report of the auditor within thirty (30) days and may:
  - commence a legal proceeding against the candidate if the report concludes that the candidate appears to have contravened a provision of the Act relating to election campaign finances and
  - make a finding as to whether there were reasonable grounds for the application if the report concludes that the candidate did not appear to have contravened a provision of the Act relating to election campaign finances.
- j) The municipality shall pay the auditor's costs of performing the audit; however, these costs may be recovered from the applicant where no reasonable grounds for the application were found.

**4. Membership**

- a) The Committee will be composed of three (3) members
- b) Members of Council, Township staff and any candidates in the 2010 Municipal Election, for which the Committee has been established, will not be eligible to be appointed to the Committee.
- c) To avoid any potential conflict of interest, applicants with accounting or auditing backgrounds must agree in writing that they will not offer their services to any municipal election candidates.
- d) All Committee members must agree in writing that they will not work for or provide advice to any candidate running for municipal office within the Township of Wellington North.

**5. Chair**

- a) The Committee members will select a Chair from among its member at its first meeting.

**6. Staffing and Funding**

- a) Staff from the Clerk's office will provide administrative support to the Committee. The necessary funding will be paid from an Elections Reserve Fund. The Deputy-Clerk shall attend meetings.

**7. Meetings**

- a) Meetings of the Committee will be conducted in accordance with the Township of Wellington North Procedural By-law.
- b) The Committee shall meet as needed with meetings to be scheduled by the Deputy-Clerk, in consultation with the Chair, when a compliance audit application is received.

**8. Remuneration**

- a) \$100.00/application meeting (average of 2 meetings per application), plus mileage (paid at the rate approved by Council).

**TOWNSHIP OF WELLINGTON NORTH**  
**Regular Meeting of Council**

MOVED BY: \_\_\_\_\_ DATE: September 13, 2010

SECONDED BY: \_\_\_\_\_ RES. NO.: \_\_\_\_\_

**THAT the Council of the Corporation of the Township of Wellington North approve the accounts totalling \$4,055,991.10 for payment.**

MAYOR \_\_\_\_\_

CARRIED

DEFEATED

Township of Wellington North  
 CHEQUE DISTRIBUTION REPORT  
 Payables Management

Ranges: From: To: From: To:  
 Vendor ID First Last Chequebook ID First Last  
 Vendor Name First Last Cheque Number 044324 044634  
 Cheque Date First Last

Sorted By: Cheque Number

Distribution Types Included: PURCH, TRADE, MISC, FREIGHT, TAXES, WRITE, OTHER, GST

ChqNo:	044324	Date:	8/10/2010	Vendor:	Wellington Catholic Dist Sch B	Amount:	\$19,250.00
InvNo:	DEPOSIT-OFFER TO PUR	InvDesc:	ADM - Deposit - Offer to Purch	InvAmt:		\$19,250.00	
ChqNo:	044325	Date:	8/11/2010	Vendor:	1424331 Ont. Ltd.	Amount:	\$734.66
InvNo:	JUNE16/10 INVOICE	InvDesc:	REC/MF Acid/Stabilizer	InvAmt:		\$475.72	
InvNo:	JUNE18/10 INVOICE	InvDesc:	REC/MF PH Plus 8kg	InvAmt:		\$32.77	
InvNo:	JULY20/10 INVOICE	InvDesc:	REC/MF R000 1/2/4 60mils	InvAmt:		\$54.52	
InvNo:	JULY26/10 INVOICE	InvDesc:	REC/MF Acid/Amaze	InvAmt:		\$171.65	
ChqNo:	044326	Date:	8/11/2010	Vendor:	A W Sills Sales & Services Ltd	Amount:	\$129.38
InvNo:	INV 82555	InvDesc:	REC/AV StrideClnr/GrbgBags/Ppr	InvAmt:		\$129.38	
ChqNo:	044327	Date:	8/11/2010	Vendor:	Agrisan SC Pharma	Amount:	\$1,158.16
InvNo:	INV 76997	InvDesc:	WW SodiumHypochlorite12%	InvAmt:		\$1,158.16	
ChqNo:	044328	Date:	8/11/2010	Vendor:	Alltreat Farms	Amount:	\$207.92
InvNo:	INV IN0096157	InvDesc:	BW Yardwaste	InvAmt:		\$207.92	
ChqNo:	044329	Date:	8/11/2010	Vendor:	Aquatech Logistics Inc.	Amount:	\$457.01
InvNo:	INV 216566	InvDesc:	REC/AV SodiumHypochlorite	InvAmt:		\$397.91	
InvNo:	INV 216634	InvDesc:	REC/AV HydrochloricAcid	InvAmt:		\$59.10	
ChqNo:	044330	Date:	8/11/2010	Vendor:	Benn, Jason	Amount:	\$236.00
InvNo:	JULY2010 MILEAGE	InvDesc:	FIRE/MF July2010 mileage	InvAmt:		\$236.00	
ChqNo:	044331	Date:	8/11/2010	Vendor:	Brent D. Rawn Electric	Amount:	\$146.14
InvNo:	INV 1014	InvDesc:	ADM/Office light repair	InvAmt:		\$146.14	
ChqNo:	044332	Date:	8/11/2010	Vendor:	Broadline Equipment Rental Ltd.	Amount:	\$90.40
InvNo:	INV 01-3064	InvDesc:	SS/GasFloorSawRental	InvAmt:		\$90.40	
ChqNo:	044333	Date:	8/11/2010	Vendor:	Canadian Red Cross	Amount:	\$100.00
InvNo:	2010-2011 RENEWAL	InvDesc:	REC/MF&AV 2010/2011RenewalFee	InvAmt:		\$100.00	
ChqNo:	044334	Date:	8/11/2010	Vendor:	Chalmers Fuels Inc	Amount:	\$1,028.47
InvNo:	INV 374707	InvDesc:	BW ClearDiesel	InvAmt:		\$672.11	
InvNo:	INV 374708	InvDesc:	BW DyedDiesel	InvAmt:		\$356.36	
ChqNo:	044335	Date:	8/11/2010	Vendor:	Coffey Plumbing	Amount:	\$108.48
InvNo:	INV 11607	InvDesc:	REC/AV SrvcCallA/CPool	InvAmt:		\$54.24	
InvNo:	INV 11611	InvDesc:	REC/DamascusHallSrvcCallPrsrS	InvAmt:		\$54.24	
ChqNo:	044336	Date:	8/11/2010	Vendor:	Corporate Express	Amount:	\$464.78
InvNo:	INV 25545207	InvDesc:	ADM/ElectionPaper/BindingCombs	InvAmt:		\$183.49	
InvNo:	INV 25501457	InvDesc:	ADM Paper	InvAmt:		\$92.14	
InvNo:	INV 25544791	InvDesc:	ADM PaperMousePadsFlagsNoteboc	InvAmt:		\$189.15	
ChqNo:	044337	Date:	8/11/2010	Vendor:	Elmira Farm Service (2000) Ltd.	Amount:	\$5,977.70
InvNo:	INV 940784	InvDesc:	BW PoettingerNovadisc/HighSkid	InvAmt:		\$9,977.70	
ChqNo:	044338	Date:	8/11/2010	Vendor:	Gord Davenport Automotive Inc	Amount:	\$221.77
InvNo:	INV 14415-23240	InvDesc:	BW ShopTowelsOnRoll	InvAmt:		\$67.53	
InvNo:	INV 14415-23245	InvDesc:	BW Microvbelt	InvAmt:		\$61.70	
InvNo:	INV 14415-23449	InvDesc:	BW Halogen Beam	InvAmt:		\$12.84	
InvNo:	INV 14415-23030	InvDesc:	ADM PaperTowels/ToiletTissue	InvAmt:		\$79.70	
ChqNo:	044339	Date:	8/11/2010	Vendor:	HAWKRIGG, GINNY	Amount:	\$55.00
InvNo:	REFUND#48686	InvDesc:	REC/MF RefundChildNotReady	InvAmt:		\$55.00	
ChqNo:	044340	Date:	8/11/2010	Vendor:	Hydro One Networks Inc.	Amount:	\$40.38

Township of Wellington North  
 CHEQUE DISTRIBUTION REPORT  
 Payables Management

InvNo: 28380-06092 JULY2010 InvDesc: CEM/Egremont July30/2010bill InvAmt: \$40.38

ChqNo:	044341	Date:	8/11/2010	Vendor:	Ideal Supply Company Limited	Amount:	\$68.28
	InvNo: INV 2124247		InvDesc: BW AmberLens		InvAmt: \$49.97		
	InvNo: INV 2187961		InvDesc: BW AirConditioningOil		InvAmt: \$18.31		
ChqNo:	044342	Date:	8/11/2010	Vendor:	International Trade Specialist	Amount:	\$103.58
	InvNo: INV 022747		InvDesc: COU Cup/BrassPlateLogoEngraved		InvAmt: \$103.58		
ChqNo:	044343	Date:	8/11/2010	Vendor:	J J McLellan & Son	Amount:	\$1,247.14
	InvNo: INV I014064		InvDesc: SS 4" Vinyl Sewer Cap		InvAmt: \$5.68		
	InvNo: INV I014099		InvDesc: WW 2 HO HighOutputBulbs		InvAmt: \$288.56		
	InvNo: INV I014100		InvDesc: WW SedimentCartridges		InvAmt: \$18.31		
	InvNo: INV I014101		InvDesc: WW 4"Clayx4"PlasticCoupler		InvAmt: \$13.39		
	InvNo: INV I014102		InvDesc: SS/sewer elbows/PVCcleaner&cem		InvAmt: \$53.74		
	InvNo: INV I014103		InvDesc: SS/AV 1"insertPVCquik connect		InvAmt: \$10.33		
	InvNo: INV W56737		InvDesc: WW/CorkStPrkTestBackflow&BFPsp		InvAmt: \$373.10		
	InvNo: INV W56762		InvDesc: BW/135ChrchrStDigOutDitch		InvAmt: \$123.74		
	InvNo: INV W56783		InvDesc: SS/AVSwgPlnt srvc to A/C		InvAmt: \$360.29		
ChqNo:	044344	Date:	8/11/2010	Vendor:	Keystone Computer Resources	Amount:	\$1,892.75
	InvNo: INV 201000066		InvDesc: PI&C complete care renewal		InvAmt: \$1,892.75		
ChqNo:	044345	Date:	8/11/2010	Vendor:	KIESAU, HOLLY	Amount:	\$330.00
	InvNo: REFUND #48582		InvDesc: REC/MF Refund/3childrenNotRdy		InvAmt: \$330.00		
ChqNo:	044346	Date:	8/11/2010	Vendor:	LaFarge Canada Inc.	Amount:	\$1,265.60
	InvNo: INV 17116958		InvDesc: BW ArteviaColour32c2 20mm		InvAmt: \$1,265.60		
ChqNo:	044347	Date:	8/11/2010	Vendor:	Lodwich Art	Amount:	\$42.00
	InvNo: INV 42 - JUNE2010		InvDesc: PROP/June2010JanitorialSrvc		InvAmt: \$42.00		
ChqNo:	044348	Date:	8/11/2010	Vendor:	Long's Home Hardware	Amount:	\$181.50
	InvNo: INV 2230061		InvDesc: REC/AV TltBwlClnr/Glvs/Sponge		InvAmt: \$27.28		
	InvNo: INV 2230063		InvDesc: ADM 1/2hex w/bit 10pk		InvAmt: \$12.53		
	InvNo: INV 2229826		InvDesc: WW IronOutClnr/Oil/PaintBrshs		InvAmt: \$58.86		
	InvNo: INV 2229446		InvDesc: WW WaterstopSeal		InvAmt: \$17.53		
	InvNo: INV 2229406		InvDesc: SS/HoseCnnctr/Batteries		InvAmt: \$15.27		
	InvNo: INV 2229145		InvDesc: WW ShpTwls/CLRClnr/HandSoap		InvAmt: \$50.03		
ChqNo:	044349	Date:	8/11/2010	Vendor:	MacEachern Ron	Amount:	\$353.46
	InvNo: JULY2010 MILEAGE		InvDesc: FIRE/MF July2010mileage		InvAmt: \$160.00		
	InvNo: AUG4/2010 EXPENSE RP		InvDesc: FIRE/MFRmbrs/CellPhone&TrckPrt		InvAmt: \$193.46		
ChqNo:	044350	Date:	8/11/2010	Vendor:	Martins TLC	Amount:	\$1,372.95
	InvNo: INV 16708		InvDesc: BW HogweedPatrol-ReturnVisit		InvAmt: \$56.50		
	InvNo: INV 16706		InvDesc: BW/AV FinalsanApplications		InvAmt: \$898.35		
	InvNo: INV 16707		InvDesc: BW/MF FinalsanApplications		InvAmt: \$418.10		
ChqNo:	044351	Date:	8/11/2010	Vendor:	Mount Forest RONA	Amount:	\$99.41
	InvNo: INV 2277640		InvDesc: REC/MF 4x8x1/2" STD Spruce		InvAmt: \$99.41		
ChqNo:	044352	Date:	8/11/2010	Vendor:	Morrison Carolann	Amount:	\$182.00
	InvNo: JULY2010 MILEAGE		InvDesc: REC/July2010mileage		InvAmt: \$182.00		
ChqNo:	044353	Date:	8/11/2010	Vendor:	Morrison Jim	Amount:	\$197.50
	InvNo: AUG.1/2010 MILEAGE		InvDesc: FIRE/AV FFAOconv.mileage		InvAmt: \$100.50		
	InvNo: JULY2010 MILEAGE		InvDesc: FIRE/AV July2010mileage		InvAmt: \$97.00		
ChqNo:	044354	Date:	8/11/2010	Vendor:	Municipal World Inc.	Amount:	\$70.37
	InvNo: INV IN00079971		InvDesc: ANIMAL/GrntApps/LvstckVlrRprts		InvAmt: \$70.37		
ChqNo:	044355	Date:	8/11/2010	Vendor:	Neopost Leasing Services Cdn Ltd.	Amount:	\$270.02
	InvNo: INV 6017839		InvDesc: ADM July2010Lease		InvAmt: \$270.02		

Township of Wellington North  
 CHEQUE DISTRIBUTION REPORT  
 Payables Management

ChqNo:	044356	Date:	8/11/2010	Vendor:	Plume'sMainStreetInteriors	Amount:	\$76.83
	InvNo: INV 128364		InvDesc: WW AntirustRedPaint		InvAmt:	\$50.63	
	InvNo: INV 128854		InvDesc: BW CorrostopWhiteGloss&Brush		InvAmt:	\$26.20	
ChqNo:	044357	Date:	8/11/2010	Vendor:	Reeves Construction Ltd	Amount:	\$337,134.94
	InvNo: PAYT.CERT.#5/EGREMON		InvDesc: BW/MFEGremontStPaytCert#5		InvAmt:	\$288,836.33	
	InvNo: PAYT.CERT.#6/NORMANB		InvDesc: BW/MFNormanbyStPaytCert#6		InvAmt:	\$48,298.61	
ChqNo:	044358	Date:	8/11/2010	Vendor:	Royal City Fastener & Industrial Supply	Amount:	\$79.04
	InvNo: INV 13510		InvDesc: BW ScrewDriverSet		InvAmt:	\$79.04	
ChqNo:	044359	Date:	8/11/2010	Vendor:	SGS Canada Inc.	Amount:	\$1,332.27
	InvNo: INV 10439381		InvDesc: WW/DamascusJune/10Anlys&Rprt		InvAmt:	\$31.64	
	InvNo: INV 10439382		InvDesc: WW/KnlwrthJune2010Anlys&Rprtng		InvAmt:	\$47.46	
	InvNo: INV 10439383		InvDesc: WW/MF June/July2010Anlys&Rprt		InvAmt:	\$753.71	
	InvNo: INV 10439380		InvDesc: WW/AV June-July2010Anlys&Rprt		InvAmt:	\$499.46	
ChqNo:	044360	Date:	8/11/2010	Vendor:	Spahr Linda	Amount:	\$113.00
	InvNo: JULY2010 MILEAGE		InvDesc: REC/July2010mileage		InvAmt:	\$113.00	
ChqNo:	044361	Date:	8/11/2010	Vendor:	SPARK, RICHARD	Amount:	\$1,900.00
	InvNo: ENT.RFND/PRMT#100038		InvDesc: A/R EntranceRefundPrmt#10-0038		InvAmt:	\$1,900.00	
ChqNo:	044362	Date:	8/11/2010	Vendor:	Triton Engineering Services	Amount:	\$8,046.38
	InvNo: INV 040258		InvDesc: SS/AVSmithFredereickStSSJune10		InvAmt:	\$8,046.38	
ChqNo:	044363	Date:	8/11/2010	Vendor:	Union Gas	Amount:	\$4,242.19
	InvNo: 24817592477383JULY10		InvDesc: FIRE/AV Hall July27/10bill		InvAmt:	\$30.16	
	InvNo: 24818182569153JULY10		InvDesc: REC/AV Pool July26/2010bill		InvAmt:	\$3,014.33	
	InvNo: 24816922242907JULY10		InvDesc: PROP/AV SeniorsHallJuly26/10bi		InvAmt:	\$29.85	
	InvNo: 24816492242870JULY10		InvDesc: REC/AV Arena July26/10bill		InvAmt:	\$331.53	
	InvNo: 24816442242865JULY10		InvDesc: BW/AV Shop July26/10bill		InvAmt:	\$41.71	
	InvNo: 24818182642419JULY10		InvDesc: REC/MF Arena July20/10bill		InvAmt:	\$742.57	
	InvNo: 40588522114421JULY10		InvDesc: PROP/MF OldDaycareJuly20/10bil		InvAmt:	\$30.56	
	InvNo: 24817592624272JULY10		InvDesc: SS/AV WWTP July26/10bill		InvAmt:	\$21.48	
ChqNo:	044364	Date:	8/11/2010	Vendor:	Van Houtte Coffee Services	Amount:	\$93.45
	InvNo: INV 67342096-2011		InvDesc: REC/AV TeaCoffeeSoups		InvAmt:	\$93.45	
ChqNo:	044365	Date:	8/11/2010	Vendor:	Viking Cives Ltd	Amount:	\$46.90
	InvNo: INV 2622491		InvDesc: BW TowEye		InvAmt:	\$46.90	
ChqNo:	044366	Date:	8/11/2010	Vendor:	Wallace Ian	Amount:	\$1,085.00
	InvNo: JULY2010 PREVENTION		InvDesc: FIRE/MF July2010PreventionWork		InvAmt:	\$1,085.00	
ChqNo:	044367	Date:	8/11/2010	Vendor:	Walsh's Pharmacy	Amount:	\$14.33
	InvNo: JULY23/10 RECEIPT		InvDesc: REC/AV SolarCalculator		InvAmt:	\$9.03	
	InvNo: JULY30/10 RECEIPT		InvDesc: REC/AV Lysol		InvAmt:	\$5.30	
ChqNo:	044368	Date:	8/11/2010	Vendor:	Watson Tractors & Eq Inc	Amount:	\$874.42
	InvNo: INV 140163		InvDesc: BW HydraulicOil		InvAmt:	\$874.42	
ChqNo:	044369	Date:	8/11/2010	Vendor:	Wellington Advertiser	Amount:	\$1,287.60
	InvNo: INV 87218		InvDesc: ADMElectionNominationCandidate		InvAmt:	\$1,287.60	
ChqNo:	044370	Date:	8/11/2010	Vendor:	Wellington North Power	Amount:	\$31,521.55
	InvNo: 1104.1.80-JUL/10		InvDesc: SL/AV&MF July2010labour		InvAmt:	\$56.04	
	InvNo: INV 1104.1.90 JUL/10		InvDesc: WW/SS-MF&AV July2010billings		InvAmt:	\$7,925.57	
	InvNo: 00047801-00 JULY2010		InvDesc: ADM/MFLawnBowling July29/10bil		InvAmt:	\$168.04	
	InvNo: 00054750-00 JULY2010		InvDesc: REC/MF Pool July29/10bill		InvAmt:	\$1,902.07	
	InvNo: 00054800-00 JULY2010		InvDesc: REC/MF Pool July29/10bill		InvAmt:	\$86.98	



Township of Wellington North  
 CHEQUE DISTRIBUTION REPORT  
 Payables Management

InvNo: 00054900-00	JULY2010	InvDesc: WW/MF Well#3 July29/10bill	InvAmt: \$374.77
InvNo: 00059550-00	JULY2010	InvDesc: REC/MF MurphyStPark July2010	InvAmt: \$68.16
InvNo: 00065100-00	JULY2010	InvDesc: REC/MF KinsmenStBallDmndJuly10	InvAmt: \$165.88
InvNo: 00065300-00	JULY2010	InvDesc: REC/MF KingStBallDmnd July2010	InvAmt: \$92.02
InvNo: 00012375-00	JULY2010	InvDesc: REC/MF KingStPoleJuly2010	InvAmt: \$31.27
InvNo: 00012700-01	JULY2010	InvDesc: WW/MF Well#5 July2010bill	InvAmt: \$1,649.24
InvNo: 00033050-00	JULY2010	InvDesc: PROP/MFMainStOfficeJuly29/10bi	InvAmt: \$212.37
InvNo: 00033075-01	JULY2010	InvDesc: SL/MF MainStTraffic July29/10b	InvAmt: \$444.41
InvNo: 00000397-00	AUG2010	InvDesc: SS/AV WellsStPmp Aug6/10bill	InvAmt: \$314.22
InvNo: 00000398-00	AUG2010	InvDesc: WW/AV Well#7 Aug6/10bill	InvAmt: \$871.64
InvNo: 00000407-00	AUG2010	InvDesc: WW/AV Well15Tower Aug6/10	InvAmt: \$125.67
InvNo: 00000409-00	AUG2010	InvDesc: WW/AV Well#5 Aug6/10bill	InvAmt: \$64.43
InvNo: 00000554-00	AUG2010	InvDesc: BW/AV Shop Aug6/10bill	InvAmt: \$151.38
InvNo: 00000592-01	AUG2010	InvDesc: REC/AV Arena Aug6/10bill	InvAmt: \$5,488.97
InvNo: 00000814-00	AUG2010	InvDesc: WW/AV Well#1 Aug6/10bill	InvAmt: \$103.29
InvNo: 00000837-00	AUG2010	InvDesc: PROP/AVSeniorsHall Aug6/10bill	InvAmt: \$119.73
InvNo: 00001194-01	AUG2010	InvDesc: REC/AV TuckerStCampPoleAug2010	InvAmt: \$31.74
InvNo: 00001560-03	AUG2010	InvDesc: SS/AV PrestonStSwg Aug6/10bill	InvAmt: \$9,522.73
InvNo: 00002012-00	AUG2010	InvDesc: SL/AVGeorgeStLight Aug6/10bill	InvAmt: \$31.74
InvNo: 00002013-00	AUG2010	InvDesc: SL/AV FrederickTraffic Aug6/10	InvAmt: \$31.74
InvNo: 0000247-00	AUG2010	InvDesc: PROP/AVGeorgeStOfficeAug2010	InvAmt: \$124.22
InvNo: 00000280-00	AUG2010	InvDesc: SS/AV FrederickStPumpStnAug/10	InvAmt: \$581.10
InvNo: 00000296-01	AUG2010	InvDesc: FIRE/AV Hall Aug6/10bill	InvAmt: \$644.15
InvNo: 00000075-00	AUG2010	InvDesc: SS/AVRdl09HeaterCordAug2010	InvAmt: \$31.74
InvNo: 0000168-00	AUG2010	InvDesc: SL/AV George&Charles Aug6/10bi	InvAmt: \$52.49
InvNo: 00000177-00	AUG2010	InvDesc: SL/AV George&FrederickSt Aug10	InvAmt: \$53.75

ChqNo: 044371	Date: 8/11/2010	Vendor: Wightman Communications Ltd.	Amount: \$43.68
---------------	-----------------	--------------------------------------	-----------------

InvNo: INV 40365 InvDesc: BW CellPhone&Adptr InvAmt: \$107.23

ChqNo: 044372	Date: 8/11/2010	Vendor: Yake Electric Ltd	Amount: \$74.50
---------------	-----------------	---------------------------	-----------------

InvNo: INV 3129 InvDesc: REC/AV RplcPhotocell@Dmnd InvAmt: \$74.50

ChqNo: 044373	Date: 8/11/2010	Vendor: Young's Home Hardware Bldg Centre	Amount: \$118.32
---------------	-----------------	-------------------------------------------	------------------

InvNo: INV 231740 InvDesc: BW DuctTape InvAmt: \$5.64

InvNo: INV 229156 InvDesc: REC/AV SolarThermometer InvAmt: \$28.27

InvNo: INV 229316 InvDesc: REC/MF SolarThermometer InvAmt: \$28.27

InvNo: INV 229429 InvDesc: BW GarbageBags InvAmt: \$30.50

InvNo: INV 228841 InvDesc: WW HexKeySet InvAmt: \$5.64

InvNo: INV 229300 InvDesc: WW Batteries InvAmt: \$10.26

InvNo: INV 229436 InvDesc: WW RustPaint/Brushes InvAmt: \$9.74

ChqNo: 044374	Date: 8/17/2010	Vendor: Deverell & Lemaich LLP	Amount: \$174,900.00
---------------	-----------------	--------------------------------	----------------------

InvNo: BAL-PURCHASE-SCHOOL InvDesc: ADM -Balance-Purchase of Schoc InvAmt: \$174,900.00

ChqNo: 044375	Date: 8/18/2010	Vendor: 2199645 Ontario Inc.	Amount: \$500.00
---------------	-----------------	------------------------------	------------------

InvNo: APPLICATION FEE RFND InvDesc: P&Z ApplicationFeeRefund InvAmt: \$500.00

ChqNo: 044376	Date: 8/18/2010	Vendor: A W Sills Sales & Services Ltd	Amount: \$296.85
---------------	-----------------	----------------------------------------	------------------

Township of Wellington North  
 CHEQUE DISTRIBUTION REPORT  
 Payables Management

InvNo: INV 82608      InvDesc: REC/MF GbrgBgsGlvsPprTwlsTltPf      InvAmt: \$296.85

ChqNo:	044377	Date:	8/18/2010	Vendor:	BASELINE CONSTRUCTORS INC.	Amount:	\$123,867.09
--------	--------	-------	-----------	---------	----------------------------	---------	--------------

InvNo: PAYT.CERT.#7/CORK ST      InvDesc: SS/MFCorkStPmtStnPaytCert#7      InvAmt: \$123,867.09

ChqNo:	044378	Date:	8/18/2010	Vendor:	Bell Canada - Public Access	Amount:	\$56.50
--------	--------	-------	-----------	---------	-----------------------------	---------	---------

InvNo: INV 100192      InvDesc: REC/MF ArenaPayphoneJuly2010      InvAmt: \$56.50

ChqNo:	044379	Date:	8/18/2010	Vendor:	Bell Canada Box 5400 & 9000	Amount:	\$3,254.97
--------	--------	-------	-----------	---------	-----------------------------	---------	------------

InvNo: 5198483620TOLL AUG10      InvDesc: ADM/KenilworthToll# Aug2010      InvAmt: \$71.07

InvNo: 519-848-5291 AUG2010      InvDesc: SS/WW-AV WPCP FaxLineAug/10      InvAmt: \$90.10

InvNo: 519-848-2506 AUG2010      InvDesc: WW/AV SCADA Aug1/2010bill      InvAmt: \$81.86

InvNo: 519-848-3021 AUG2010      InvDesc: POICE/AV office Aug1/2010bill      InvAmt: \$219.51

InvNo: 519-848-2535 AUG2010      InvDesc: FIRE/AV hall Aug1/2010bill      InvAmt: \$100.95

InvNo: 519-848-2392 AUG2010      InvDesc: REC/AV Pool Aug1/2010bill      InvAmt: \$118.28

InvNo: 519-848-2920 AUG2010      InvDesc: WW/AV Well#5 Aug1/2010bill      InvAmt: \$82.13

InvNo: 519-848-3620 AUG2010      InvDesc: ADM/KenilworthOffice Aug1/2010      InvAmt: \$2,078.29

InvNo: 519-848-3450 AUG2010      InvDesc: BW/WL Yard Aug1/2010bill      InvAmt: \$91.28

InvNo: 519-848-3820 AUG2010      InvDesc: REC/AV Arena Aug1/2010bill      InvAmt: \$106.54

InvNo: 519-848-3500 AUG2010      InvDesc: FIRE/AV Hall Aug1/2010bill      InvAmt: \$125.14

InvNo: 519-848-2340 AUG2010      InvDesc: FIRE/AV Hall Aug1/2010bill      InvAmt: \$89.82

ChqNo:	044380	Date:	8/18/2010	Vendor:	Bell Aliant c/o Special Billing	Amount:	\$66.35
--------	--------	-------	-----------	---------	---------------------------------	---------	---------

InvNo: 50050906 AUG/2010      InvDesc: BW/Bridge25CableRelocation      InvAmt: \$66.35

ChqNo:	044381	Date:	8/18/2010	Vendor:	Bell Mobility	Amount:	\$1,103.92
--------	--------	-------	-----------	---------	---------------	---------	------------

InvNo: TO-407729080 AUG/10      InvDesc: WW/SS Pagers Aug1/2010bill      InvAmt: \$19.14

InvNo: 519-321-1028 AUG2010      InvDesc: REC/MF M.MacKenzieCellAug/2010      InvAmt: \$45.57

InvNo: 519-321-1818 AUG2010      InvDesc: REC/AV T.BowdenCell Aug1/2010      InvAmt: \$39.82

InvNo: 519-321-9024 AUG2010      InvDesc: REC/MF&AV L.SpahrCell Aug2010      InvAmt: \$27.06

InvNo: 519-321-1102 AUG2010      InvDesc: FIRE/AV Hall Aug1/2010bill      InvAmt: \$41.21

InvNo: 519-321-9935 AUG2010      InvDesc: ADM/J.Jeffery cell Aug1/2010bi      InvAmt: \$30.20

InvNo: 519-323-6487 AUG2010      InvDesc: PI&C P.WrightCell Aug1/2010bil      InvAmt: \$25.23

InvNo: 519-323-6535 AUG2010      InvDesc: WW/SS OnCallCell Aug1/2010bill      InvAmt: \$72.70

InvNo: 519-323-6565 AUG2010      InvDesc: SS/WW OtherCell Aug1/2010bill      InvAmt: \$50.48

InvNo: 519-323-6730 AUG2010      InvDesc: PI&C D.JonesCell Aug1/2010bill      InvAmt: \$31.52

InvNo: 519-323-7042 AUG2010      InvDesc: BW/AV A.MorrisonCell Aug2010bi      InvAmt: \$50.21

InvNo: 519-323-7211 AUG2010      InvDesc: BW/G.WilliamsonCell Aug2010      InvAmt: \$50.14

InvNo: 519-323-7586 AUG2010      InvDesc: ADM/Emerg.Coord.Cell Aug2010bi      InvAmt: \$25.44

InvNo: 519-323-7606 AUG2010      InvDesc: COU/MayorBroomhead'sCell Aug10      InvAmt: \$58.67

InvNo: 519-323-8113 AUG2010      InvDesc: WW/SS B.TroodCell Aug2010bill      InvAmt: \$83.54

InvNo: 519-323-8129 AUG2010      InvDesc: BW/AT D.Clark'sCell Aug2010bil      InvAmt: \$79.96

InvNo: 519-323-8131 AUG2010      InvDesc: BW/WL D.Hill'sCell Aug2010bill      InvAmt: \$55.12

InvNo: 519-323-8195 AUG2010      InvDesc: BW/MF G.MathewsCell Aug2010bil      InvAmt: \$68.85

InvNo: 519-323-8423 AUG2010      InvDesc: COU/D.Yake'sCell Aug2010bill      InvAmt: \$54.16

InvNo: 519-604-8194 AUG2010      InvDesc: COU/B.Mason'sInternetStckAug10      InvAmt: \$38.98

InvNo: 519-604-8195 AUG2010      InvDesc: COU/R.Chaulk'sInternetStckAug      InvAmt: \$38.98

InvNo: 519-604-8196 AUG2010      InvDesc: COU/J.MatusinecInternetStckAug      InvAmt: \$38.98

InvNo: 519-604-8197 AUG2010      InvDesc: COU/MayorBroomhead'sIntStckAug      InvAmt: \$38.98

InvNo: 519-604-8201 AUG2010      InvDesc: COU/D.Yake'sCell Aug2010bill      InvAmt: \$38.98

Township of Wellington North  
 CHEQUE DISTRIBUTION REPORT  
 Payables Management

ChqNo:	044382	Date:	8/18/2010	Vendor:	Black & McDonald Limited	Amount:	\$1,510.95
	InvNo: INV 43-57891		InvDesc: REC/MF ERVunit rprs/motor seiz		InvAmt:	\$1,510.95	
ChqNo:	044383	Date:	8/18/2010	Vendor:	B M Ross and Associates	Amount:	\$345.98
	InvNo: INV 2941		InvDesc: A/R EastRidgeSbdvsnPhaseII Jun		InvAmt:	\$345.98	
ChqNo:	044384	Date:	8/18/2010	Vendor:	Broadline Equipment Rental Ltd.	Amount:	\$1,238.10
	InvNo: INV 01-3322		InvDesc: BW WoodchipperRental		InvAmt:	\$218.37	
	InvNo: INV 01-3315		InvDesc: BW WoodchipperRental		InvAmt:	\$314.71	
	InvNo: INV 01-3210		InvDesc: BW WoodchipperRental		InvAmt:	\$302.28	
	InvNo: INV 01-2984		InvDesc: BW WoodchipperRental		InvAmt:	\$303.97	
	InvNo: INV 01-2919		InvDesc: BW Case Orange Paint-12		InvAmt:	\$67.24	
	InvNo: INV 01-3029		InvDesc: BW EchoSunglasses x2		InvAmt:	\$31.53	
ChqNo:	044385	Date:	8/18/2010	Vendor:	Cedar Signs	Amount:	\$806.11
	InvNo: INV 18994		InvDesc: BW 6"StreetSigns/StopSigns		InvAmt:	\$806.11	
ChqNo:	044386	Date:	8/18/2010	Vendor:	Chalmers Fuels Inc	Amount:	\$4,520.99
	InvNo: INV 374799		InvDesc: BW DieselFuelClear		InvAmt:	\$2,229.23	
	InvNo: INV 374701		InvDesc: BW Diesel Fuel Clear		InvAmt:	\$710.68	
	InvNo: INV 374798		InvDesc: BW DieselFuelDyed		InvAmt:	\$1,581.08	
ChqNo:	044387	Date:	8/18/2010	Vendor:	Clark Bros Contracting	Amount:	\$7,322.41
	InvNo: INV 7680		InvDesc: BW InstallCulvertsSdrd#2&#6		InvAmt:	\$1,627.20	
	InvNo: INV 7278		InvDesc: BW HaulBGravelToSdrd#2		InvAmt:	\$949.20	
	InvNo: INV 7277		InvDesc: BW HaulBGravelToSdrd#2		InvAmt:	\$949.20	
	InvNo: INV 7279		InvDesc: BW HaulBGravelToSdrd#2		InvAmt:	\$889.88	
	InvNo: INV 7280		InvDesc: BW HaulBGravelToSdrd#2		InvAmt:	\$1,008.53	
	InvNo: INV 7281		InvDesc: BW HaulBGravelToSdrd#2		InvAmt:	\$949.20	
	InvNo: INV 7282		InvDesc: BW HaulBGravelToSdrd#2		InvAmt:	\$949.20	
ChqNo:	044388	Date:	8/18/2010	Vendor:	Coffey Plumbing	Amount:	\$89.27
	InvNo: INV 11696		InvDesc: REC/AV DrsngRm2WwTap&shwr crtg		InvAmt:	\$89.27	
ChqNo:	044389	Date:	8/18/2010	Vendor:	Conestogo Agri Systems Inc.	Amount:	\$998.36
	InvNo: INV 268783		InvDesc: WW SodiumSilicate		InvAmt:	\$998.36	
ChqNo:	044390	Date:	8/18/2010	Vendor:	Corporate Express	Amount:	\$113.24
	InvNo: INV 25596860		InvDesc: ADM&Election/PaperClipsRibbon		InvAmt:	\$113.24	
ChqNo:	044391	Date:	8/18/2010	Vendor:	Cotton's Auto Care Centre	Amount:	\$45.20
	InvNo: INV 103-47696		InvDesc: BW RubberFloorMatsRear		InvAmt:	\$45.20	
ChqNo:	044392	Date:	8/18/2010	Vendor:	County of Wellington	Amount:	\$475.60
	InvNo: INV 19892		InvDesc: ADM 911 Signs		InvAmt:	\$135.60	
	InvNo: INV 2080		InvDesc: A/R MrkhmWtrlMmnt/SitePlanCont		InvAmt:	\$170.00	
	InvNo: INV 2079		InvDesc: A/R HomeHardware/SitePlanContr		InvAmt:	\$170.00	
ChqNo:	044393	Date:	8/18/2010	Vendor:	Cudney Steve	Amount:	\$150.00
	InvNo: AUG2010CARETAKER		InvDesc: REC/Damascus Aug2010caretaker		InvAmt:	\$150.00	
ChqNo:	044394	Date:	8/18/2010	Vendor:	Deverell & Lemaich LLP	Amount:	\$4,859.24
	InvNo: JULY26/10ACCT DMSCS		InvDesc: PpteStnd/DmscsEmprmJuly26/10ac		InvAmt:	\$992.83	
	InvNo: JULY19/10ACCT AVCOM		InvDesc: A/R Avcom May-July2010srvc		InvAmt:	\$382.56	
	InvNo: JULY29/10ACCT EASTRD		InvDesc: A/R EastridgeSbdvsnPh2/July10a		InvAmt:	\$3,483.85	
ChqNo:	044395	Date:	8/18/2010	Vendor:	E Cox Sanitation	Amount:	\$53.11
	InvNo: INV 0000144494		InvDesc: REC/MF Washer x2		InvAmt:	\$53.11	
ChqNo:	044396	Date:	8/18/2010	Vendor:	Elmira Farm Service (2000) Ltd.	Amount:	\$1,017.00
	InvNo: INV 96480		InvDesc: CEM DrivewayScraper		InvAmt:	\$1,017.00	
ChqNo:	044397	Date:	8/18/2010	Vendor:	Excel Business Systems	Amount:	\$914.18
	InvNo: INV 91109		InvDesc: ADM ColourCopierJuly2010		InvAmt:	\$665.23	

Township of Wellington North  
 CHEQUE DISTRIBUTION REPORT  
 Payables Management

InvNo:	INV 91108	InvDesc:	ADM DigitalCopierJuly2010	InvAmt:	\$248.95		
ChqNo:	044398	Date:	8/18/2010	Vendor:	FISHER, JENNIE	Amount:	\$46.00
InvNo:	REFUND #48965	InvDesc:	REC/RfndDueToPoolClosure	InvAmt:	\$46.00		
ChqNo:	044399	Date:	8/18/2010	Vendor:	FLEWELLING, GORD	Amount:	\$389.50
InvNo:	LVSTCK VLR/AUG2010	InvDesc:	ANIMAL/ValuerMurrayKaminskiPar	InvAmt:	\$389.50		
ChqNo:	044400	Date:	8/18/2010	Vendor:	FOSTER SEWER SERVICES	Amount:	\$2,248.70
InvNo:	INV 10-0083A	InvDesc:	WW HydrovacSligoRdJuly29/10	InvAmt:	\$627.15		
InvNo:	INV 10-0083	InvDesc:	BW Flush&VacuumBlckdStormRona	InvAmt:	\$576.30		
InvNo:	INV 10-0077	InvDesc:	SS/HydrovacManholeTuckerStVlve	InvAmt:	\$1,045.25		
ChqNo:	044401	Date:	8/18/2010	Vendor:	Freeziecat Appliance Service	Amount:	\$343.52
InvNo:	INV 05694	InvDesc:	REC/MFOldChestFreezer/NotFixed	InvAmt:	\$33.90		
InvNo:	INV 05693	InvDesc:	REC/MF RprsToRapidCooler	InvAmt:	\$309.62		
ChqNo:	044402	Date:	8/18/2010	Vendor:	Frey Communications	Amount:	\$581.88
InvNo:	INV 4911	InvDesc:	WW/PrinterToner	InvAmt:	\$154.76		
InvNo:	INV 4877	InvDesc:	EDC Toner/Lexmark	InvAmt:	\$168.37		
InvNo:	INV 4860	InvDesc:	ADM/PI&C/REC LaminatorFilm/Ink	InvAmt:	\$258.75		
ChqNo:	044403	Date:	8/18/2010	Vendor:	Georgian Firegear Service	Amount:	\$283.86
InvNo:	INV SI-9808	InvDesc:	FIRE/MF CleanHoodSingle	InvAmt:	\$283.86		
ChqNo:	044404	Date:	8/18/2010	Vendor:	Gord Davenport Automotive Inc	Amount:	\$166.66
InvNo:	INV 14415-23768	InvDesc:	BW FstOrange/Adhesive/Silicone	InvAmt:	\$45.37		
InvNo:	INV 14415-23517	InvDesc:	FIRE/MF Circ.Breaker	InvAmt:	\$8.59		
InvNo:	INV 14415-23512	InvDesc:	FIRE/MF ComboWrench/Fuse/Lmp	InvAmt:	\$19.27		
InvNo:	INV 14415-23450	InvDesc:	BW HalogenBeam	InvAmt:	\$38.51		
InvNo:	INV 14415-22036	InvDesc:	BW ElectrTape/HoseClamps/Scdrv	InvAmt:	\$9.13		
InvNo:	INV 14415-21907	InvDesc:	BW LithiumGrease/SprayNine	InvAmt:	\$45.79		
ChqNo:	044405	Date:	8/18/2010	Vendor:	Grasshopper Painting	Amount:	\$5,046.50
InvNo:	JULY30/10INV ARCHIVE	InvDesc:	PROP/ArchivesFloorRefinished	InvAmt:	\$5,046.50		
ChqNo:	044406	Date:	8/18/2010	Vendor:	GREIN, JACOB	Amount:	\$1,900.00
InvNo:	ENTRANCE DPST RFND	InvDesc:	A/REntranceRefund/Prmt#10-0084	InvAmt:	\$1,900.00		
ChqNo:	044407	Date:	8/18/2010	Vendor:	Heinbuch Lorraine	Amount:	\$161.50
InvNo:	AUG13/10MILEAGE	InvDesc:	ADM July22-Aug13/10mileage	InvAmt:	\$161.50		
ChqNo:	044408	Date:	8/18/2010	Vendor:	HFH Inc.	Amount:	\$3,033.60
InvNo:	INV 856	InvDesc:	REC/AV Pool&DmndFenceRprs	InvAmt:	\$3,033.60		
ChqNo:	044409	Date:	8/18/2010	Vendor:	HFI Services Inc.	Amount:	\$474.60
InvNo:	INV 414	InvDesc:	REC/MF PortableToiletRentals	InvAmt:	\$474.60		
ChqNo:	044410	Date:	8/18/2010	Vendor:	Hodgkinson, Dave	Amount:	\$35.05
InvNo:	JULY21/2010 EXPNS RP	InvDesc:	FIRE/AV MutualAid/Ropes/Mileag	InvAmt:	\$35.05		
ChqNo:	044411	Date:	8/18/2010	Vendor:	Hydromantis Inc.	Amount:	\$5,670.21
InvNo:	PAYT.CERT.#5/MF WWTP	InvDesc:	SS/MF WWTP PaytCert#5	InvAmt:	\$3,575.46		
InvNo:	PAYT.CERT.#6/MF WWTP	InvDesc:	SS/MF WWTP Payt.Cert.#6	InvAmt:	\$2,094.75		
ChqNo:	044412	Date:	8/18/2010	Vendor:	Hydro One Networks Inc.	Amount:	\$82.57
InvNo:	40730-09608 AUG2010	InvDesc:	REC/ConnPark Aug3/2010bill	InvAmt:	\$82.57		
ChqNo:	044413	Date:	8/18/2010	Vendor:	Ideal Supply Company Limited	Amount:	\$96.08
InvNo:	INV 2313979	InvDesc:	REC/MF OilFilterTefLube5W30	InvAmt:	\$43.73		
InvNo:	INV 2108090	InvDesc:	REC/MF Ballast	InvAmt:	\$74.92		
ChqNo:	044414	Date:	8/18/2010	Vendor:	International Trade Specialist	Amount:	\$970.25
InvNo:	INV 022792	InvDesc:	ADM 4drwr file cbnt/metal shlf	InvAmt:	\$813.53		
InvNo:	INV 022823	InvDesc:	FIRE/AV ChairMat	InvAmt:	\$84.74		
InvNo:	INV 022795	InvDesc:	REC/Triathlon trophies/engrvng	InvAmt:	\$71.98		

Township of Wellington North  
 CHEQUE DISTRIBUTION REPORT  
 Payables Management

ChqNo:	044415	Date:	8/18/2010	Vendor:	J J LAWN CARE	Amount:	\$6,292.89
	InvNo: INV 00000661		InvDesc: REC/AV&Conn June2010cut&trims		InvAmt:	\$3,612.53	
	InvNo: INV 00000681		InvDesc: REC/AV&Conn July2010cut&trims		InvAmt:	\$2,680.36	
ChqNo:	044416	Date:	8/18/2010	Vendor:	J J McLellan & Son	Amount:	\$77.69
	InvNo: INV W56751		InvDesc: REC/MF PoolHeaterCheck		InvAmt:	\$77.69	
ChqNo:	044417	Date:	8/18/2010	Vendor:	KAMINSKI, Neil and Lianne	Amount:	\$200.00
	InvNo: LVSTCK CLM 1 EWE		InvDesc: ANIMAL/LvstckClm 1 ewe July10		InvAmt:	\$200.00	
ChqNo:	044418	Date:	8/18/2010	Vendor:	Kimbal Printing	Amount:	\$107.35
	InvNo: INV 51831		InvDesc: ADM Envelopes		InvAmt:	\$107.35	
ChqNo:	044419	Date:	8/18/2010	Vendor:	LANTZ, SHEILA	Amount:	\$115.00
	InvNo: REFUND #48959		InvDesc: REC/RfndDueToPoolClosure		InvAmt:	\$60.00	
	InvNo: REFUND #48958		InvDesc: REC/RfndDueToPoolClosure		InvAmt:	\$55.00	
ChqNo:	044420	Date:	8/18/2010	Vendor:	Lloyd Scott Enterprises Ltd	Amount:	\$700.83
	InvNo: INV 05552		InvDesc: ADM/KnlwrthOffcWndwHrdwInstltd		InvAmt:	\$700.83	
ChqNo:	044421	Date:	8/18/2010	Vendor:	Long's Home Hardware	Amount:	\$428.03
	InvNo: INV 2230905		InvDesc: BW GrassSeed		InvAmt:	\$39.54	
	InvNo: INV 2230561		InvDesc: BW Keys/Keychains		InvAmt:	\$11.21	
	InvNo: INV 2230737		InvDesc: BW CautionTape		InvAmt:	\$18.06	
	InvNo: INV 2230757		InvDesc: REC/AVScrubBrush/EmrgLgths/Pnt		InvAmt:	\$236.05	
	InvNo: INV 2229268		InvDesc: BW Sealbond/Mortar		InvAmt:	\$46.19	
	InvNo: INV 2230658		InvDesc: REC/AV Lamp/CblTies/Foam/Brsh		InvAmt:	\$76.98	
ChqNo:	044422	Date:	8/18/2010	Vendor:	Lorick Vending	Amount:	\$120.00
	InvNo: INV 8770		InvDesc: ADM&PROP/bottled water		InvAmt:	\$120.00	
ChqNo:	044423	Date:	8/18/2010	Vendor:	Maple Lane Farm Service Inc.	Amount:	\$135.87
	InvNo: INV 461018		InvDesc: BW tape		InvAmt:	\$33.90	
	InvNo: INV 462098		InvDesc: BW HydHose		InvAmt:	\$31.80	
	InvNo: INV 461940		InvDesc: BW/MF 6203-2rsnr brg/15min lbr		InvAmt:	\$47.57	
	InvNo: INV 461152		InvDesc: BW FlatLockNutFitting		InvAmt:	\$22.60	
ChqNo:	044424	Date:	8/18/2010	Vendor:	Martins TLC	Amount:	\$6,474.90
	InvNo: INV 16705		InvDesc: REC/MF JulyGrassCutting		InvAmt:	\$4,938.10	
	InvNo: INV 16709		InvDesc: REC/MF FinalsanApplctn		InvAmt:	\$339.00	
	InvNo: INV 16710		InvDesc: REC/MF TillSandyAreas@parks		InvAmt:	\$508.50	
	InvNo: INV 16733		InvDesc: REC/MF SummerFertilizerApp		InvAmt:	\$689.30	
ChqNo:	044425	Date:	8/18/2010	Vendor:	Mount Forest RONA	Amount:	\$22.01
	InvNo: INV 2278064		InvDesc: REC/MF RoundDowel/SandDisc		InvAmt:	\$9.02	
	InvNo: INV 2278062		InvDesc: REC/MF RoundDowel/SandDisc		InvAmt:	\$14.61	
ChqNo:	044426	Date:	8/18/2010	Vendor:	Minister of Finance Tile Drain	Amount:	\$27,430.60
	InvNo: INV 1720-09-AUG-2010		InvDesc: TileDrain/AnnualPayments		InvAmt:	\$27,430.60	
ChqNo:	044427	Date:	8/18/2010	Vendor:	MURRAY, Peter	Amount:	\$698.00
	InvNo: LVSTCK CLM/JULY2010		InvDesc: ANIMAL/LvstckClm 3lambslewe		InvAmt:	\$698.00	
ChqNo:	044428	Date:	8/18/2010	Vendor:	Neopost Leasing Services Cdn Ltd.	Amount:	\$270.02
	InvNo: INV 6021273		InvDesc: ADM Lease Payment		InvAmt:	\$270.02	
ChqNo:	044429	Date:	8/18/2010	Vendor:	North Wellington Co-op Service	Amount:	\$296.04
	InvNo: INV 383377		InvDesc: REC/MF ChlorineBulk		InvAmt:	\$82.99	
	InvNo: INV 386098		InvDesc: REC/AV CalciumChloride		InvAmt:	\$105.97	
	InvNo: INV 383913		InvDesc: BW BulkBoltsNutsLags		InvAmt:	\$10.81	
	InvNo: INV 384180		InvDesc: WW IronOut		InvAmt:	\$35.35	
	InvNo: INV 381190		InvDesc: WW SaltCrystal		InvAmt:	\$60.92	
ChqNo:	044430	Date:	8/18/2010	Vendor:	O'Rourke Glen	Amount:	\$92.35

Township of Wellington North  
 CHEQUE DISTRIBUTION REPORT  
 Payables Management

InvNo:	LVSTCK VLR/SEIFRIED	InvDesc:	Animal/LvstckVlr/Seifreid	InvAmt:	\$92.35		
ChqNo:	044431	Date:	8/18/2010	Vendor:	PACKET WORKS	Amount:	\$395.50
InvNo:	INV PT-19645	InvDesc:	ADM/Sept2010wireless	InvAmt:	\$395.50		
ChqNo:	044432	Date:	8/18/2010	Vendor:	PCO Services Inc.	Amount:	\$210.75
InvNo:	INV IN-2782478	InvDesc:	REC/MF PestControl July7/10	InvAmt:	\$101.70		
InvNo:	INV IN-2792497	InvDesc:	REC/AV PestControl July15/10	InvAmt:	\$109.05		
ChqNo:	044433	Date:	8/18/2010	Vendor:	PETRO-CANADA	Amount:	\$3,440.48
InvNo:	993-982-422-4 JULY10	InvDesc:	REC/MF Gas July2010	InvAmt:	\$270.98		
InvNo:	993-979-428-6 JULY10	InvDesc:	FIRE/AV Diesel/Gas July2010	InvAmt:	\$161.52		
InvNo:	993-981-434-0 JULY10	InvDesc:	WW/SS Gas July2010	InvAmt:	\$1,050.48		
InvNo:	993-242-440-2 JULY10	InvDesc:	BW Gas July2010	InvAmt:	\$810.90		
InvNo:	993-981-446-4 JULY10	InvDesc:	BW Gas July2010	InvAmt:	\$1,045.76		
InvNo:	993-981-452-2 JULY10	InvDesc:	REC/AV Gas July2010	InvAmt:	\$115.00		
ChqNo:	044434	Date:	8/18/2010	Vendor:	Plume'sMainStreetInteriors	Amount:	\$101.25
InvNo:	INV 129630	InvDesc:	REC/AV PaintArenaDoors	InvAmt:	\$101.25		
ChqNo:	044435	Date:	8/18/2010	Vendor:	Print One	Amount:	\$2,971.90
InvNo:	INV 1852	InvDesc:	EDC BTTbrochures x10,000	InvAmt:	\$1,511.94		
InvNo:	INV 1888	InvDesc:	EDC/REC NeedAPlace&RentalFcIts	InvAmt:	\$386.46		
InvNo:	INV 1929	InvDesc:	EDC BirdingTrailBrochures1000	InvAmt:	\$1,073.50		
ChqNo:	044436	Date:	8/18/2010	Vendor:	Pryde Truck Service Ltd.	Amount:	\$162.34
InvNo:	INV 0000143865	InvDesc:	BW RplcPilotValve/ExhaustLine	InvAmt:	\$162.34		
ChqNo:	044437	Date:	8/18/2010	Vendor:	Purolator Courier Ltd	Amount:	\$12.98
InvNo:	INV 3813946 5	InvDesc:	FIRE/MF courier to GeorgianFir	InvAmt:	\$12.98		
ChqNo:	044438	Date:	8/18/2010	Vendor:	Reliance Protectron Inc.	Amount:	\$319.44
InvNo:	INV 17559878	InvDesc:	SS/AV NWTPTax adj inv#17151141	InvAmt:	\$34.32		
InvNo:	INV 17295103	InvDesc:	REC/MF 2010-2011AlarmMntrng	InvAmt:	\$298.32		
ChqNo:	044439	Date:	8/18/2010	Vendor:	Reliance Home Comfort	Amount:	\$73.14
InvNo:	0021274722127177JULY	InvDesc:	REC/AV July2010RentalEquipt	InvAmt:	\$73.14		
ChqNo:	044440	Date:	8/18/2010	Vendor:	Royal Bank Visa	Amount:	\$223.25
InvNo:	G.WILLIAMSON AUG10	InvDesc:	SS/BW meals	InvAmt:	\$122.70		
InvNo:	J.MORRISON AUG2010	InvDesc:	FIRE/AV meal/gas	InvAmt:	\$98.43		
InvNo:	L.SPAHR AUG2010	InvDesc:	REC/ADM PrchsIntAug2010	InvAmt:	\$2.12		
ChqNo:	044441	Date:	8/18/2010	Vendor:	SEIFRIED, ANGELA	Amount:	\$103.80
InvNo:	LVSTCK CLM 1 LAMB	InvDesc:	Animal/LvstckClim llamb	InvAmt:	\$103.80		
ChqNo:	044442	Date:	8/18/2010	Vendor:	Siemens Water Technologies Canada, Inc.	Amount:	\$164.09
InvNo:	INV 900066136	InvDesc:	WW BkChkv Assy	InvAmt:	\$348.31		
ChqNo:	044443	Date:	8/18/2010	Vendor:	Spahr Linda	Amount:	\$90.58
InvNo:	AUG17/2010 EXPNS RPT	InvDesc:	REC/MFBatteriesPopWater/misc	InvAmt:	\$90.58		
ChqNo:	044444	Date:	8/18/2010	Vendor:	Stephen Hale	Amount:	\$994.40
InvNo:	INV 91	InvDesc:	ADM/SS July2010Janitorial	InvAmt:	\$994.40		
ChqNo:	044445	Date:	8/18/2010	Vendor:	STEWART, JENNIFER	Amount:	\$40.50
InvNo:	REFUND #48866	InvDesc:	REC/Rfnd1/2PoolPassPoolClosure	InvAmt:	\$40.50		
ChqNo:	044446	Date:	8/18/2010	Vendor:	Technical Standards & Safety Authority	Amount:	\$105.00
InvNo:	INV 5136662	InvDesc:	REC/MF ElevatingDevicesLicence	InvAmt:	\$105.00		
ChqNo:	044447	Date:	8/18/2010	Vendor:	Triton Engineering Services	Amount:	\$2,627.68
InvNo:	INV 040277	InvDesc:	REC/AVArenaElevatorJune30/10sr	InvAmt:	\$2,627.68		
ChqNo:	044448	Date:	8/18/2010	Vendor:	Van Houtte Coffee Services	Amount:	\$95.50
InvNo:	INV 67342372-2011	InvDesc:	ADM Coffee	InvAmt:	\$95.50		

Township of Wellington North  
 CHEQUE DISTRIBUTION REPORT  
 Payables Management

ChqNo:	044449	Date:	8/18/2010	Vendor:	W H Reynolds Cambridge Ltd.	Amount:	\$906.08
InvNo:	INV 20101354	InvDesc:	REC/MF 2xPlayersBench	InvAmt:	\$906.08		
ChqNo:	044450	Date:	8/18/2010	Vendor:	Waste Management	Amount:	\$1,003.39
InvNo:	INV 111210638	InvDesc:	REC/MF Arena June2010basic svc	InvAmt:	\$948.44		
InvNo:	INV 111215213	InvDesc:	REC/DmscsHall July2010basic sr	InvAmt:	\$54.95		
ChqNo:	044451	Date:	8/18/2010	Vendor:	Wellington North Machine	Amount:	\$2,492.32
InvNo:	INV 8349	InvDesc:	BW RwrkTiltedBaseOfBox/HydHose	InvAmt:	\$2,449.61		
InvNo:	INV 8374	InvDesc:	WW Rpr T Handle Wrench	InvAmt:	\$42.71		
ChqNo:	044452	Date:	8/18/2010	Vendor:	Wightman Telecom Ltd.	Amount:	\$210.80
InvNo:	ACCT12051788 JULY10	InvDesc:	SS/MF WWTP July25/10bill	InvAmt:	\$210.80		
ChqNo:	044453	Date:	8/18/2010	Vendor:	Young's Home Hardware Bldg Centre	Amount:	\$391.10
InvNo:	INV 229976	InvDesc:	REC/MF Plywood/SkateboardPrk	InvAmt:	\$67.77		
InvNo:	INV 230257	InvDesc:	REC/MF Screws/SkateboardPrk	InvAmt:	\$21.46		
InvNo:	INV 230689	InvDesc:	WW Tape/RustPaint	InvAmt:	\$37.26		
InvNo:	INV 230039	InvDesc:	WW RustPaint/Batteries	InvAmt:	\$20.03		
InvNo:	INV 230331	InvDesc:	WW PressureGauge	InvAmt:	\$7.33		
InvNo:	INV 227853	InvDesc:	WW RustPaint/WhiteCaulking	InvAmt:	\$34.13		
InvNo:	INV 229845	InvDesc:	WW GardenHose	InvAmt:	\$21.44		
InvNo:	INV 231540	InvDesc:	REC/MF CLR seal	InvAmt:	\$10.15		
InvNo:	INV 231015	InvDesc:	REC/ToiletGasketsHndlFaucet	InvAmt:	\$28.87		
InvNo:	INV 230210	InvDesc:	REC/MF Tester/Receipt/Batteries	InvAmt:	\$57.70		
InvNo:	INV 231838	InvDesc:	REC/MF TapeStrainerBrushSet	InvAmt:	\$44.32		
InvNo:	INV 231979	InvDesc:	REC/MF Acetone, Solvent	InvAmt:	\$29.37		
InvNo:	INV 232001	InvDesc:	REC/MF Discs, Sndg Ast 5" 15pk	InvAmt:	\$11.27		
ChqNo:	044454	Date:	8/24/2010	Vendor:	Deverell & Lemaich LLP	Amount:	\$67,455.00
InvNo:	LAGOON PROPERTY EXTE	InvDesc:	SS - Lagoon Property Extension	InvAmt:	\$67,455.00		
ChqNo:	044455	Date:	8/27/2010	Vendor:	A. Sharpe Contractor Limited	Amount:	\$3,800.00
InvNo:	ENTRNC RFND 09-0132	InvDesc:	A/REntrncDpstrfnd/Prmt#09-0132	InvAmt:	\$1,900.00		
InvNo:	ENTRNC RFND 10-0010	InvDesc:	A/R EntrncRfnd Prmt#2010-0010	InvAmt:	\$1,900.00		
ChqNo:	044456	Date:	8/27/2010	Vendor:	A-1 Flags Inc.	Amount:	\$453.75
InvNo:	INV 1007	InvDesc:	PROP/AV MainStFlagHardware	InvAmt:	\$453.75		
ChqNo:	044457	Date:	8/27/2010	Vendor:	The Active Network, Ltd.	Amount:	\$840.00
InvNo:	INV 2000969	InvDesc:	ADM SQLupgrade/Migratio	InvAmt:	\$840.00		
ChqNo:	044458	Date:	8/27/2010	Vendor:	Alex R. Wilson Surveying Inc.	Amount:	\$915.30
InvNo:	AUG10/10ACCT CEMETER	InvDesc:	CEM/MF Locate&RplcControlPins	InvAmt:	\$915.30		
ChqNo:	044459	Date:	8/27/2010	Vendor:	ALS Laboratory Group	Amount:	\$5,467.39
InvNo:	PAYT.CERT.#59/AV&MF	InvDesc:	SS/MF&AV RvrMntrngPaytCert#59	InvAmt:	\$5,467.39		
ChqNo:	044460	Date:	8/27/2010	Vendor:	Armstrong, Ken	Amount:	\$87.00
InvNo:	JULY30/10 MILEAGE	InvDesc:	FIRE/AV July30/10mileage	InvAmt:	\$87.00		
ChqNo:	044461	Date:	8/27/2010	Vendor:	BEARINGER, MELVIN M.	Amount:	\$1,900.00
InvNo:	ENTRNC RFND 10-0049	InvDesc:	A/R EntrncRfnd Prmt#2010-0049	InvAmt:	\$1,900.00		
ChqNo:	044462	Date:	8/27/2010	Vendor:	BELL, STACEY	Amount:	\$75.00
InvNo:	AUG2010 MILEAGE	InvDesc:	REC/MF Aug2010mileage	InvAmt:	\$75.00		
ChqNo:	044463	Date:	8/27/2010	Vendor:	Bell Canada Box 5400 & 9000	Amount:	\$88.93
InvNo:	519-824-2340 AUG2010	InvDesc:	FIRE/AV Aug13/2010bill	InvAmt:	\$59.78		
InvNo:	519-807-0413 AUG2010	InvDesc:	SS/MF CorkStSPSMntr Aug10/10bi	InvAmt:	\$29.15		
ChqNo:	044464	Date:	8/27/2010	Vendor:	Bell Mobility	Amount:	\$46.21
InvNo:	519-323-7086 AUG2010	InvDesc:	FIRE/MF RescueVanCell	InvAmt:	\$46.21		
ChqNo:	044465	Date:	8/27/2010	Vendor:	Bluewater Fire & Security	Amount:	\$1,324.47
InvNo:	INV 04-7232	InvDesc:	REC/MF Arena AnnualInspctn&Srv	InvAmt:	\$1,324.47		

Township of Wellington North  
 CHEQUE DISTRIBUTION REPORT  
 Payables Management

ChqNo:	044466	Date:	8/27/2010	Vendor:	B M Ross and Associates	Amount:	\$28,294.68
	InvNo: INV 3065		InvDesc: BW/Hwy#89CnctngLnkBrdgAug10		InvAmt:	\$2,517.52	
	InvNo: INV 3031		InvDesc: BW/MF EgremontStRcnstrctnAug10		InvAmt:	\$24,626.70	
	InvNo: INV 3012		InvDesc: A/R WoodlandEastridgePhaseII		InvAmt:	\$1,150.46	
ChqNo:	044467	Date:	8/27/2010	Vendor:	Brandt Security	Amount:	\$79.10
	InvNo: INV 12512		InvDesc: REC/MF SrvcCallOfficeLock		InvAmt:	\$79.10	
ChqNo:	044468	Date:	8/27/2010	Vendor:	Brubacher, Duane	Amount:	\$3,800.00
	InvNo: ENTRNC RFND 10-0043		InvDesc: A/R EntranceRfnd Prmt10-0043		InvAmt:	\$1,900.00	
	InvNo: ENTRNC RFND 10-0071		InvDesc: A/R EntranceRefund Prmt10-0071		InvAmt:	\$1,900.00	
ChqNo:	044469	Date:	8/27/2010	Vendor:	Brunkard Gregory, Mr & Mrs	Amount:	\$183.00
	InvNo: AUG2010 EXPENSE RPT		InvDesc: FIRE/AV FFAOconvention&milage		InvAmt:	\$183.00	
ChqNo:	044470	Date:	8/27/2010	Vendor:	Bush Enterprise	Amount:	\$158.20
	InvNo: INV 01672		InvDesc: REC/AV ArenaSrvcCallWalkInCool		InvAmt:	\$158.20	
ChqNo:	044471	Date:	8/27/2010	Vendor:	Cedar Signs	Amount:	\$28.98
	InvNo: INV 19065		InvDesc: BW AllenWrenchCentrePin		InvAmt:	\$28.98	
ChqNo:	044472	Date:	8/27/2010	Vendor:	Chalmers Fuels Inc	Amount:	\$4,817.52
	InvNo: INV 373721		InvDesc: BW DieselFuelClear		InvAmt:	\$1,986.02	
	InvNo: INV 375894		InvDesc: BW DieselFuelClear		InvAmt:	\$621.58	
	InvNo: INV 375895		InvDesc: BW DieselFuelDyed		InvAmt:	\$678.70	
	InvNo: INV 374697		InvDesc: BW DieselFuelClear		InvAmt:	\$1,425.62	
	InvNo: INV 375822		InvDesc: BW DieselFuelDyed		InvAmt:	\$105.60	
ChqNo:	044473	Date:	8/27/2010	Vendor:	Cimco Refrigeration	Amount:	\$1,454.73
	InvNo: INV 90277083		InvDesc: REC/MF IcePlantStartup&Checks		InvAmt:	\$1,587.28	
ChqNo:	044474	Date:	8/27/2010	Vendor:	Coulter Water Meter Service	Amount:	\$876.32
	InvNo: INV 2623		InvDesc: WW 4"NeptuneMeter/MFWell#6		InvAmt:	\$876.32	
ChqNo:	044475	Date:	8/27/2010	Vendor:	County of Wellington	Amount:	\$4,854.50
	InvNo: INV 19931		InvDesc: REC/BW/SS RiverstownTppngFees		InvAmt:	\$4,132.00	
	InvNo: INV 2084		InvDesc: P&Z/Hamilton MinorVarianceApp		InvAmt:	\$170.00	
	InvNo: INV 2082		InvDesc: P&Z AletteHolsteinsRezoning		InvAmt:	\$340.00	
	InvNo: INV 2083		InvDesc: P&Z FergusonMinorVarianceApp		InvAmt:	\$212.50	
ChqNo:	044476	Date:	8/27/2010	Vendor:	Doug Beatty & Sons	Amount:	\$169.50
	InvNo: INV 734365		InvDesc: FIRE/MF WallPass/BackUpGenerat		InvAmt:	\$169.50	
ChqNo:	044477	Date:	8/27/2010	Vendor:	E Cox Sanitation	Amount:	\$843.21
	InvNo: INV 0000144660		InvDesc: REC/MF PinkFoamingHandSoap		InvAmt:	\$177.98	
	InvNo: INV 0000144659		InvDesc: REC/MFdsnfctntFloorClnrPllTwls		InvAmt:	\$574.94	
	InvNo: INV 0000144743		InvDesc: REC/MF 2PlyToiletTissue		InvAmt:	\$90.29	
ChqNo:	044478	Date:	8/27/2010	Vendor:	Fire Safety Distribution Centr	Amount:	\$542.94
	InvNo: INV IN116375		InvDesc: FIRE/MF CdnEltrclCode&Various		InvAmt:	\$542.94	
ChqNo:	044479	Date:	8/27/2010	Vendor:	FOSTER SEWER SERVICES	Amount:	\$2,149.83
	InvNo: INV 10-0101		InvDesc: BW/MF CCTVstorm/culvertsEgrmnt		InvAmt:	\$1,104.58	
	InvNo: INV 10-0112		InvDesc: WW/MFHydrovacMurphyStWtrLeak		InvAmt:	\$1,045.25	
ChqNo:	044480	Date:	8/27/2010	Vendor:	Frey Communications	Amount:	\$170.63
	InvNo: INV 4927		InvDesc: REC/MF Arena DualPackBlack		InvAmt:	\$170.63	
ChqNo:	044481	Date:	8/27/2010	Vendor:	Grand River Conservation Auth	Amount:	\$11,362.25
	InvNo: 2010 3RD QRTR LEVY		InvDesc: ConsAuth/3rdQrtr2010Levy		InvAmt:	\$11,362.25	
ChqNo:	044482	Date:	8/27/2010	Vendor:	Harriston Motors Ltd.	Amount:	\$73.36
	InvNo: INV 110486		InvDesc: BW/LubeOilFilter&RprFire		InvAmt:	\$73.36	
ChqNo:	044483	Date:	8/27/2010	Vendor:	Hartman Electronics & Comun	Amount:	\$3,396.78
	InvNo: INV 32510		InvDesc: FIRE/AV SwissphonePaggers x6		InvAmt:	\$3,396.78	



Township of Wellington North  
 CHEQUE DISTRIBUTION REPORT  
 Payables Management

ChqNo:	044484	Date:	8/27/2010	Vendor:	Hillis Construction	Amount:	\$73.83
	InvNo: INV 0169		InvDesc: BW 3rolesDeckOfOfoam		InvAmt:	\$73.83	
ChqNo:	044485	Date:	8/27/2010	Vendor:	Huronina Welding	Amount:	\$13.65
	InvNo: INV R1241832		InvDesc: BW OxygenAcetylene		InvAmt:	\$13.65	
ChqNo:	044486	Date:	8/27/2010	Vendor:	Hydro One Networks Inc.	Amount:	\$1,853.00
	InvNo: 18820-44001 AUG2010		InvDesc: BW/ADM Knlwrth Aug12/10bill		InvAmt:	\$972.38	
	InvNo: 34580-11001 AUG2010		InvDesc: BW/WL shop Aug17/10bill		InvAmt:	\$197.63	
	InvNo: 09580-09017 AUG2010		InvDesc: REC/DmscsHall Aug17/10bill		InvAmt:	\$115.27	
	InvNo: 40790-15002 AUG2010		InvDesc: SL/N.EndDmscs Aug18/10bill		InvAmt:	\$38.33	
	InvNo: 36957-17002 AUG2010		InvDesc: SL/Hwy#6W Aug18/10bill		InvAmt:	\$12.27	
	InvNo: 40790-07591 AUG2010		InvDesc: SL/Conn park Aug18/10bill		InvAmt:	\$146.87	
	InvNo: 59590-15005 AUG2010		InvDesc: SL/Damascus Aug18/10bill		InvAmt:	\$203.24	
	InvNo: 81590-36001 AUG2010		InvDesc: SL/Kenilworth Aug18/10bill		InvAmt:	\$158.99	
	InvNo: 71990-15012 AUG2010		InvDesc: SL/Monck Aug18/10bill		InvAmt:	\$8.02	
ChqNo:	044487	Date:	8/27/2010	Vendor:	Ideal Supply Company Limited	Amount:	\$18.80
	InvNo: INV 2316645		InvDesc: REC/MF AirFilter/FilterWrench		InvAmt:	\$18.80	
ChqNo:	044488	Date:	8/27/2010	Vendor:	International Trade Specialist	Amount:	\$230.51
	InvNo: INV 022730		InvDesc: RecFireBwWw/InkPaperCDsBatteri		InvAmt:	\$230.51	
ChqNo:	044489	Date:	8/27/2010	Vendor:	John W. Jeffery	Amount:	\$1,387.83
	InvNo: AUG2010 EXPENSE RPR'T		InvDesc: ADM AMOconf expenses/mileage		InvAmt:	\$1,387.83	
ChqNo:	044490	Date:	8/27/2010	Vendor:	Jo-Alan Enterprises	Amount:	\$2,400.12
	InvNo: INV JULY-2010		InvDesc: ANIMAL/July2010Standby&Fees		InvAmt:	\$2,400.12	
ChqNo:	044491	Date:	8/27/2010	Vendor:	William Johnings	Amount:	\$107.15
	InvNo: 2010SENIORS REBATE		InvDesc: A/R 2010SeniorsRebate/R#3-0080		InvAmt:	\$107.15	
ChqNo:	044492	Date:	8/27/2010	Vendor:	Kinetics Noise Control	Amount:	\$4,327.90
	InvNo: INV 6929		InvDesc: SS/AcousticPanels x8		InvAmt:	\$4,327.90	
ChqNo:	044493	Date:	8/27/2010	Vendor:	LaFarge Canada Inc.	Amount:	\$2,440.80
	InvNo: INV 17373364		InvDesc: BW ArteviaColour 32C2 20MM		InvAmt:	\$1,265.60	
	InvNo: INV 17356464		InvDesc: BW ArteviaColour 32C2 20MM		InvAmt:	\$1,175.20	
ChqNo:	044494	Date:	8/27/2010	Vendor:	Long's Home Hardware	Amount:	\$221.98
	InvNo: INV 2231061		InvDesc: REC/AV ExteriorPaint		InvAmt:	\$175.14	
	InvNo: INV 2231175		InvDesc: REC/AV ExteriorPaintFrameRefil		InvAmt:	\$46.84	
ChqNo:	044495	Date:	8/27/2010	Vendor:	Manulife Financial	Amount:	\$15,587.63
	InvNo: SEPT2010 REMITTANCE		InvDesc: ADM/REC/PI&C/BW Sept2010remitt		InvAmt:	\$15,587.63	
ChqNo:	044496	Date:	8/27/2010	Vendor:	Martins TLC	Amount:	\$135.60
	InvNo: INV 16749		InvDesc: REC/MF WeedControl@arena		InvAmt:	\$135.60	
ChqNo:	044497	Date:	8/27/2010	Vendor:	McCabe Terry	Amount:	\$88.50
	InvNo: PPTE STNDRDS MTG		InvDesc: PI&C PprtStndrdsCmmMtgAug17/10		InvAmt:	\$88.50	
ChqNo:	044498	Date:	8/27/2010	Vendor:	McLellan, Joan	Amount:	\$335.13
	InvNo: REFUND #49220		InvDesc: A/R-REC CnclldNov13Banquet		InvAmt:	\$36.32	
	InvNo: REFUND #49221		InvDesc: A/R-REC CnclldNov13Banquet		InvAmt:	\$298.81	
ChqNo:	044499	Date:	8/27/2010	Vendor:	Mount Forest Motors	Amount:	\$45.20
	InvNo: INV 2471		InvDesc: FIRE/MF RplcLeftRearEmergBulb		InvAmt:	\$45.20	
ChqNo:	044500	Date:	8/27/2010	Vendor:	Mount Forest RONA	Amount:	\$520.91
	InvNo: INV 2277795		InvDesc: REC/MF 2 x STD Spruce 4x8x1/2'		InvAmt:	\$49.70	
	InvNo: INV 2276909		InvDesc: REC/MF White Field Chalk		InvAmt:	\$471.21	

Township of Wellington North  
 CHEQUE DISTRIBUTION REPORT  
 Payables Management

ChqNo:	044501	Date:	8/27/2010	Vendor:	Mt Forest Business Improvement	Amount:	\$7,500.00
	InvNo: 2010 3RD QTR PAYT.		InvDesc: A/R 2010 3rd Qtrr Payt		InvAmt:	\$7,500.00	
ChqNo:	044502	Date:	8/27/2010	Vendor:	Mt Forest Confederate	Amount:	\$3,214.94
	InvNo: INV 57557		InvDesc: BW/EDC/FIRE/ADM June/10ads		InvAmt:	\$3,214.94	
ChqNo:	044503	Date:	8/27/2010	Vendor:	Mt Forest Greenhouses	Amount:	\$107.74
	InvNo: INV 11136		InvDesc: REC/MF HydrangeaGerberaGrass		InvAmt:	\$107.74	
ChqNo:	044504	Date:	8/27/2010	Vendor:	Mildmay Creamery Ltd.	Amount:	\$90.00
	InvNo: INV 35903		InvDesc: REC/MF 75 bags ice		InvAmt:	\$90.00	
ChqNo:	044505	Date:	8/27/2010	Vendor:	Morrison Carolann	Amount:	\$88.00
	InvNo: PPTE STNDRDS MTG.		InvDesc: PI&C PrppteStndrdsCmmMtg		InvAmt:	\$88.00	
ChqNo:	044506	Date:	8/27/2010	Vendor:	Murphy's TIM-BR Mart	Amount:	\$81.36
	InvNo: INV 212492		InvDesc: REC/MF 6PlasticBarrels		InvAmt:	\$81.36	
ChqNo:	044507	Date:	8/27/2010	Vendor:	Maitland Valley Conservation	Amount:	\$6,635.25
	InvNo: 2010 3RD QTR LEVY		InvDesc: ConsAuth/3rdQtrtr2010Levy		InvAmt:	\$6,635.25	
ChqNo:	044508	Date:	8/27/2010	Vendor:	North Wellington Co-op Service	Amount:	\$527.54
	InvNo: INV 396062		InvDesc: FIRE/MF SaltCrystall II 20kg		InvAmt:	\$33.84	
	InvNo: INV 386106		InvDesc: REC/MF ChlorineBulk		InvAmt:	\$30.74	
	InvNo: INV 386840		InvDesc: REC/MF MuriaticAcid 4L		InvAmt:	\$47.41	
	InvNo: INV 382612		InvDesc: REC/MF ChlorineBulk		InvAmt:	\$82.99	
	InvNo: INV 382934		InvDesc: REC/MF ChlorineBulk		InvAmt:	\$121.57	
	InvNo: INV 384501		InvDesc: REC/MF ChlorineBulk		InvAmt:	\$210.99	
ChqNo:	044509	Date:	8/27/2010	Vendor:	PCO Services Inc.	Amount:	\$101.70
	InvNo: INV IN-2838813		InvDesc: REC/MF PestControl Aug4/2010		InvAmt:	\$101.70	
ChqNo:	044510	Date:	8/27/2010	Vendor:	Petty Cash (General) - c/o MJ Marshall	Amount:	\$130.85
	InvNo: AUGF2010 RECONCILE		InvDesc: ADM/REC Aug2010Reconcltn		InvAmt:	\$130.85	
ChqNo:	044511	Date:	8/27/2010	Vendor:	Purolator Courier Ltd	Amount:	\$31.06
	InvNo: INV 3833754 9		InvDesc: FIRE/MF courier to GeorgianFir		InvAmt:	\$11.97	
	InvNo: INV 3843719 0		InvDesc: EDC Courier to CMT media group		InvAmt:	\$19.09	
ChqNo:	044512	Date:	8/27/2010	Vendor:	Kayla Raftis	Amount:	\$70.00
	InvNo: MAY27/10 MILEAGE		InvDesc: REC/AV mileage/HanoverWorkshop		InvAmt:	\$70.00	
ChqNo:	044513	Date:	8/27/2010	Vendor:	REEVES, SCOTT	Amount:	\$1,900.00
	InvNo: ENTRNC RFND 10-0097		InvDesc: A/R EntranceRefundPrmt#10-0097		InvAmt:	\$1,900.00	
ChqNo:	044514	Date:	8/27/2010	Vendor:	RESQTECH Systems Inc	Amount:	\$1,288.20
	InvNo: INV 00010935		InvDesc: FIRE/AV PhosChekClassAFoam x12		InvAmt:	\$1,288.20	
ChqNo:	044515	Date:	8/27/2010	Vendor:	RICE, CALLEE	Amount:	\$142.50
	InvNo: JUNE-AUG/10MILEAGE		InvDesc: REC/MF June6-Aug20/10mileage		InvAmt:	\$142.50	
ChqNo:	044516	Date:	8/27/2010	Vendor:	Royal Bank Visa	Amount:	\$112.68
	InvNo: M.BROOMHEAD AUG/10		InvDesc: COU/July-Aug/10meals		InvAmt:	\$112.68	
ChqNo:	044517	Date:	8/27/2010	Vendor:	SAAM CUSTOM MACHINE	Amount:	\$489.86
	InvNo: INV 377		InvDesc: SS/AV RprValve/SSthreadedshft		InvAmt:	\$489.86	
ChqNo:	044518	Date:	8/27/2010	Vendor:	Saugeen Sales and Rentals	Amount:	\$50.85
	InvNo: INV 275		InvDesc: REC/MF 3"Gas5HP		InvAmt:	\$50.85	
ChqNo:	044519	Date:	8/27/2010	Vendor:	Schmidt Robert	Amount:	\$20.00
	InvNo: AUG17/10 MILEAGE		InvDesc: FIRE/AV Aug17/10mileage		InvAmt:	\$20.00	
ChqNo:	044520	Date:	8/27/2010	Vendor:	SHARPE, BRYAN	Amount:	\$87.00
	InvNo: JULY30/10MILEAGE		InvDesc: FIRE/AV July30/10mileage		InvAmt:	\$87.00	
ChqNo:	044521	Date:	8/27/2010	Vendor:	Spahr Linda	Amount:	\$77.95
	InvNo: AUG/10 EXPENSE RPT		InvDesc: REC/Aug12/10mtg meal		InvAmt:	\$77.95	

Township of Wellington North  
 CHEQUE DISTRIBUTION REPORT  
 Payables Management

ChqNo:	044522	Date:	8/27/2010	Vendor:	Suncor Energy Inc.	Amount:	\$169.36
InvNo:	ROLL#13-128 TAX RFND	InvDesc:	A/R RefundTaxesR#13-12800	InvAmt:		\$169.36	
ChqNo:	044523	Date:	8/27/2010	Vendor:	Superior Tire Sales & Service	Amount:	\$89.95
InvNo:	INV 174538	InvDesc:	REC/MF TirePlugged	InvAmt:		\$18.77	
InvNo:	INV 174526	InvDesc:	REC/MF PassengerStemsShort	InvAmt:		\$71.18	
ChqNo:	044524	Date:	8/27/2010	Vendor:	Swan Dust Control	Amount:	\$162.94
InvNo:	INV S317587	InvDesc:	REC/MF July2010rental mats/mop	InvAmt:		\$162.94	
ChqNo:	044525	Date:	8/27/2010	Vendor:	TERPSTRA, KAREN	Amount:	\$165.00
InvNo:	REFUND #48970	InvDesc:	A/R-REC RefundPoolClosure	InvAmt:		\$165.00	
ChqNo:	044526	Date:	8/27/2010	Vendor:	Town of Orangeville	Amount:	\$508.50
InvNo:	INV OMAA-13	InvDesc:	ADM 2010 OMAAFallWorkshop	InvAmt:		\$508.50	
ChqNo:	044527	Date:	8/27/2010	Vendor:	Trommelen Bert	Amount:	\$85.50
InvNo:	PRPTE STNDRDS MTG	InvDesc:	PI&C PrpteStndrdsComMtgf	InvAmt:		\$85.50	
ChqNo:	044528	Date:	8/27/2010	Vendor:	Union Gas	Amount:	\$3,370.92
InvNo:	21672851976530 AUG10	InvDesc:	PROP/MF town office Aug16/10bi	InvAmt:		\$28.31	
InvNo:	22162812017982 AUG10	InvDesc:	FIRE/MF Hall Aug14/10bill	InvAmt:		\$26.04	
InvNo:	22161132017850 AUG10	InvDesc:	CEM/Egremont Aug14/10bill	InvAmt:		\$27.17	
InvNo:	22726972064551 AUG10	InvDesc:	REC/MF arena Aug17/10bill	InvAmt:		\$3,234.92	
InvNo:	22162822017983 AUG10	InvDesc:	BW/MF Shed Aug14/10bill	InvAmt:		\$21.47	
InvNo:	22730862630864 AUG10	InvDesc:	SS/MF CorkSt SwgStn Aug17/10bi	InvAmt:		\$33.01	
ChqNo:	044529	Date:	8/27/2010	Vendor:	Waste Management	Amount:	\$2,646.40
InvNo:	INV 111212560	InvDesc:	FIRE/AVhall July2010basic srvc	InvAmt:		\$111.92	
InvNo:	INV 111218302	InvDesc:	FIRE/MF hall July2010basic srv	InvAmt:		\$97.28	
InvNo:	INV 111218109	InvDesc:	REC/MF arena July/10basic srvc	InvAmt:		\$907.96	
InvNo:	INV 111214152	InvDesc:	BW/REC July31/10basic srvc	InvAmt:		\$1,529.24	
ChqNo:	044530	Date:	8/27/2010	Vendor:	Watson Tractors & Eq Inc	Amount:	\$1,638.01
InvNo:	INV R031230	InvDesc:	BW CleanExhaustScreen&Run/Lbr	InvAmt:		\$23.73	
InvNo:	INV 140808	InvDesc:	CEM FixCut	InvAmt:		\$35.49	
InvNo:	INV R031336	InvDesc:	CEM/InstallNewHydrostatPump	InvAmt:		\$1,578.79	
ChqNo:	044531	Date:	8/27/2010	Vendor:	Well Dufferin Guelph Health	Amount:	\$500.00
InvNo:	INV 2010-0033	InvDesc:	REC/MF&AV InMotionContribution	InvAmt:		\$500.00	
ChqNo:	044532	Date:	8/27/2010	Vendor:	Wellington North Power	Amount:	\$25,874.55
InvNo:	00100954-00 AUG2010	InvDesc:	PROP/V ElectronicSign@Firehall	InvAmt:		\$82.38	
InvNo:	00100915-00 AUG2010	InvDesc:	SL/MF Main&Sligo Aug19/10bill	InvAmt:		\$71.72	
InvNo:	00100771-00 AUG2010	InvDesc:	BW/MF shed Aug19/10bill	InvAmt:		\$242.35	
InvNo:	00043075-00 AUG2010	InvDesc:	SL/MF Queen&Main Aug19/10bill	InvAmt:		\$58.20	
InvNo:	00061050-00 AUG2010	InvDesc:	FIRE/MF hall Aug19/10bill	InvAmt:		\$363.70	
InvNo:	00070000-00 AUG2010	InvDesc:	SS/MF PerthStPumpStn Aug10bill	InvAmt:		\$49.33	
InvNo:	00070250-00 AUG2010	InvDesc:	SS/MF CorkStPumpStn Aug/10bill	InvAmt:		\$314.46	
InvNo:	00070300-00 AUG2010	InvDesc:	REC/MF CorkStBallDmdAug10bill	InvAmt:		\$543.87	
InvNo:	00100225-01 AUG2010	InvDesc:	PROP/MF OldDayCare Aug19/10bil	InvAmt:		\$50.13	
InvNo:	00100531-00 AUG2010	InvDesc:	SS/MF DurhamStPmpStnAug2010bil	InvAmt:		\$197.27	
InvNo:	00075075-02 AUG2010	InvDesc:	SS/MF CorkStSwg Aug19/10bill	InvAmt:		\$6,908.87	
InvNo:	00100927-01 AUG2010	InvDesc:	REC/MF Arena Aug19/10bill	InvAmt:		\$13,584.30	
InvNo:	00066250-02 AUG2010	InvDesc:	WW/MF PerthStWell#6 Aug2010bil	InvAmt:		\$990.68	
InvNo:	00075650-04 AUG2010	InvDesc:	SS/MF N.WaterStLift Aug19/10bi	InvAmt:		\$2,420.81	

Township of Wellington North  
 CHEQUE DISTRIBUTION REPORT  
 Payables Management

ChqNo:	044533	Date:	8/27/2010	Vendor:	Wightman Telecom Ltd.	Amount:	\$416.70
InvNo:	12058673	JULY2010	InvDesc:	REC/MF July2010TV&PhoneChrgs	InvAmt:	\$209.12	
InvNo:	12058673	AUG2010	InvDesc:	REC/MFArenaTV&TelephoneAug10	InvAmt:	\$207.58	
ChqNo:	044534	Date:	8/27/2010	Vendor:	YOUNG-O'DONNELL	Amount:	\$346.65
InvNo:	INV 258	InvDesc:	FIRE/AV Lbr/CablesProperPositn	InvAmt:	\$179.97		
InvNo:	INV 422	InvDesc:	FIRE/AV Lbr&3ButtonRemote	InvAmt:	\$166.68		
ChqNo:	044535	Date:	8/27/2010	Vendor:	Young's Home Hardware Bldg Centre	Amount:	\$229.05
InvNo:	INV 232973	InvDesc:	BW GarbageBags	InvAmt:	\$30.50		
InvNo:	INV 232498	InvDesc:	REC/MF BraidedTubingBoltBshngC	InvAmt:	\$58.61		
InvNo:	INV 233667	InvDesc:	REC/MF MountingTape	InvAmt:	\$22.58		
InvNo:	INV 232748	InvDesc:	REC/MF RustPaint	InvAmt:	\$38.41		
InvNo:	INV 229511	InvDesc:	WW FoamStyrosplanInsulation	InvAmt:	\$131.59		
ChqNo:	044536	Date:	8/27/2010	Vendor:	Dundee Private Investors Inc.	Amount:	\$460.08
InvNo:	11447238	MH AUG/10	InvDesc:	ADM-August Payroll Remttance	InvAmt:	\$460.08	
ChqNo:	044537	Date:	8/27/2010	Vendor:	Canadian Union of Public Employees	Amount:	\$892.47
InvNo:	LOCAL 255	AUG DUES	InvDesc:	ADM-August Payroll Remittance	InvAmt:	\$892.47	
ChqNo:	044538	Date:	8/27/2010	Vendor:	Ont Mun Employee Retirement	Amount:	\$19,526.68
InvNo:	389500	AUG/10	InvDesc:	ADM-August Payroll Remittance	InvAmt:	\$19,526.68	
ChqNo:	044539	Date:	8/27/2010	Vendor:	TD Canada Trust - G Lehman Trust	Amount:	\$455.80
InvNo:	38301151762	AUG/10	InvDesc:	ADM-August Payroll Remittance	InvAmt:	\$455.80	
ChqNo:	044540	Date:	8/27/2010	Vendor:	Workplace Safety & Ins Board	Amount:	\$4,113.28
InvNo:	AUG/10	ACCT#3107876	InvDesc:	ADM-August Payroll Remittance	InvAmt:	\$4,113.28	
ChqNo:	044542	Date:	9/02/2010	Vendor:	Agrisan SC Pharma	Amount:	\$1,233.23
InvNo:	INV 77095	InvDesc:	WW-Sodium Hypochlorite 12%	InvAmt:	\$1,233.23		
ChqNo:	044543	Date:	9/02/2010	Vendor:	Aquatech Logistics Inc.	Amount:	\$429.71
InvNo:	INV 217004	InvDesc:	REC-AV-Hypochlorite 12% + Acid	InvAmt:	\$429.71		
ChqNo:	044544	Date:	9/02/2010	Vendor:	Arthur Agricultural Society	Amount:	\$30.00
InvNo:	DISPLAY BOOTH	InvDesc:	EC DEV-Display Booth @ AV Fair	InvAmt:	\$30.00		
ChqNo:	044545	Date:	9/02/2010	Vendor:	Bell Canada - Public Access	Amount:	\$56.50
InvNo:	INV 101054	InvDesc:	REC-MF Arena Pay Phone	InvAmt:	\$56.50		
ChqNo:	044546	Date:	9/02/2010	Vendor:	Bell Canada Box 5400 & 9000	Amount:	\$1,566.97
InvNo:	519-323-1310	AUG/10	InvDesc:	WW-MF SCADA	InvAmt:	\$81.67	
InvNo:	519-323-1441	AUG/10	InvDesc:	FIRE-MF Firehall	InvAmt:	\$253.18	
InvNo:	519-323-1628	AUG/10	InvDesc:	FIRE-MF Community Room	InvAmt:	\$104.61	
InvNo:	519-323-1801	AUG/10	InvDesc:	REC-MF Arena	InvAmt:	\$173.83	
InvNo:	519-323-2553	AUG/10	InvDesc:	SS-Durham St Pumping Station	InvAmt:	\$84.37	
InvNo:	519-323-2641	AUG/10	InvDesc:	RDS-MF Works Yard	InvAmt:	\$120.53	
InvNo:	519-323-9386	AUG/10	InvDesc:	REC-MF Pool	InvAmt:	\$120.75	
InvNo:	519-848-3669	AUG/10	InvDesc:	SS-Wells St Pumping Station	InvAmt:	\$76.83	
InvNo:	519-848-5490	AUG/10	InvDesc:	SS-AV WPCP	InvAmt:	\$117.60	
InvNo:	519-848-5595	AUG/10	InvDesc:	SS/WW-AV WPCP	InvAmt:	\$433.60	
ChqNo:	044547	Date:	9/02/2010	Vendor:	Bell Mobility	Amount:	\$40.39
InvNo:	519-827-5013	AUG/10	InvDesc:	FIRE-AV Cell	InvAmt:	\$40.39	
ChqNo:	044548	Date:	9/02/2010	Vendor:	Kevin Bender	Amount:	\$102.50
InvNo:	AUG 25/10	HENSALL	InvDesc:	FIRE-MF Firefighter Mileage	InvAmt:	\$102.50	
ChqNo:	044549	Date:	9/02/2010	Vendor:	Benn, Jason	Amount:	\$912.00
InvNo:	AUG/10	PREVENTION	InvDesc:	FIRE-AV Fire Prevention Work	InvAmt:	\$912.00	
ChqNo:	044550	Date:	9/02/2010	Vendor:	B M Ross and Associates	Amount:	\$8,903.74
InvNo:	INV 3030	InvDesc:	A/R-Developer Costs	InvAmt:	\$4,817.65		

Township of Wellington North  
 CHEQUE DISTRIBUTION REPORT  
 Payables Management

InvNo: INV 3033      InvDesc: A/R-Developer Costs      InvAmt: \$436.07  
 InvNo: INV 3089      InvDesc: SS-Cork St Pump Stn Fees      InvAmt: \$3,650.02

ChqNo:	044551	Date:	9/02/2010	Vendor:	Chalmers Fuels Inc	Amount:	\$1,563.21
InvNo:	INV 375824	InvDesc:	WW-Diesel Fuel Dyed ULS	InvAmt:	\$205.30		
InvNo:	INV 376400	InvDesc:	RDS-ULS Diesel Fuel Clear	InvAmt:	\$1,357.91		
ChqNo:	044552	Date:	9/02/2010	Vendor:	Chris's Auto Body	Amount:	\$10,446.85
InvNo:	INV 932	InvDesc:	RDS-Body Work 04 Volvo #32	InvAmt:	\$10,446.85		
ChqNo:	044553	Date:	9/02/2010	Vendor:	Canadian Institute of Chartered Accountants	Amount:	\$91.46
InvNo:	INV 166680	InvDesc:	ADM-CICA Handbook PS Accountin	InvAmt:	\$91.46		
ChqNo:	044554	Date:	9/02/2010	Vendor:	CMT Engineering Inc.	Amount:	\$2,119.88
InvNo:	INV 12291	InvDesc:	RDS-Egremont St Reconstruction	InvAmt:	\$1,511.09		
InvNo:	INV 12290	InvDesc:	RDS-Normanby St Reconstruction	InvAmt:	\$608.79		
ChqNo:	044555	Date:	9/02/2010	Vendor:	County of Wellington	Amount:	\$3,780.00
InvNo:	INV 19979	InvDesc:	RDS-2009 & 2010 Tower Rental	InvAmt:	\$3,780.00		
ChqNo:	044556	Date:	9/02/2010	Vendor:	Drexler Construction Limited	Amount:	\$68,998.84
InvNo:	PYMT CERT NO 3	InvDesc:	REC-AV Arena Parking Lot	InvAmt:	\$68,998.84		
ChqNo:	044557	Date:	9/02/2010	Vendor:	D.T. Contracting	Amount:	\$8,650.42
InvNo:	INV 108603	InvDesc:	RDS-Air Compressor rental	InvAmt:	\$101.70		
InvNo:	INV 108605	InvDesc:	RDS/SS-Domville/Tucker Patchin	InvAmt:	\$2,840.25		
InvNo:	INV 108607	InvDesc:	RDS-Isabella/Charles/George/Ea	InvAmt:	\$5,708.47		
ChqNo:	044558	Date:	9/02/2010	Vendor:	Economic Developers Council of Ontario	Amount:	\$161.70
InvNo:	INV 2117	InvDesc:	EC DEV-Membership No. 62	InvAmt:	\$161.70		
ChqNo:	044559	Date:	9/02/2010	Vendor:	Elmira Farm Service (2000) Ltd.	Amount:	\$136.74
InvNo:	INV 441309	InvDesc:	RDS-JD Knife (50)	InvAmt:	\$120.34		
InvNo:	INV 441310	InvDesc:	RDS-JD Knife/Penetrant	InvAmt:	\$16.40		
ChqNo:	044560	Date:	9/02/2010	Vendor:	Emergency Services Training Centre	Amount:	\$395.50
InvNo:	INV 10-08-04	InvDesc:	FIRE-MF Ag Emererency Course	InvAmt:	\$146.90		
InvNo:	INV 10-08-18	InvDesc:	FIRE-MF Grain Entrapment Cours	InvAmt:	\$101.70		
InvNo:	INV 10-08-29	InvDesc:	FIRE-MF Bin Entry Rescue Cours	InvAmt:	\$146.90		
ChqNo:	044561	Date:	9/02/2010	Vendor:	Georgian Firegear Service	Amount:	\$129.16
InvNo:	INV SI-9823	InvDesc:	FIRE-AV Bunker Gear Maintenanc	InvAmt:	\$129.16		
ChqNo:	044562	Date:	9/02/2010	Vendor:	Ghent Willard	Amount:	\$91.00
InvNo:	AUG 1 & 3 MILEAGE	InvDesc:	FIRE-MF Firefighter Mileage	InvAmt:	\$91.00		
ChqNo:	044563	Date:	9/02/2010	Vendor:	Harper Power Products Inc.	Amount:	\$875.85
InvNo:	INV 7204156-00	InvDesc:	SS-MF N Water Pmp Stn Service	InvAmt:	\$875.85		
ChqNo:	044564	Date:	9/02/2010	Vendor:	Eric Henrickson	Amount:	\$50.00
InvNo:	REPUND 49351	InvDesc:	REC-MF Private Lesson Refund	InvAmt:	\$50.00		
ChqNo:	044565	Date:	9/02/2010	Vendor:	Hydromantis Inc.	Amount:	\$731.56
InvNo:	PYMT CERT NO 7	InvDesc:	SS-MF WWTP	InvAmt:	\$731.56		
ChqNo:	044566	Date:	9/02/2010	Vendor:	Hydro One Networks Inc.	Amount:	\$1,423.18
InvNo:	06622-88002 AUG/10	InvDesc:	WW-AV Wells 8A & 8B	InvAmt:	\$1,325.12		
InvNo:	28380-06092 AUG/10	InvDesc:	CEM-Egremont Cemetery	InvAmt:	\$41.00		
InvNo:	40730-09608 AUG/10	InvDesc:	REC-Conn Comm Park	InvAmt:	\$57.06		
ChqNo:	044567	Date:	9/02/2010	Vendor:	IRVINE, DON	Amount:	\$80.00
InvNo:	AUG 24/10 BLYTH	InvDesc:	FIRE-MF Firefighter Mileage	InvAmt:	\$80.00		
ChqNo:	044568	Date:	9/02/2010	Vendor:	Darren Jones	Amount:	\$497.00
InvNo:	AUGUST 2010 MILEAGE	InvDesc:	BLDG-August mileage	InvAmt:	\$497.00		
ChqNo:	044569	Date:	9/02/2010	Vendor:	KORE Mechanical Inc.	Amount:	\$1,351.33
InvNo:	INV 428	InvDesc:	REC-AV Compressors/brine/.....	InvAmt:	\$1,351.33		
ChqNo:	044570	Date:	9/02/2010	Vendor:	LaFarge Canada Inc.	Amount:	\$1,175.20

Township of Wellington North  
 CHEQUE DISTRIBUTION REPORT  
 Payables Management

InvNo:	INV 17466822	InvDesc:	RDS-Artevia Colour	InvAmt:	\$1,175.20		
ChqNo:	044571	Date:	9/02/2010	Vendor:	MacEachern Jim	Amount:	\$75.00
InvNo:	AUG 1/10 BLYTH	InvDesc:	FIRE-MF Firefighter Mileage	InvAmt:	\$75.00		
ChqNo:	044572	Date:	9/02/2010	Vendor:	MacEachern Contracting	Amount:	\$1,785.40
InvNo:	INV AUG 23, 2010	InvDesc:	RDS-150 King St E Costs	InvAmt:	\$1,785.40		
ChqNo:	044573	Date:	9/02/2010	Vendor:	MacEachern Ron	Amount:	\$108.00
InvNo:	AUG 4 & 10 MILEAGE	InvDesc:	FIRE-MF Firefighter Mileage	InvAmt:	\$108.00		
ChqNo:	044574	Date:	9/02/2010	Vendor:	Marcc Apparel Company	Amount:	\$542.40
InvNo:	INV 11519	InvDesc:	REC-T-Shirts	InvAmt:	\$542.40		
ChqNo:	044575	Date:	9/02/2010	Vendor:	Morrison Carolann	Amount:	\$240.04
InvNo:	AUG/10 EXPENSES	InvDesc:	REC-AV & MF Pool exp/mileage	InvAmt:	\$240.04		
ChqNo:	044576	Date:	9/02/2010	Vendor:	Curtis Murphy	Amount:	\$320.00
InvNo:	JULY 20, 21, 22, 23	InvDesc:	FIRE-MF Firefighter Mileage	InvAmt:	\$320.00		
ChqNo:	044577	Date:	9/02/2010	Vendor:	Ont Assoc of Fire Chiefs	Amount:	\$56.50
InvNo:	INV 45097	InvDesc:	FIRE-AV Standards	InvAmt:	\$56.50		
ChqNo:	044578	Date:	9/02/2010	Vendor:	PCO Services Inc.	Amount:	\$109.05
InvNo:	INV 2845955	InvDesc:	REC-AV Pest Control	InvAmt:	\$109.05		
ChqNo:	044579	Date:	9/02/2010	Vendor:	Reliance Home Comfort	Amount:	\$78.65
InvNo:	0021274722127177AUG	InvDesc:	REC-AV Arena Rental Equipment	InvAmt:	\$78.65		
ChqNo:	044580	Date:	9/02/2010	Vendor:	SAAM CUSTOM MACHINE	Amount:	\$257.64
InvNo:	INV 379	InvDesc:	SS-Fabricate New Valve Key	InvAmt:	\$257.64		
ChqNo:	044581	Date:	9/02/2010	Vendor:	SGS Canada Inc.	Amount:	\$1,854.33
InvNo:	INV 10445047	InvDesc:	WW-Analysis/Reporting	InvAmt:	\$757.10		
InvNo:	INV 10445048	InvDesc:	WW-Analysis/Reporting	InvAmt:	\$126.56		
InvNo:	INV 10445049	InvDesc:	WW-Analysis/Reporting	InvAmt:	\$970.67		
ChqNo:	044582	Date:	9/02/2010	Vendor:	Town of Minto	Amount:	\$565.00
InvNo:	RURAL DOWNTOWN	InvDesc:	EC DEV-5 Regist's RDR Summit	InvAmt:	\$565.00		
ChqNo:	044583	Date:	9/02/2010	Vendor:	Triton Engineering Services	Amount:	\$12,568.98
InvNo:	INV 040331	InvDesc:	SS/WW-Water/Sanitary Master Pl	InvAmt:	\$5,780.24		
InvNo:	INV 040337	InvDesc:	WW-Conestoga St W/M	InvAmt:	\$4,330.01		
InvNo:	INV 040338	InvDesc:	REC-AV Arena Elevator barrier	InvAmt:	\$1,832.51		
InvNo:	INV 040339	InvDesc:	REC-AV Arena Parking Lot	InvAmt:	\$626.22		
ChqNo:	044584	Date:	9/02/2010	Vendor:	Twp of Wellington North	Amount:	\$259.51
InvNo:	BP 2010-0133	InvDesc:	REC-AV Elevator permit	InvAmt:	\$259.51		
ChqNo:	044585	Date:	9/02/2010	Vendor:	Union Gas	Amount:	\$4,970.29
InvNo:	40588522114421AUG/10	InvDesc:	PROP-Former Daycare Centre	InvAmt:	\$29.84		
InvNo:	24818182642419AUG/10	InvDesc:	REC-MF Sportsplex	InvAmt:	\$2,010.39		
InvNo:	24816442242865AUG/10	InvDesc:	RDS-AV Works Yard	InvAmt:	\$38.76		
InvNo:	24816492242870AUG/10	InvDesc:	REC-AV Arena	InvAmt:	\$265.85		
InvNo:	24816922242907AUG/10	InvDesc:	PROP-AV Seniors Hall	InvAmt:	\$21.87		
InvNo:	24817592477383AUG/10	InvDesc:	FIRE-AV Firehall	InvAmt:	\$28.30		
InvNo:	24817592624272AUG/10	InvDesc:	SS-160 Preston St S	InvAmt:	\$21.47		
InvNo:	24818182569153AUG/10	InvDesc:	REC-AV Pool	InvAmt:	\$2,553.81		
ChqNo:	044586	Date:	9/02/2010	Vendor:	Viking Cives Ltd	Amount:	\$9,040.00
InvNo:	INV 2622703	InvDesc:	RDS-Eliminator Ass'y 11 Ft	InvAmt:	\$9,040.00		
ChqNo:	044587	Date:	9/02/2010	Vendor:	Walsh's Pharmacy	Amount:	\$9.81
InvNo:	FEBREEZE/LYSOL	InvDesc:	REC-AV Pool	InvAmt:	\$9.81		
ChqNo:	044588	Date:	9/02/2010	Vendor:	Wellington North Power	Amount:	\$6,631.30
InvNo:	00047801-00 AUG/10	InvDesc:	ADM-MF Lawn Bowling	InvAmt:	\$49.04		

Township of Wellington North  
 CHEQUE DISTRIBUTION REPORT  
 Payables Management

InvNo:	00033050-00	AUG/10	InvDesc:	PROP-MF Town Office	InvAmt:	\$978.52
InvNo:	00033075-01	AUG/10	InvDesc:	ST LTS-Red light Main/Well &SI	InvAmt:	\$402.97
InvNo:	00054900-00	AUG/10	InvDesc:	WW-Well 3 Parkside Drive	InvAmt:	\$674.08
InvNo:	00012700-01	AUG/10	InvDesc:	WW-Well 5 125 Sligo Rd E	InvAmt:	\$1,417.19
InvNo:	00059550-00	AUG/10	InvDesc:	REC-MF Murphy St Park	InvAmt:	\$69.44
InvNo:	00065100-00	AUG/10	InvDesc:	REC-Wellington St E Ball Diamc	InvAmt:	\$195.42
InvNo:	00065300-00	AUG/10	InvDesc:	REC-King St E Ball Diamond	InvAmt:	\$84.57
InvNo:	00054750-00	AUG/10	InvDesc:	REC-MF Pool	InvAmt:	\$2,641.25
InvNo:	00054800-00	AUG/10	InvDesc:	REC-MF Parkside Dr Park/Pool	InvAmt:	\$85.96
InvNo:	00012375-00	AUG/10	InvDesc:	REC-MF King St E Pole (Fair)	InvAmt:	\$32.86

ChqNo:	044589	Date:	9/02/2010	Vendor:	Wellington North Tire	Amount:	\$242.14
InvNo:	INV 96022	InvDesc:	RDS-Repair Flats....	InvAmt:	\$242.14		
ChqNo:	044590	Date:	9/02/2010	Vendor:	WRIGHT, PATTY	Amount:	\$445.50
InvNo:	AUG/10 MILEAGE	InvDesc:	BLDG-August Mileage	InvAmt:	\$445.50		
ChqNo:	044591	Date:	9/02/2010	Vendor:	W. Schwindt & Sons Bldg Const.	Amount:	\$44,070.00
InvNo:	INV 2812	InvDesc:	REC-Cork St Pavilion Addition	InvAmt:	\$44,070.00		
ChqNo:	044592	Date:	9/09/2010	Vendor:	Arthur Chrysler Plymouth Limit	Amount:	\$356.18
InvNo:	INV CCCS128968	InvDesc:	WW/SS DriveshaftRplcmnt	InvAmt:	\$356.18		
ChqNo:	044593	Date:	9/09/2010	Vendor:	B M Ross and Associates	Amount:	\$2,022.49
InvNo:	INV 3092	InvDesc:	SS/MFDurhamStAdmin/toAug1/10	InvAmt:	\$2,022.49		
ChqNo:	044594	Date:	9/09/2010	Vendor:	Cedar Signs	Amount:	\$282.49
InvNo:	INV 19122	InvDesc:	BW SteelNoParkingSigns x8	InvAmt:	\$282.49		
ChqNo:	044595	Date:	9/09/2010	Vendor:	Chalmers Fuels Inc	Amount:	\$3,636.63
InvNo:	INV 376596	InvDesc:	BW DieselFuelClear	InvAmt:	\$2,724.52		
InvNo:	INV 375923	InvDesc:	BW DieselFuelDyed	InvAmt:	\$912.11		
ChqNo:	044596	Date:	9/09/2010	Vendor:	Conestogo Agri Systems Inc.	Amount:	\$998.36
InvNo:	INV 269286	InvDesc:	WW SodiumSilicate	InvAmt:	\$998.36		
ChqNo:	044597	Date:	9/09/2010	Vendor:	Conseil scolaire district 64	Amount:	\$2,494.75
InvNo:	2010 3RD QRTR LEVY	InvDesc:	A/R 2010 3rd Qtr Levy	InvAmt:	\$2,494.75		
ChqNo:	044598	Date:	9/09/2010	Vendor:	County of Wellington	Amount:	\$1,736,549.61
InvNo:	INV 20018	InvDesc:	A/R 2010 3rdQrtrLevy&PIL&HBs	InvAmt:	1,736,549.61		
ChqNo:	044599	Date:	9/09/2010	Vendor:	Dewar Services	Amount:	\$218.54
InvNo:	INV 9999	InvDesc:	WW Lbr/Run3EthernetDrops	InvAmt:	\$218.54		
ChqNo:	044600	Date:	9/09/2010	Vendor:	D.T. Contracting	Amount:	\$565.00
InvNo:	INV 108609	InvDesc:	SS/AV PatchRprPaving/DukeSt	InvAmt:	\$565.00		
ChqNo:	044601	Date:	9/09/2010	Vendor:	Federal Express Canada Ltd.	Amount:	\$153.89
InvNo:	INV 5-797-17189	InvDesc:	A/R C.HarttPersonalCourierChrg	InvAmt:	\$153.89		
ChqNo:	044602	Date:	9/09/2010	Vendor:	Frey Communications	Amount:	\$135.20
InvNo:	INV 4976	InvDesc:	BW CleaningCartridge&Toner	InvAmt:	\$135.20		
ChqNo:	044603	Date:	9/09/2010	Vendor:	Go Glass & Accessories	Amount:	\$322.05
InvNo:	INV BR-116-103796	InvDesc:	WW/SS RplcWindshield	InvAmt:	\$322.05		
ChqNo:	044604	Date:	9/09/2010	Vendor:	Gord Davenport Automotive Inc	Amount:	\$125.65
InvNo:	INV 14415-24373	InvDesc:	BW 2 amber bulbs	InvAmt:	\$7.39		
InvNo:	INV 14415-24395	InvDesc:	BW CircuitTester	InvAmt:	\$38.56		
InvNo:	INV 14415-24517	InvDesc:	BW PprTwls&ToiletTissue	InvAmt:	\$79.70		
ChqNo:	044605	Date:	9/09/2010	Vendor:	H Bye Construction Limited	Amount:	\$41,153.95
InvNo:	INV 13889	InvDesc:	BW GravelHauled	InvAmt:	\$41,153.95		
ChqNo:	044606	Date:	9/09/2010	Vendor:	JENSEN, OLE	Amount:	\$1,900.00
InvNo:	ENTRNC E RFND/10-0063	InvDesc:	A/R EntranceRefundPrmt#10-0063	InvAmt:	\$1,900.00		

Township of Wellington North  
 CHEQUE DISTRIBUTION REPORT  
 Payables Management

ChqNo:	Date:	Vendor:	Amount:
044607	9/09/2010	J J McLellan & Son	\$219.60
InvNo: INV I014121	InvDesc: WW/GardenHoseBckflwPrvntr	InvAmt: \$5.60	
InvNo: INV I014180	InvDesc: WW/MiconSedimentCartridges	InvAmt: \$61.02	
InvNo: INV I014218	InvDesc: WW HighOutputUVrplcmnt lamp	InvAmt: \$144.28	
InvNo: INV I014219	InvDesc: SS 4"CSA vinyl sewer MIP Plug	InvAmt: \$8.70	
044608	9/09/2010	John Meunier	\$8,262.56
InvNo: INV 92734	InvDesc: WW AMITridesAnalyzer	InvAmt: \$8,262.56	
044609	9/09/2010	K Smart Associates Limited	\$45,200.00
InvNo: INV 21473	InvDesc: MunDrain FurmanekReportPrep	InvAmt: \$45,200.00	
044610	9/09/2010	Le Conseil scolaire de dist	\$1,898.75
InvNo: 2010 3RD QTR LEVY	InvDesc: A/R 2010 3rdQtrLevy	InvAmt: \$1,898.75	
044611	9/09/2010	Lifesaving Society	\$168.38
InvNo: INV M074326	InvDesc: REC/AV&MF CdnLfsvngManuals	InvAmt: \$168.38	
044612	9/09/2010	Long's Home Hardware	\$155.43
InvNo: INV 2230431	InvDesc: SS/SumpPumpClamp&Valve	InvAmt: \$139.30	
InvNo: INV 2230814	InvDesc: WW CarpetCleanerIronOut&ShpTwl	InvAmt: \$16.13	
044613	9/09/2010	Mechanical Advertising Inc.	\$2,997.36
InvNo: INV 901063	InvDesc: BW U-FlangeHDPst5'&8"x100	InvAmt: \$2,997.36	
044614	9/09/2010	Mount Forest Motors	\$45.20
InvNo: INV 2596	InvDesc: BW InstallPlug/Taillights	InvAmt: \$45.20	
044615	9/09/2010	Mount Forest RONA	\$149.81
InvNo: INV 2278231	InvDesc: REC/MF 2x4x8'spruce kiln dired	InvAmt: \$49.72	
InvNo: INV 2277993	InvDesc: WW SCR-M-Purp.TP#8	InvAmt: \$3.51	
InvNo: INV 2278666	InvDesc: REC/MF 4x8x1/2" StandFir	InvAmt: \$49.16	
InvNo: INV 2278226	InvDesc: REC/MF 2"ArdoxNails&CncrtSrws	InvAmt: \$20.09	
InvNo: INV 2278234	InvDesc: REC/MF CncrtScrws	InvAmt: \$27.33	
044616	9/09/2010	Morrison Jim	\$187.00
InvNo: AUG2010 MILEAGE&EXP	InvDesc: FIRE/AV Aug2010Mileage&TimHort	InvAmt: \$187.00	
044617	9/09/2010	North Wellington Co-op Service	\$33.84
InvNo: INV 386062	InvDesc: FIRE/MF SaltCrystal 20kg x5	InvAmt: \$33.84	
044618	9/09/2010	Ont Municipal Mgmt Institute	\$89.00
InvNo: INV 210191	InvDesc: FIRE/AV CMM Membership	InvAmt: \$89.00	
044619	9/09/2010	Oxby Excavating	\$7,638.80
InvNo: INV 338	InvDesc: BW Sideroad2Ditching	InvAmt: \$7,638.80	
044620	9/09/2010	PETRO-CANADA	\$3,996.99
InvNo: 993 918 446 2 AUG201	InvDesc: FIRE/MF Aug2010 fuel	InvAmt: \$171.94	
InvNo: 993 981 446 4 AUG201	InvDesc: BW/MF&AT Aug2010fuel	InvAmt: \$771.66	
InvNo: 993 981 434 0 AUG/10	InvDesc: WW/SS Aug2010fuel	InvAmt: \$1,039.89	
InvNo: 993 982 422 4 AUG/10	InvDesc: REC/MF Aug2010fuel	InvAmt: \$371.96	
InvNo: 993 981 434 AUG/10	InvDesc: WW/SS Aug2010fuel	InvAmt: \$456.17	
InvNo: 993 242 440 2 AUG/10	InvDesc: BW/AV-AT&WL Aug2010fuel	InvAmt: \$743.39	
InvNo: 993 979 428 6 AUG/10	InvDesc: FIRE/AV Aug2010fuel	InvAmt: \$253.18	
InvNo: 993 981 452 2 AUG/10	InvDesc: REC/AV Aug2010fuel	InvAmt: \$121.11	
InvNo: 993 981 422 5 AUG/10	InvDesc: BW/WW/SSAug2010stmnt int	InvAmt: \$67.69	
044621	9/09/2010	Purolator Courier Ltd	\$11.97
InvNo: INV 3853928 4	InvDesc: BW courier from Strongco	InvAmt: \$11.97	
044622	9/09/2010	R. J. Burnside & Assoc. Ltd.	\$3,743.43
InvNo: INV M10430000.2010-1	InvDesc: WW/AnnualMntrngWellToJune30/10	InvAmt: \$663.57	



**Township of Wellington North**  
**CHEQUE DISTRIBUTION REPORT**  
**Payables Management**

InvNo: INV MSA018454.000-1    InvDesc: WW/MF PTTWmonitoringToJn30/10    InvAmt: \$3,079.86

ChqNo:	044623	Date:	9/09/2010	Vendor:	Royal Bank Visa	Amount:	\$269.60
--------	--------	-------	-----------	---------	-----------------	---------	----------

InvNo: L.HEINBUCH AUG2010    InvDesc: EDC/ADM DomainRnwl&SwgCodeGd    InvAmt: \$269.60

ChqNo:	044624	Date:	9/09/2010	Vendor:	Royal City Fastener & Industrial Supply	Amount:	\$503.17
--------	--------	-------	-----------	---------	-----------------------------------------	---------	----------

InvNo: INV 13695    InvDesc: BW 28"TrafficCones/HookBinders    InvAmt: \$503.17

ChqNo:	044625	Date:	9/09/2010	Vendor:	RSQMAN Accountability	Amount:	\$2,922.18
--------	--------	-------	-----------	---------	-----------------------	---------	------------

InvNo: INV 259    InvDesc: FIRE/AV AccountabilityPackage    InvAmt: \$2,922.18

ChqNo:	044626	Date:	9/09/2010	Vendor:	SGS Canada Inc.	Amount:	\$232.78
--------	--------	-------	-----------	---------	-----------------	---------	----------

InvNo: INV 10445816    InvDesc: WW/AV&MF Aug9/10Anlyss&Rprtng    InvAmt: \$232.78

ChqNo:	044627	Date:	9/09/2010	Vendor:	Spahr Linda	Amount:	\$214.00
--------	--------	-------	-----------	---------	-------------	---------	----------

InvNo: AUG2010 MILEAGE    InvDesc: REC/MF&AV Aug2010mileage    InvAmt: \$214.00

ChqNo:	044628	Date:	9/09/2010	Vendor:	Stacey Electric Company Limited	Amount:	\$16,239.83
--------	--------	-------	-----------	---------	---------------------------------	---------	-------------

InvNo: PAYT.CERT.#4/ARTHUR    InvDesc: BW/AV TrafficSignalsPaytCert#4    InvAmt: \$16,239.83

ChqNo:	044629	Date:	9/09/2010	Vendor:	Triton Engineering Services	Amount:	\$2,757.25
--------	--------	-------	-----------	---------	-----------------------------	---------	------------

InvNo: INV 040367    InvDesc: SS/MF WPCP Qual.MonitorJuly/10    InvAmt: \$818.56

InvNo: INV 040366    InvDesc: SS/MF WWTPConstn/July2010    InvAmt: \$373.61

InvNo: INV 040365    InvDesc: SS/AV STPmoeCofAAmndmntJuly10    InvAmt: \$822.03

InvNo: INV 040364    InvDesc: SS/AV WTPRiverMonitoringJuly10    InvAmt: \$743.05

ChqNo:	044630	Date:	9/09/2010	Vendor:	Upper Grand Dist School Board	Amount:	\$711,949.50
--------	--------	-------	-----------	---------	-------------------------------	---------	--------------

InvNo: 2010 3RD QRTR LEVY    InvDesc: A/R 2010 3rdQrtrLevy    InvAmt: \$711,949.50

ChqNo:	044631	Date:	9/09/2010	Vendor:	Wallace Ian	Amount:	\$910.00
--------	--------	-------	-----------	---------	-------------	---------	----------

InvNo: AUG2010 PREVENTION    InvDesc: FIRE/MF Aug2010Prevention    InvAmt: \$910.00

ChqNo:	044632	Date:	9/09/2010	Vendor:	Watson Tractors & Eq Inc	Amount:	\$22.60
--------	--------	-------	-----------	---------	--------------------------	---------	---------

InvNo: INV 141486    InvDesc: BW Chain    InvAmt: \$22.60

ChqNo:	044633	Date:	9/09/2010	Vendor:	Wellington Catholic Dist Sch B	Amount:	\$157,296.25
--------	--------	-------	-----------	---------	--------------------------------	---------	--------------

InvNo: 2010 3RD QRTR LEVY    InvDesc: A/R 2010 3rd Qrtr Levy    InvAmt: \$157,296.25

ChqNo:	044634	Date:	9/09/2010	Vendor:	Young's Home Hardware Bldg Centre	Amount:	\$10.15
--------	--------	-------	-----------	---------	-----------------------------------	---------	---------

InvNo: INV 231756    InvDesc: WW MeasuringCups/ServingBottle    InvAmt: \$10.15

\*\*\* End of Report \*\*\*

**Report Total:**

**\$4,055,991.10**

# REPORT OF LIVESTOCK VALUER

46 km

Report to be completed in full, giving particulars of evidence observed.  
 Please print legibly. OMAFRA will not reimburse for incomplete reports.

**COPY**

"livestock" means cattle, fur-bearing animals, goats, horses, rabbits, sheep or swine.  
 "poultry" includes game birds where the game birds are kept pursuant to a licence under the Fish and Wildlife Conservation Act, 1997.

I, G. Flewelling Valuer of  
 livestock and poultry do hereby report that on or about the 13<sup>th</sup> day of July 2010  
 the following damages to livestock occurred as set out below.

**OWNER INFORMATION**

Name of Owner of Livestock/Poultry <u>John Manion</u>	
Mailing Address <u>R. R. # 1 Conn</u>	Postal Code <u>NOGINO</u>
Location (include Lot, Concession, Municipality) <u>Lot 12 Con. 14 Hellington N.</u>	911 gate # <u>9570</u>
Telephone # <u>(519) 321-9233</u>	Farm Business Registration #

**FINDINGS - INJURY / KILL - BOX 1**

Time: 3-4 a.m. / p.m. Comments: Surv. July 11/10  
 Description of livestock / poultry damaged - check appropriate findings.

<input checked="" type="checkbox"/> Throat / neck injuries or wounds	<input checked="" type="checkbox"/> Head / neck / jaw / spine broken or damaged
<input type="checkbox"/> Legs under animal or animal in upright position	<input type="checkbox"/> Lying in unnatural position or posture
<input checked="" type="checkbox"/> Puncture wounds with bruising	<input type="checkbox"/> Carcass dragged away from kill area
<input type="checkbox"/> Signs of struggle	<input checked="" type="checkbox"/> Bites on hind legs
<input type="checkbox"/> Evidence animal was sick / starving / diseased	<input type="checkbox"/> Blood trails in area
<input type="checkbox"/> Poisonous plants / limited pasture	<input type="checkbox"/> Evidence of birth within past 72 hours
<input type="checkbox"/> Other (explain) .....	<input type="checkbox"/> Other (explain) .....

Comments:

I have found evidence, to the best of my knowledge and belief, that shows the livestock/poultry in question has been killed or injured by a predator. [Proceed to complete remaining boxes.]

**OR**

There was insufficient evidence to make a finding due to deterioration or lack of carcass remains

Died of natural cause, sickness or disease

Scavenged only - did not die from predation

[Proceed to Box 6]

**IDENTIFICATION OF PREDATOR - BOX 2**

<input checked="" type="checkbox"/> Hindquarters / sides bitten or chewed	<input checked="" type="checkbox"/> Internal organs / ribs / fatty tissue eaten
<input type="checkbox"/> Wool scattered, carcass ripped apart	<input type="checkbox"/> Multiple carcasses
<input type="checkbox"/> Very little of carcass eaten	<input checked="" type="checkbox"/> Claw marks on flanks, shoulders
<input type="checkbox"/> Tracks present - type: .....	<input type="checkbox"/> Hide mostly in one piece - not ripped into pieces
<input type="checkbox"/> Predator stools - type, size, colour, content (specify): .....	<input type="checkbox"/> Other findings (specify) .....

I have found evidence, to the best of my knowledge and belief, that shows the:

predator responsible for the damage was a (circle one): Coyote      Wolf      Dog

damage was caused by dog owned or habitually kept on premises of owner of livestock and/or poultry.

**PHOTOGRAPHS - BOX 3**

Attach photographs (3 - 6) of injured or killed livestock or poultry to indicate attack site, wounds and other pertinent evidence.

**REASONABLE CARE - BOX 4**

**RISK ASSESSMENT - Check applicable item**

1. Current regional predation risk is:  High  Moderate  Low
  2. Regional incidence of predation is:  Increasing  Stable  Decreasing
  - Comments: *Owner saw 5 coyotes at the hell in the middle of the day*
  3. Predation on this farm is:  1st incident  1 claim / year  2 claims / year  >2 claims / year
  4. Previous predation history. Dates: *Apr June*
- Describe actions **taken** by producer to decrease likelihood of predation since last claim
- Improved fencing  Obtained guard animal  
 Penning livestock at night  Lighting yards  
 Birthing in protected area  Smell or noise deterrents  
 Other: .....
5. Trapping / hunting
- Are predators being hunted / trapped on farm  Yes (Date last caught) ..... No
- Are there preventive hunting / trapping (e.g. spring) activities on farm  Yes  No

**FARM MANAGEMENT - Check applicable item**

1. Herd / Flock size: *16*
2. Run as one herd / flock:  YES  NO
3. Livestock are:  Healthy  Diseased  Sick
4. Location of kill / injury:
  - Barnyard  YES  NO
  - Pasture - near buildings  YES  NO
  - Pasture - distant  YES  NO
  - Terrain of site:  Open pasture  Scrub bush  Wooded  Swamp nearby  Hilly
5. Stock inspected daily:  YES  NO (How often / by whom) .....
6. Stock running at large (on unenclosed land / highway):  YES  NO
7. Stock confined at night:  YES  NO (If no, where) small pasture / barnyard / other: *pasture*
8. Fencing:
 

<u>Individual Pasture</u>	<u>Perimeter Fence</u>
Acreage: <i>24</i>	.....
Maintenance (circle one): <u>Good</u> Fair / Poor	<u>Good</u> Fair / Poor
9. Guard animal:  Dog - breed .....  Donkey  Llama
10. Noise / smell repellents, etc. deterrents used (specify): .....
11. Other preventive measures used (specify): .....
12. Waste disposal method
  - Collected  YES  NO
  - Buried  YES (how deep) *4 ft*  NO
  - Composted  YES  NO
  - Other (specify) .....
  - Afterbirth disposed  YES  NO
13. Owner will implement the following to reduce further predation:
  - Improve fencing - repair / block entry points / addition of electric strands
  - Protect newborns - special penning / predator proof nursery / birthing area
  - Add guard animals or other deterrents
  - Light yards / night penning
  - Husbandry changes (specify) .....
  - Predator removal (specify what, when, how often) .....
  - Other (specify) .....

I have found that the owner:

- had taken** reasonable measures to prevent predation
- had not taken** reasonable measures to prevent predation

**VALUATION - BOX 5**

REFER TO LIVESTOCK / POULTRY CATEGORIES AND CURRENT MARKET VALUES INFORMATION BELOW

1. Producer has livestock insurance YES NO  
 2. Insurance policy reviewed by valuer YES NO

I value the said livestock and / or poultry, having due regard to the maximum amounts of compensation as set out in the regulations passed under the *Livestock, Poultry and Honey Bee Protection Act* (or by a by-law of this municipality), and hereby award the following compensation:

Species*	Live weight (lb or kg)	Market Price (lb or kg)	Add'l value over market**	Compensation Awarded
Charolais calf	130	N/A		
approx.	value of calf at	500 x 75%	=	\$ 525. -
TOTAL COMPENSATION:				\$ 525. -

\* Indicate newborn (N) if less than one-month old.

\*\*For bred, purebred or high quality animals, animals must have physical identification, such as an ear tag or tattoo, that corresponds to written records. Copies of records, supporting the additional award, must be attached to this report.

**VALUER AFFIDAVIT - BOX 6**

To the best of my belief and knowledge, the findings in this report are complete and accurate

G. Flewelling  
 Signature of valuer

519-323-9953  
 Telephone number

evening  
 Best time to telephone

July 13/10  
 Date

**LIVESTOCK/POULTRY CATEGORIES AND CURRENT MARKET VALUES**

Please use exact wording under "TERM TO USE" when completing Report of Livestock Valuer form

1. Categories			SPECIES	TERM TO USE	DEFINITIONS
<b>SPECIES</b>	<b>TERM TO USE</b>	<b>DEFINITIONS</b>	Rabbits	Rabbit	all ages and sexes Note: Minimum \$20, not to exceed \$1000 per year per owner
Cattle	<b>Calf</b>	0-6 months	Sheep	<b>Lamb</b>	0-6 months
	<b>Steer / Heifer</b>	6-24 months		<b>Yearling</b>	6-18 months
	<b>Cow</b>	>24 months - includes heifers > 24 months		<b>Ewe</b>	> 18 months
	<b>Bull</b>	>24 months - includes steers > 24 months	Swine	<b>Ram</b>	> 18 months
Goats	<b>Goat</b>	all ages and sexes		<b>Swine</b>	Includes all ages and sexes
Horses	<b>Foal</b>	< 6 months	2. <b>Current Market Values - Information Sources</b>		
	<b>Horse</b>	all ages > 6 months	Ontario Farmer magazine - Market News Page		
Poultry	<b>Chicken</b>	all types, report total weight	Ontario Livestock Exchange		
	<b>Duck</b>	all types, report total weight	Market Information Line		
	<b>Goose</b>	all types, report total weight	Ontario Cattlemen's Association 519-824-9161		
	<b>Turkey</b>	all types, report total weight	Ontario Sheep Marketing Agency 519-836-0043		
Note: Ratites (emu, ostrich, rhea), swans are not covered under the Act. Claims must be 25 kg or 55 lb. minimum, not to exceed \$1000 per year per owner.			3. <b>Guard Animals</b>		
			Guard dogs are generally not herding or hunting dogs nor house pets. Guard dogs remain with the livestock and are bonded to the animals. Generally they are specific breeds that have been bred for this purpose. For example: Grand Pyrenees, Komondor. Include breed when reporting a guard dog. Please do not record pets, herd or hunting dogs unless they truly are used in a guarding capacity.		

# REPORT OF LIVESTOCK VALUER

45 km.

Report to be completed in full, giving particulars of evidence observed.  
 Please print legibly. OMAFRA will not reimburse for incomplete reports.

**COPY**

"livestock" means cattle, fur-bearing animals, goats, horses, rabbits, sheep or swine.  
 "poultry" includes game birds where the game birds are kept pursuant to a licence under the Fish and Wildlife Conservation Act, 1997.

I, G. Flewelling Valuer of  
 livestock and poultry do hereby report that on or about the 21<sup>st</sup> day of June 2010  
 the following damages to livestock occurred as set out below.

OWNER INFORMATION	
Name of Owner of Livestock/Poultry <u>John Marion</u>	
Mailing Address <u>R. R. #1 Conn.</u>	Postal Code <u>N0G 1N0</u>
Location (include Lot, Concession, Municipality) <u>Lot 12 Concession 104 Wellington N.</u>	911 gate # <u>9570</u>
Telephone # <u>(519) 321-9233</u>	Farm Business Registration #

FINDINGS - INJURY / KILL - BOX 1	
Time: <u>6-7</u> a.m. / <del>p.m.</del>	Comments: .....
Description of livestock / poultry damaged - check appropriate findings.	
<input checked="" type="checkbox"/> Throat / neck injuries or wounds <input type="checkbox"/> Legs under animal or animal in upright position <input checked="" type="checkbox"/> Puncture wounds with bruising <input checked="" type="checkbox"/> Signs of struggle <input type="checkbox"/> Evidence animal was sick / starving / diseased <input type="checkbox"/> Poisonous plants / limited pasture <input type="checkbox"/> Other (explain) .....	<input type="checkbox"/> Head / neck / jaw / spine broken or damaged <input checked="" type="checkbox"/> Lying in unnatural position or posture <input checked="" type="checkbox"/> Carcass dragged away from kill area <input type="checkbox"/> Bites on hind legs <input type="checkbox"/> Blood trails in area <input type="checkbox"/> Evidence of birth within past 72 hours <input type="checkbox"/> Other (explain) .....
Comments: .....	
<input checked="" type="checkbox"/> I have found evidence, to the best of my knowledge and belief, that shows the livestock/poultry in question has been killed or injured by a predator. <b>[Proceed to complete remaining boxes.]</b> OR <input type="checkbox"/> There was insufficient evidence to make a finding due to deterioration or lack of carcass remains <input type="checkbox"/> Died of natural cause, sickness or disease <input type="checkbox"/> Scavenged only - did not die from predation	
<b>[Proceed to Box 6]</b>	

IDENTIFICATION OF PREDATOR - BOX 2	
<input type="checkbox"/> Hindquarters / sides bitten or chewed <input type="checkbox"/> Wool scattered, carcass ripped apart <input checked="" type="checkbox"/> Very little of carcass eaten <input type="checkbox"/> Tracks present - type: ..... <input type="checkbox"/> Predator stools - type, size, colour, content (specify): .....	<input checked="" type="checkbox"/> Internal organs / ribs / fatty tissue eaten <input type="checkbox"/> Multiple carcasses <input checked="" type="checkbox"/> Claw marks on flanks, shoulders <input checked="" type="checkbox"/> Hide mostly in one piece - not ripped into pieces <input type="checkbox"/> Other findings (specify) .....
I have found evidence, to the best of my knowledge and belief, that shows the: <input checked="" type="checkbox"/> predator responsible for the damage was a (circle one): <u>coyote</u> Wolf      Dog <input type="checkbox"/> damage was caused by dog owned or habitually kept on premises of owner of livestock and/or poultry.	

PHOTOGRAPHS - BOX 3
Attach photographs (3 - 6) of injured or killed livestock or poultry to indicate attack site, wounds and other pertinent evidence.

**REASONABLE CARE - BOX 4**

**RISK ASSESSMENT - Check applicable item**

1. Current regional predation risk is:  High  Moderate  Low
  2. Regional incidence of predation is:  Increasing  Stable  Decreasing
- Comments: .....
3. Predation on this farm is:  1st incident  1 claim / year  2 claims / year  >2 claims / year
  4. Previous predation history. Dates: ..... *Apr* .....
- Describe actions **taken** by producer to decrease likelihood of predation since last claim
- Improved fencing  Obtained guard animal  
 Penning livestock at night  Lighting yards  
 Birthing in protected area  Smell or noise deterrents  
 Other: .....
5. Trapping / hunting  
 Are predators being hunted / trapped on farm  Yes (Date last caught) ..... No   
 Are there preventive hunting / trapping (e.g. spring) activities on farm  Yes  No

**FARM MANAGEMENT - Check applicable item**

1. Herd / Flock size: ..... *17 cows* .....
2. Run as one herd / flock:  YES  NO
3. Livestock are:  Healthy  Diseased  Sick
4. Location of kill / injury:  
 Barnyard  YES  NO  
 Pasture - near buildings  YES  NO  
 Pasture - distant  YES  NO  
 Terrain of site:  Open pasture  Scrub bush  Wooded  Swamp nearby  Hilly
5. Stock inspected daily:  YES  NO (How often / by whom) .....
6. Stock running at large (on unenclosed land / highway):  YES  NO
7. Stock confined at night:  YES  NO (if no, where) small pasture / barnyard / other .....
8. Fencing: Individual Pasture Perimeter Fence  
 Acreage: ..... *1.8* .....  
 Maintenance (circle one): Good / Fair / Poor Good / Fair / Poor
9. Guard animal:  Dog - breed .....  Donkey  Llama
10. Noise / smell repellents, etc. deterrents used (specify): .....
11. Other preventive measures used (specify): .....
12. Waste disposal method  
 Collected  YES  NO  
 Buried  YES (how deep) ..... *4 ft* .....  NO  
 Composted  YES  NO  
 Other (specify) .....
13. Owner will implement the following to reduce further predation:  
 Improve fencing - repair / block entry points / addition of electric strands  
 Protect newborns - special penning / predator proof nursery / birthing area  
 Add guard animals or other deterrents  
 Light yards / night penning  
 Husbandry changes (specify) .....

I have found that the owner:  
 **had taken** reasonable measures to prevent predation  
 **had not taken** reasonable measures to prevent predation

**VALUATION - BOX 5**

REFER TO LIVESTOCK / POULTRY CATEGORIES AND CURRENT MARKET VALUES INFORMATION BELOW

- 1. Producer has livestock insurance YES NO
- 2. Insurance policy reviewed by valuer YES NO

I value the said livestock and / or poultry, having due regard to the maximum amounts of compensation as set out in the regulations passed under the *Livestock, Poultry and Honey Bee Protection Act* (or by a by-law of this municipality), and hereby award the following compensation:

Species*	Live weight (lb or kg)	Market Price (lb or kg)	Add'l value over market**	Compensation Awarded
<i>Charlous Cross</i>	<i>115 lb.</i>	<i>\$5.</i>		<i>\$575. -</i>
TOTAL COMPENSATION:				<i>\$ 575. -</i>

\* Indicate newborn (N) if less than one-month old.  
 \*\*For bred, purebred or high quality animals, animals must have physical identification, such as an ear tag or tattoo, that corresponds to written records. Copies of records, supporting the additional award, must be attached to this report.

**VALUER AFFIDAVIT - BOX 6**

To the best of my belief and knowledge, the findings in this report are complete and accurate

*G. Flewelling*  
 Signature of valuer  
 519-323-9953  
 Telephone number  
*evening*  
 Best time to telephone  
*June 21/10*  
 Date

**LIVESTOCK/POULTRY CATEGORIES AND CURRENT MARKET VALUES**

Please use exact wording under "TERM TO USE" when completing Report of Livestock Valuer form

1. **Categories**

SPECIES	TERM TO USE	DEFINITIONS
Cattle	<b>Calf</b>	0-6 months
	<b>Steer / Heifer</b>	6-24 months
	<b>Cow</b>	>24 months - includes heifers > 24 months
	<b>Bull</b>	>24 months - includes steers > 24 months
Goats	<b>Goat</b>	all ages and sexes
Horses	<b>Foal</b>	< 6 months
	<b>Horse</b>	all ages > 6 months
Poultry	<b>Chicken</b>	all types, report total weight
	<b>Duck</b>	all types, report total weight
	<b>Goose</b>	all types, report total weight
	<b>Turkey</b>	all types, report total weight

Note: Ratites (emu, ostrich, rhea), swans are not covered under the Act. Claims must be 25 kg or 55 lb. minimum, not to exceed \$1000 per year per owner.

SPECIES	TERM TO USE	DEFINITIONS
Rabbits	Rabbit	all ages and sexes
Note: Minimum \$20, not to exceed \$1000 per year per owner		
Sheep	<b>Lamb</b>	0-6 months
	<b>Yearling</b>	6-18 months
	<b>Ewe</b>	> 18 months
Swine	<b>Ram</b>	> 18 months
	<b>Swine</b>	Includes all ages and sexes

2. **Current Market Values - Information Sources**  
 Ontario Farmer magazine - Market News Page  
 Ontario Livestock Exchange  
 Market Information Line  
 Ontario Cattlemen's Association 519-824-9161  
 Ontario Sheep Marketing Agency 519-836-0043

3. **Guard Animals**  
 Guard dogs are generally not herding or hunting dogs nor house pets. Guard dogs remain with the livestock and are bonded to the animals. Generally they are specific breeds that have been bred for this purpose. For example: Grand Pyrenees, Komondor. Include breed when reporting a guard dog. Please do not record pets, herd or hunting dogs unless they truly are used in a guarding capacity.

# REPORT OF LIVESTOCK VALUER

Report to be completed in full, giving particulars of evidence observed.  
 Please print legibly. OMAFRA will not reimburse for incomplete reports.

"livestock" means cattle, fur-bearing animals, goats, horses, rabbits, sheep or swine.

"poultry" includes game birds where the game birds are kept pursuant to a licence under the Fish and Wildlife Conservation Act, 1997.

I, GLENN O'ROURKE Valuer of  
 livestock and poultry do hereby report that on or about the 4TH day of SEPTEMBER, 2010,  
 the following damages to livestock occurred as set out below.

OWNER INFORMATION	
Name of Owner of Livestock/Poultry <u>JAMES WILSON</u>	
Mailing Address <u>R.R.#4 KENILWORTA ON.</u>	Postal Code <u>N0G 2E0</u>
Location (include Lot, Concession, Municipality) <u>LOT 7, CON. 6, FORMER WEST LUTHER TWP</u>	911 gate #
Telephone # <u>(519) 848-6158</u>	Farm Business Registration # <u>2320943</u>

FINDINGS - INJURY / KILL - BOX 1	
Time: <u>12:00 PM, SEP 4/10</u> a.m. / p.m.	Comments: <u>8:00 AM SEP 5/10</u>
Description of livestock / poultry damaged - check appropriate findings.	
<input checked="" type="checkbox"/> Throat / neck injuries or wounds	<input type="checkbox"/> Head / neck / jaw / spine broken or damaged
<input type="checkbox"/> Legs under animal or animal in upright position	<input type="checkbox"/> Lying in unnatural position or posture
<input type="checkbox"/> Puncture wounds with bruising	<input type="checkbox"/> Carcass dragged away from kill area
<input checked="" type="checkbox"/> Signs of struggle	<input type="checkbox"/> Bites on hind legs
<input type="checkbox"/> Evidence animal was sick / starving / diseased	<input type="checkbox"/> Blood trails in area
<input type="checkbox"/> Poisonous plants / limited pasture	<input type="checkbox"/> Evidence of birth within past 72 hours
<input checked="" type="checkbox"/> Other (explain) <u>OWNER MOVED CARCASS FROM KILL AREA TO BARN AREA</u>	
Comments:	
<input checked="" type="checkbox"/> I have found evidence, to the best of my knowledge and belief, that shows the livestock/poultry in question has been killed or injured by a predator. [Proceed to complete remaining boxes.]	
OR	
<input type="checkbox"/> There was insufficient evidence to make a finding due to deterioration or lack of carcass remains	
<input type="checkbox"/> Died of natural cause, sickness or disease	
<input type="checkbox"/> Scavenged only - did not die from predation	
[Proceed to Box 6]	

IDENTIFICATION OF PREDATOR - BOX 2	
<input type="checkbox"/> Hindquarters / sides bitten or chewed	<input checked="" type="checkbox"/> Internal organs / ribs / fatty tissue eaten
<input type="checkbox"/> Wool scattered, carcass ripped apart	<input type="checkbox"/> Multiple carcasses
<input type="checkbox"/> Very little of carcass eaten	<input type="checkbox"/> Claw marks on flanks, shoulders
<input type="checkbox"/> Tracks present - type: .....	<input checked="" type="checkbox"/> Hide mostly in one piece - not ripped into pieces
<input type="checkbox"/> Predator stools - type, size, colour, content (specify):	<input type="checkbox"/> Other findings (specify)
<u>NO FOOT PRINTS OR STOOL PRESENT IN KILL AREA.</u>	
I have found evidence, to the best of my knowledge and belief, that shows the:	
<input checked="" type="checkbox"/> predator responsible for the damage was a (circle one): <u>Coyote</u> Wolf      Dog	
<input type="checkbox"/> damage was caused by dog owned or habitually kept on premises of owner of livestock and/or poultry.	

PHOTOGRAPHS - BOX 3
Attach photographs (3 - 6) of injured or killed livestock or poultry to indicate attack site, wounds and other pertinent evidence.



**REASONABLE CARE - BOX 4**

**RISK ASSESSMENT - Check applicable Item**

1. Current regional predation risk is:  High  Moderate  Low
  2. Regional incidence of predation is:  Increasing  Stable  Decreasing
- Comments: .....
3. Predation on this farm is:  1st incident  1 claim / year  2 claims / year  >2 claims / year
  4. Previous predation history. Dates: .....
- Describe actions **taken** by producer to decrease likelihood of predation since last claim
- |                                                     |                                                    |
|-----------------------------------------------------|----------------------------------------------------|
| <input type="checkbox"/> Improved fencing           | <input type="checkbox"/> Obtained guard animal     |
| <input type="checkbox"/> Penning livestock at night | <input type="checkbox"/> Lighting yards            |
| <input type="checkbox"/> Birthing in protected area | <input type="checkbox"/> Smell or noise deterrents |
| <input type="checkbox"/> Other: .....               |                                                    |
5. Trapping / hunting
- Are predators being hunted / trapped on farm  Yes (Date last caught) .....  No
- Are there preventive hunting / trapping (e.g. spring) activities on farm  Yes  No

**FARM MANAGEMENT - Check applicable item**

1. Herd / Flock size: 42 .....
2. Run as one herd / flock:  YES  NO
3. Livestock are:  Healthy  Diseased  Sick
4. Location of kill / injury:
 

Barnyard	<input type="checkbox"/> YES	<input type="checkbox"/> NO
Pasture - near buildings	<input type="checkbox"/> YES	<input type="checkbox"/> NO
Pasture - distant	<input checked="" type="checkbox"/> YES	<input type="checkbox"/> NO

Terrain of site:  Open pasture  Scrub bush  Wooded  Swamp nearby  Hilly
5. Stock inspected daily:  YES  NO (How often / by whom) .....
6. Stock running at large (on unenclosed land / highway):  YES  NO
7. Stock confined at night:  YES  NO (If no, where) small pasture / barnyard / other .....
8. Fencing:
 

	<u>Individual Pasture</u>	<u>Perimeter Fence</u>
Acreage:	<u>55 ACRES</u>	.....
Maintenance (circle one):	<u>Good</u> / Fair / Poor	<u>Good</u> / Fair / Poor
9. Guard animal:  Dog - breed .....  Donkey  Llama
10. Noise / smell repellents, etc. deterrents used (specify): .....
11. Other preventive measures used (specify): .....
12. Waste disposal method
 

Collected	<input type="checkbox"/> YES	<input type="checkbox"/> NO
Buried	<input checked="" type="checkbox"/> YES (how deep) <u>3'</u>	<input type="checkbox"/> NO
Composted	<input type="checkbox"/> YES	<input type="checkbox"/> NO

Other (specify) .....

Afterbirth disposed  YES  NO
13. Owner will implement the following to reduce further predation:
 

<input type="checkbox"/>	Improve fencing - repair / block entry points / addition of electric strands
<input type="checkbox"/>	Protect newborns - special penning / predator proof nursery / birthing area
<input type="checkbox"/>	Add guard animals or other deterrents
<input type="checkbox"/>	Light yards / night penning
<input type="checkbox"/>	Husbandry changes (specify) .....
<input type="checkbox"/>	Predator removal (specify what, when, how often) .....
<input checked="" type="checkbox"/>	Other (specify) <u>MOVE HERD TO PASTURE CLOSER TO BARN</u>

I have found that the owner:

- had taken** reasonable measures to prevent predation
- had not taken** reasonable measures to prevent predation

**VALUATION - BOX 5**

REFER TO LIVESTOCK / POULTRY CATEGORIES AND CURRENT MARKET VALUES INFORMATION BELOW

1. Producer has livestock insurance YES
2. Insurance policy reviewed by valuer YES

NO  
NO

I value the said livestock and / or poultry, having due regard to the maximum amounts of compensation as set out in the regulations passed under the *Livestock, Poultry and Honey Bee Protection Act* (or by a by-law of this municipality), and hereby award the following compensation:

Species*	Live weight (lb or kg)	Market Price (lb or kg)	Add'l value over market**	Compensation Awarded
CALF	300 lb			\$544.00
(AWARD DETERMINED FROM O.M.F.R.A. FORMULA)				
TOTAL COMPENSATION:				\$ 544.00

\* Indicate newborn (N) if less than one-month old.

\*\*For bred, purebred or high quality animals, animals must have physical identification, such as an ear tag or tattoo, that corresponds to written records. Copies of records, supporting the additional award, must be attached to this report.

**VALUER AFFIDAVIT - BOX 6**

To the best of my belief and knowledge, the findings in this report are complete and accurate

*[Signature]*  
Signature of valuer

519-323-2620  
Telephone number

EVENINGS  
Best time to telephone

SEPTEMBER 7, 2010  
Date

**LIVESTOCK/POULTRY CATEGORIES AND CURRENT MARKET VALUES**

Please use exact wording under "TERM TO USE" when completing Report of Livestock Valuer form

1. Categories			SPECIES	TERM TO USE	DEFINITIONS
SPECIES	TERM TO USE	DEFINITIONS	Rabbits	Rabbit	all ages and sexes Note: Minimum \$20, not to exceed \$1000 per year per owner
Cattle	Calf	0-6 months	Sheep	Lamb	0-6 months
	Steer / Heifer	6-24 months		Yearling	6-18 months
	Cow	>24 months - includes heifers > 24 months		Ewe	> 18 months
	Bull	>24 months - includes steers > 24 months	Ram	> 18 months	
Goats	Goat	all ages and sexes	Swine	Swine	Includes all ages and sexes
Horses	Foal	< 6 months	2. <u>Current Market Values - Information Sources</u>		
	Horse	all ages > 6 months	Ontario Farmer magazine - Market News Page		
Poultry	Chicken	all types, report total weight	Ontario Livestock Exchange		
	Duck	all types, report total weight	Market Information Line		
	Goose	all types, report total weight	Ontario Cattlemen's Association 519-824-9161		
	Turkey	all types, report total weight	Ontario Sheep Marketing Agency 519-836-0043		
Note: Ratites (emu, ostrich, rhea), swans are not covered under the Act. Claims must be 25 kg or 55 lb. minimum, not to exceed \$1000 per year per owner.			3. <u>Guard Animals</u>		
Guard dogs are generally not herding or hunting dogs nor house pets. Guard dogs remain with the livestock and are bonded to the animals. Generally they are specific breeds that have been bred for this purpose. For example: Grand Pyrenees, Komondor. Include breed when reporting a guard dog. Please do not record pets, herd or hunting dogs unless they truly are used in a guarding capacity.					

Jim WILSON, of Damascus, called me at 10:00 A.M., Sun, Sep 5/10 and advised me that he had a calf killed by a predator. I was not able to attend until Tue., Sep 7/10.

At 8:45 A.M., Tue, Sep 7/10, I arrived at WILSON farm. I had advised Mr. WILSON to bring the carcass up to the barn area. I viewed the carcass. There were puncture wounds to the throat. The abdomen & some ribs were eaten. The rest of the carcass was present. I went back to kill area in a pasture field at the back of the farm. The kill area was grass covered. No foot prints or stool of predator was present.

The kill area was trampled down by the cows in the herd. The herd consisted of cows & calves.

Mr. WILSON hears wolves and coyotes in brush to the south and north of the farm. He has also seen wolves in his fields.

This is a classic coyote kill.

Mr. WILSON checked his herd daily but did not check on Saturday because it was raining.

Weather today - Sunny & Warm - 19°C

Total km - 50.5 km

Total Time for me - 3 hours.

<b>Sheep</b>	52.00 - 100.00 sales to 131.00	
<b>Goats</b>	Kidds - \$ 60.00 - \$ 120.00 to \$ 130.00 per head Nannies - \$ 50.00 - \$ 120.00 to \$ 136.00 per head Billies - \$150.00 - \$ 250.00 to \$ 300.00 per head	
<b>Top</b>	under 400 lbs	122.00 - 162.00
<b>Quality</b>	<u>400 - 500</u>	<u>123.00 - 149.00</u>
<b>Stocker</b>	500 - 600	113.00 - 139.00
<b>Steers</b>	600 - 700	106.00 - 135.00
	700 - 800	98.50 - 115.75
	800 - 900	99.25 - 109.00
	900 - 1000	104.00 - 107.25
	over 1000 lbs	94.50 - 102.75
<b>Top</b>	under 300 lbs	122.00 - 143.00
<b>Quality</b>	300 - 400	126.00 - 141.00
<b>Stocker</b>	400 - 500	117.00 - 147.00
<b>Heifers</b>	500 - 600	93.00 - 124.00
	600 - 700	104.00 - 117.00
	700 - 800	93.00 - 110.00
	800 - 900	96.00 - 107.00
	Over 900 lbs	90.00 - 103.50

---

# REPORT OF LIVESTOCK VALUER

RECEIVED  
 Livestock, Poultry and Honey Bee Production Act  
 R.S.O. 1990, c. L24, s. 4 (2)

AUG 27 2010

Report to be completed in full, giving particulars of evidence observed.  
 Please print legibly. OMAFRA will not reimburse for incomplete reports.

TWP. OF WELLINGTON NORTH

33 km

"livestock" means cattle, fur-bearing animals, goats, horses, rabbits, sheep or swine.  
 "poultry" includes game birds where the game birds are kept pursuant to a licence under the Fish and Wildlife Conservation Act, 1997.

I, G. Flewelling Valuer of  
 livestock and poultry do hereby report that on or about the 23rd day of Aug 2010,  
 the following damages to livestock occurred as set out below.

### OWNER INFORMATION

Name of Owner of Livestock/Poultry <u>Peter Murray</u>	
Mailing Address <u>R.R. #2 Xenilworth</u>	Postal Code <u>N0G 2E0</u>
Location (include Lot, Concession, Municipality) <u>Lot 24 Con 6 Shellington No.</u>	911 gate # <u>9018</u>
Telephone # <u>(519) 848-2293</u>	Farm Business Registration # <u>2441456</u>

### FINDINGS - INJURY / KILL - BOX 1

Time: 2:06 a.m. / p.m. Comments: Peter baling straw

Description of livestock / poultry damaged - check appropriate findings.

<input checked="" type="checkbox"/> Throat / neck injuries or wounds	<input checked="" type="checkbox"/> Head / neck / jaw / spine broken or damaged
<input type="checkbox"/> Legs under animal or animal in upright position	<input type="checkbox"/> Lying in unnatural position or posture
<input checked="" type="checkbox"/> Puncture wounds with bruising	<input type="checkbox"/> Carcass dragged away from kill area
<input type="checkbox"/> Signs of struggle	<input type="checkbox"/> Bites on hind legs
<input type="checkbox"/> Evidence animal was sick / starving / diseased	<input type="checkbox"/> Blood trails in area
<input type="checkbox"/> Poisonous plants / limited pasture	<input type="checkbox"/> Evidence of birth within past 72 hours
<input type="checkbox"/> Other (explain) .....	<input type="checkbox"/> Other (explain) .....

Comments:

I have found evidence, to the best of my knowledge and belief, that shows the livestock/poultry in question has been killed or injured by a predator. [Proceed to complete remaining boxes.]

OR

There was insufficient evidence to make a finding due to deterioration or lack of carcass remains

Died of natural cause, sickness or disease

Scavenged only - did not die from predation

[Proceed to Box 6]

### IDENTIFICATION OF PREDATOR - BOX 2

<input type="checkbox"/> Hindquarters / sides bitten or chewed	<input type="checkbox"/> Internal organs / ribs / fatty tissue eaten
<input type="checkbox"/> Wool scattered, carcass ripped apart	<input type="checkbox"/> Multiple carcasses
<input type="checkbox"/> Very little of carcass eaten	<input type="checkbox"/> Claw marks on flanks, shoulders
<input type="checkbox"/> Tracks present - type: .....	<input checked="" type="checkbox"/> Hide mostly in one piece - not ripped into pieces
<input type="checkbox"/> Predator stools - type, size, colour, content (specify): .....	<input type="checkbox"/> Other findings (specify) .....

I have found evidence, to the best of my knowledge and belief, that shows the:

predator responsible for the damage was a (circle one): Coyote Wolf Dog

damage was caused by dog owned or habitually kept on premises of owner of livestock and/or poultry.

### PHOTOGRAPHS - BOX 3

Attach photographs (3 - 6) of injured or killed livestock or poultry to indicate attack site, wounds and other pertinent evidence.

**REASONABLE CARE - BOX 4**

**RISK ASSESSMENT - Check applicable item**

1. Current regional predation risk is:  High  Moderate  Low
2. Regional incidence of predation is:  Increasing  Stable  Decreasing

Comments: .....

3. Predation on this farm is:  1st incident  1 claim / year  2 claims / year  >2 claims / year
4. Previous predation history. Dates: *July 24, July 16, June 14, Apr. 17/10*

Describe actions taken by producer to decrease likelihood of predation since last claim

- Improved fencing  Obtained guard animal
- Penning livestock at night *& daytime when away*  Lighting yards
- Birthing in protected area  Smell or noise deterrents
- Other: .....

5. Trapping / hunting
- Are predators being hunted / trapped on farm  Yes (Date last caught) *shot 2 recently*  No
- Are there preventive hunting / trapping (e.g. spring) activities on farm  Yes  No

**FARM MANAGEMENT - Check applicable item**

1. Herd / Flock size: *40*
2. Run as one herd / flock:  YES  NO
3. Livestock are:  Healthy  Diseased  Sick
4. Location of kill / injury:
- Barnyard  YES  NO
- Pasture - near buildings  YES  NO
- Pasture - distant  YES  NO
- Terrain of site:  Open pasture  Scrub bush  Wooded  Swamp nearby  Hilly
5. Stock inspected daily:  YES  NO (How often / by whom) .....
6. Stock running at large (on unenclosed land / highway):  YES  NO
7. Stock confined at night:  YES  NO (If no, where) small pasture / barnyard / other .....
8. Fencing: Individual Pasture Perimeter Fence
- Acreage: .....
- Maintenance (circle one): Good / Fair / Poor Good / Fair / Poor
9. Guard animal:  Dog - breed .....  Donkey  Llama
10. Noise / smell repellents, etc. deterrents used (specify): .....
11. Other preventive measures used (specify): .....
12. Waste disposal method
- Collected  YES  NO
- Buried  YES (how deep) *4 ft.*  NO
- Composted  YES  NO
- Other (specify) .....
- Afterbirth disposed  YES  NO
13. Owner will implement the following to reduce further predation:
- Improve fencing - repair / block entry points / addition of electric strands
- Protect newborns - special penning / predator proof nursery / birthing area
- Add guard animals or other deterrents
- Light yards / night penning
- Husbandry changes (specify) .....
- Predator removal (specify what, when, how often) *shoot*
- Other (specify) .....

I have found that the owner:

- had taken reasonable measures to prevent predation
- had not taken reasonable measures to prevent predation

**VALUATION - BOX 5**

REFER TO LIVESTOCK / POULTRY CATEGORIES AND CURRENT MARKET VALUES INFORMATION BELOW

1. Producer has livestock insurance YES  NO  
 2. Insurance policy reviewed by valuer YES NO

I value the said livestock and / or poultry, having due regard to the maximum amounts of compensation as set out in the regulations passed under the Livestock, Poultry and Honey Bee Protection Act (or by a by-law of this municipality), and hereby award the following compensation:

Species*	Live weight (lb or kg)	Market Price (lb or kg)	Add'l value over market**	Compensation Awarded
dorset cross	170 lb	ownerselling	young ewe for	\$ 225. —
TOTAL COMPENSATION:				\$ 225. —

\* Indicate newborn (N) if less than one-month old.

\*\*For bred, purebred or high quality animals, animals must have physical identification, such as an ear tag or tattoo, that corresponds to written records. Copies of records, supporting the additional award, must be attached to this report.

**VALUER AFFIDAVIT - BOX 6**

To the best of my belief and knowledge, the findings in this report are complete and accurate

*G. Howelling*  
 Signature of valuer

519-323-9953  
 Telephone number

evening  
 Best time to telephone

Aug 23/10  
 Date

**LIVESTOCK/POULTRY CATEGORIES AND CURRENT MARKET VALUES**

Please use exact wording under "TERM TO USE" when completing Report of Livestock Valuer form

1. Categories			SPECIES	TERM TO USE	DEFINITIONS
SPECIES	TERM TO USE	DEFINITIONS	Rabbits	Rabbit	all ages and sexes Note: Minimum \$20, not to exceed \$1000 per year per owner
Cattle	Calf	0-6 months	Sheep	Lamb	0-6 months
	Steer / Heifer	6-24 months		Yearling	6-18 months
	Cow	>24 months - includes heifers > 24 months		Ewe	> 18 months
Cattle	Bull	>24 months - includes steers > 24 months	Swine	Ram	> 18 months
				Swine	Includes all ages and sexes
Goats	Goat	all ages and sexes	2. <b>Current Market Values - Information Sources</b>		
Horses	Foal	< 6 months	Ontario Farmer magazine - Market News Page		
	Horse	all ages > 6 months	Ontario Livestock Exchange Market Information Line		
Poultry	Chicken	all types, report total weight	Ontario Cattlemen's Association 519-824-9161		
	Duck	all types, report total weight	Ontario Sheep Marketing Agency 519-836-0043		
	Goose	all types, report total weight	3. <b>Guard Animals</b>		
	Turkey	all types, report total weight	Guard dogs are generally not herding or hunting dogs nor house pets. Guard dogs remain with the livestock and are bonded to the animals. Generally they are specific breeds that have been bred for this purpose. For example: Grand Pyrenees, Komondor. Include breed when reporting a guard dog. Please do not record pets, herd or hunting dogs unless they truly are used in a guarding capacity.		

Note: Ratites (emu, ostrich, rhea), swans are not covered under the Act. Claims must be 25 kg or 55 lb. minimum, not to exceed \$1000 per year per owner.



# REPORT OF LIVESTOCK VALUER

Report to be completed in full, giving particulars of evidence observed.  
 Please print legibly. OMAFRA will not reimburse for incomplete reports.

33 km

"livestock" means cattle, fur-bearing animals, goats, horses, rabbits, sheep or swine.

"poultry" includes game birds where the game birds are kept pursuant to a licence under the Fish and Wildlife Conservation Act, 1997.

I, G. Flewelling, Valuer of livestock and poultry do hereby report that on or about the 9<sup>th</sup> day of Sept. 2010, the following damages to livestock occurred as set out below.

### OWNER INFORMATION

Name of Owner of Livestock/Poultry <u>Peter Murray</u>	
Mailing Address <u>R-R #2 Kenilworth</u>	Postal Code <u>N0G 2E0</u>
Location (include Lot, Concession, Municipality) <u>Lot 24 Con 6 Stellington N.</u>	911 gate # <u>9018</u>
Telephone # <u>(519) 848-2295</u>	Farm Business Registration # <u>2441456</u>

### FINDINGS - INJURY / KILL - BOX 1

Time: 3-4 a.m. Comments: Coyotes came into barnyard & frightened & chased sheep into field.

Description of livestock / poultry damaged - check appropriate findings.

- |                                                                          |                                                                                 |
|--------------------------------------------------------------------------|---------------------------------------------------------------------------------|
| <input checked="" type="checkbox"/> Throat / neck injuries or wounds     | <input checked="" type="checkbox"/> Head / neck / jaw / spine broken or damaged |
| <input type="checkbox"/> Legs under animal or animal in upright position | <input type="checkbox"/> Lying in unnatural position or posture                 |
| <input checked="" type="checkbox"/> Puncture wounds with bruising        | <input type="checkbox"/> Carcass dragged away from kill area                    |
| <input checked="" type="checkbox"/> Signs of struggle                    | <input checked="" type="checkbox"/> Bites on hind legs                          |
| <input type="checkbox"/> Evidence animal was sick / starving / diseased  | <input type="checkbox"/> Blood trails in area                                   |
| <input type="checkbox"/> Poisonous plants / limited pasture              | <input type="checkbox"/> Evidence of birth within past 72 hours                 |
| <input type="checkbox"/> Other (explain) .....                           | <input type="checkbox"/> Other (explain) .....                                  |

Comments:

Coyotes attacked ram which was protecting ewes & lambs.

- I have found evidence, to the best of my knowledge and belief, that shows the livestock/poultry in question has been killed or injured by a predator. [Proceed to complete remaining boxes.]

OR

- There was insufficient evidence to make a finding due to deterioration or lack of carcass remains
- Died of natural cause, sickness or disease
- Scavenged only - did not die from predation

[Proceed to Box 6]

### IDENTIFICATION OF PREDATOR - BOX 2

- |                                                                                         |                                                                                 |
|-----------------------------------------------------------------------------------------|---------------------------------------------------------------------------------|
| <input checked="" type="checkbox"/> Hindquarters / sides bitten or chewed               | <input checked="" type="checkbox"/> Internal organs / ribs / fatty tissue eaten |
| <input checked="" type="checkbox"/> Wool scattered, carcass ripped apart                | <input type="checkbox"/> Multiple carcasses                                     |
| <input type="checkbox"/> Very little of carcass eaten                                   | <input checked="" type="checkbox"/> Claw marks on flanks, shoulders             |
| <input type="checkbox"/> Tracks present - type: .....                                   | <input type="checkbox"/> Hide mostly in one piece - not ripped into pieces      |
| <input type="checkbox"/> Predator stools - type, size, colour, content (specify): ..... | <input type="checkbox"/> Other findings (specify): .....                        |

I have found evidence, to the best of my knowledge and belief, that shows the:

- predator responsible for the damage was a (circle one): Coyote Wolf Dog
- damage was caused by dog owned or habitually kept on premises of owner of livestock and/or poultry.

### PHOTOGRAPHS - BOX 3

Attach photographs (3 - 6) of injured or killed livestock or poultry to indicate attack site, wounds and other pertinent evidence.

RISK ASSESSMENT - Check applicable item

1. Current regional predation risk is:  High  Moderate  Low
2. Regional incidence of predation is:  Increasing  Stable  Decreasing
- Comments: .....
3. Predation on this farm is:  1st incident  1 claim / year  2 claims / year  >2 claims / year
4. Previous predation history. Dates: *Apr. . . 2 in July . . 2 in Aug.*
- Describe actions taken by producer to decrease likelihood of predation since last claim
  - Improved fencing  Obtained guard animal
  - Penning livestock at night  Lighting yards
  - Birthing in protected area  Smell or noise deterrents
  - Other: *has horses in with sheep*
5. Trapping / hunting
  - Are predators being hunted / trapped on farm  Yes (Date last caught) *shot one Aug 25/10*  No
  - Are there preventive hunting / trapping (e.g. spring) activities on farm  Yes  No

FARM MANAGEMENT - Check applicable item

1. Herd / Flock size: *70 head*
2. Run as one herd / flock:  YES  NO
3. Livestock are:  Healthy  Diseased  Sick
4. Location of kill / injury:
  - Barnyard  YES  NO
  - Pasture - near buildings  YES  NO *chased sheep out of barnyard*
  - Pasture - distant  YES  NO
  - Terrain of site:  Open pasture  Scrub bush  Wooded  Swamp nearby  Hilly
5. Stock inspected daily:  YES  NO (How often / by whom) .....
6. Stock running at large (on unenclosed land / highway):  YES  NO
7. Stock confined at night:  YES  NO (If no, where) small pasture / barnyard / other .....
8. Fencing: Individual Pasture Perimeter Fence  
 Acreage: *9 acres*  
 Maintenance (circle one): Good / Fair / Poor *(Good) / Fair / Poor*
9. Guard animal:  Dog - breed .....
10. Noise / smell repellents, etc. deterrents used (specify): .....
11. Other preventive measures used (specify): .....
12. Waste disposal method
  - Collected  YES  NO
  - Buried  YES (how deep) *4 ft*  NO
  - Composted  YES  NO
  - Other (specify) .....
  - Afterbirth disposed  YES  NO
13. Owner will implement the following to reduce further predation:
  - Improve fencing - repair / block entry points / addition of electric strands
  - Protect newborns - special penning / predator proof nursery / birthing area
  - Add guard animals or other deterrents
  - Light yards / night penning
  - Husbandry changes (specify) .....
  - Predator removal (specify what, when, how often) *hunting*
  - Other (specify) .....

I have found that the owner:

- had taken reasonable measures to prevent predation
- had not taken reasonable measures to prevent predation

**VALUATION - BOX 5**

REFER TO LIVESTOCK / POULTRY CATEGORIES AND CURRENT MARKET VALUES INFORMATION BELOW

1. Producer has livestock insurance YES NO  
 2. Insurance policy reviewed by valuer YES NO

I value the said livestock and / or poultry, having due regard to the maximum amounts of compensation as set out in the regulations passed under the *Livestock, Poultry and Honey Bee Protection Act* (or by a by-law of this municipality), and hereby award the following compensation:

Species*	Live weight (lb or kg)	Market Price (lb or kg)	Add'l value over market**	Compensation Awarded
<i>Hampshire (Purebred ram)</i>	<i>350 lb</i>			<i>\$ 350.00</i>
TOTAL COMPENSATION:				<i>\$ 350.00</i>

\* Indicate newborn (N) if less than one-month old.

\*\*For bred, purebred or high quality animals, animals must have physical identification, such as an ear tag or tattoo, that corresponds to written records. Copies of records, supporting the additional award, must be attached to this report.

**VALUER AFFIDAVIT - BOX 6**

To the best of my belief and knowledge, the findings in this report are complete and accurate

*S. Flewelling*  
 Signature of valuer

*519-323-9953*  
 Telephone number

*Evening*  
 Best time to telephone

*Sept. 19/10*  
 Date

**LIVESTOCK/POULTRY CATEGORIES AND CURRENT MARKET VALUES**

Please use exact wording under "TERM TO USE" when completing Report of Livestock Valuer form

1. Categories			SPECIES	TERM TO USE	DEFINITIONS
<u>SPECIES</u>	<u>TERM TO USE</u>	<u>DEFINITIONS</u>	Rabbits	Rabbit	all ages and sexes
Cattle	<b>Calf</b>	0-6 months	<i>Note: Minimum \$20, not to exceed \$1000 per year per owner</i>		
	<b>Steer / Heifer</b>	6-24 months	Sheep	<b>Lamb</b>	0-6 months
	<b>Cow</b>	>24 months - includes heifers > 24 months		<b>Yearling</b>	6-18 months
	<b>Bull</b>	>24 months - includes steers > 24 months	Swine	<b>Ewe</b>	> 18 months
Goats	<b>Goat</b>	all ages and sexes		<b>Ram</b>	> 18 months
Horses	<b>Foal</b>	< 6 months	2. <b>Current Market Values - Information Sources</b>		
	<b>Horse</b>	all ages > 6 months	Ontario Farmer magazine - Market News Page		
Poultry	<b>Chicken</b>	all types, report total weight	Ontario Livestock Exchange		
	<b>Duck</b>	all types, report total weight	Market Information Line		
	<b>Goose</b>	all types, report total weight	Ontario Cattlemen's Association 519-824-9161		
	<b>Turkey</b>	all types, report total weight	Ontario Sheep Marketing Agency 519-836-0043		
<i>Note: Ratites (emu, ostrich, rhea), swans are not covered under the Act. Claims must be 25 kg or 55 lb. minimum, not to exceed \$1000 per year per owner.</i>			3. <b>Guard Animals</b>		
			Guard dogs are generally not herding or hunting dogs nor house pets. Guard dogs remain with the livestock and are bonded to the animals. Generally they are specific breeds that have been bred for this purpose. For example: Grand Pyrenees, Komondor. Include breed when reporting a guard dog. Please do not record pets, herd or hunting dogs unless they truly are used in a guarding capacity.		

**THE CORPORATION OF THE  
TOWNSHIP OF WELLINGTON NORTH**

**BY-LAW NUMBER 72-10**

**BEING A BY-LAW TO CONFIRM THE PROCEEDINGS OF THE  
COUNCIL OF THE CORPORATION OF THE TOWNSHIP OF  
WELLINGTON NORTH AT ITS REGULAR MEETING HELD ON  
SEPTEMBER 13, 2010.**

**AUTHORITY: Municipal Act, 2001, S.O. 2001, c.25, as amended, Sections 5(3) and 130.**

**WHEREAS** the Municipal Act, 2001, S.O. 2001, c.25, as amended, Section 5(3), provides that the jurisdiction of every council is confined to the municipality that it represents and its powers shall be exercised by by-law.

**AND WHEREAS** the Municipal Act, 2001, S.O. 2001, c.25, as amended, Section 130 provides that every council may pass such by-laws and make such regulations for the health, safety and well-being of the inhabitants of the municipality in matters not specifically provided for by this Act and for governing the conduct of its members as may be deemed expedient and are not contrary to law.

**NOW THEREFORE** the Council of The Corporation of the Township of Wellington North hereby **ENACTS AS FOLLOWS:**

1. That the action of the Council at its Regular Meeting held on September 13, 2010 in respect to each report, motion, resolution or other action passed and taken by the Council at its meeting, is hereby adopted, ratified and confirmed, as if each resolution or other action was adopted, ratified and confirmed by separate by-law.
2. That the Mayor and the proper officers of the Township are hereby authorized and directed to do all things necessary to give effect to the said action, or to obtain approvals where required, and, except where otherwise provided, the Mayor and the Clerk are hereby directed to execute all documents necessary in that behalf and to affix the corporate seal of the Township to all such documents.
3. That this by-law, to the extent to which it provides authority for or constitutes the exercise by the Council of its power to proceed with, or to provide any money for, any undertaking work, project, scheme, act, matter or thing referred to in subsection 65 (1) of the Ontario Municipal Board Act, R.S.O. 1990, Chapter 0.28, shall not take effect until the approval of the Ontario Municipal Board with respect thereto, required under such subsection, has been obtained.
4. That any acquisition or purchase of land or of an interest in land pursuant to this by-law or pursuant to an option or agreement authorized by this by-law, is conditional on compliance with Environmental Assessment Act, R.S.O. 1990, Chapter E.18.

**READ A FIRST, SECOND AND THIRD TIME AND FINALLY PASSED  
THIS 13TH DAY OF SEPTEMBER, 2010.**

---

**MICHAEL BROOMHEAD,  
MAYOR**

---

**LORRAINE HEINBUCH  
CHIEF ADMINISTRATIVE OFFICER/CLERK**

## **MEETINGS, NOTICES, ANNOUNCEMENTS**

Water/Sewer Committee	Tuesday, September 14, 2010	4:00 p.m.
Building/Property Committee	Wednesday, September 15, 2010	9:00 a.m.
Economic Development Committee	Wednesday, September 15, 2010	4:30 p.m.
Recreation and Culture Committee	Thursday, September 16, 2010	9:00 a.m.
Fire Committee	Tuesday, September 21, 2010	7:00 p.m.
Regular Council	Monday, September 27, 2010	7:00 p.m.

**The following accessibility services can be made available to residents upon request with two weeks notice:**

**Sign Language Services – Canadian Hearing Society – 1-800-668-5815**

**Documents in alternate forms – CNIB – 1-866-797-1312**